



**PARKS AND RECREATION COMMISSION MEETING**  
**Thursday, May 14, 2009, Albany Community Center**  
**Edith Stone Room, 1249 Marin Ave., 7:00pm**

**1. CALL TO ORDER**

**2. APPROVAL OF MINUTES: April 2009**

**3. PUBLIC COMMENT**

For persons desiring to address the Commission/Committee/Board on an item that is not on the agenda please note that each speaker is limited to three (3) minutes. The Brown Act limits the Committee's ability to take and/or discuss items that are not on the agenda; therefore, such items are normally referred to staff for comment or to a future agenda.

**4. ANNOUNCEMENTS/COMMUNICATIONS:**

**5. DIRECTOR'S REPORT:**

**6. DISCUSSIONS AND POSSIBLE ACTION ON MATTERS RELATED TO THE FOLLOWING ITEMS:**

- |            |  |  |
|------------|--|--|
| <b>6-1</b> | <b>Presentation Fern Tiger and Associates:</b> | Reminder from Fern Tiger Associates to encourage Commissioners/Committee Members to promote participation in the <i>Voices to Vision</i> neighborhood gatherings, mid-May through the end of June. |
| <b>6-2</b> | <b>Buchanan Bicycle Plan Presentation:</b>     | Staff will present a draft of the Buchanan Bicycle Plan.   |
| <b>6-3</b> | <b>Update on Ocean View Community Garden:</b>  | Request for the Community Garden Committee to update policies and information about the garden.  |
| <b>6-4</b> | <b>Accessibility of Albany Parks:</b>          | Review accessibility of Albany parks to determine if any changes/additions need to be made.  |
| <b>6-5</b> | <b>Pierce Street Park update:</b>              | Update on status of Pierce Street property currently owned by Caltrans.  |
| <b>6-6</b> | <b>Measure WW:</b>                             | The Commission will continue to discuss possible uses of Measure WW funds. An update on proposed projects is due to Council June 2009.   |
| <b>6-7</b> | <b>Tree Task Force Update:</b>                 | Update and recommendations from the City's Tree Task Force.  |
| <b>6-8</b> | <b>Green Albany Day:</b>                       | The Commission will discuss having a booth at the Green Albany Day, May 17, 11 a.m. – 3:00 p.m.  |
| <b>6-9</b> | <b>Next Meeting date/time:</b>                 | Note Commissioner conflicts re next months meeting.  |

**7. FUTURE AGENDA ITEMS**

(Commission/Committee/Board Member announcement of requests for future agenda items. No public comment will be taken on announcement of future agenda items).

8.

**ADJOURNMENT:**

*Please note that if you provide your name and address when speaking before the Commission/Committee/Board it will become part of the official public record, which will be posted on the Internet.*

NOTE: Any writings or documents provided to a majority of the City Council/Commission regarding any item on this agenda will be made available for public inspection at the Community Center counter located at 1249 Marin Ave during normal business hours, 8:30am-5:00pm, Monday through Friday.



## A Regular Meeting of the Parks And Recreation Commission Minutes

Tuesday, April 14, 2009

Albany Senior Center

846 Masonic Ave.

7:00 p.m.

1. **Call to Order:** 7:07p.m. Commissioners present: Vice Chair Mullarkey, Commissioners Class, Como and Kindle. Excused Chair Pilch (until 8:55pm) Commissioners Linden and Trout.

Staff present: Director Penelope Leach, Planning Manager Jeff Bond, City Engineer Randy Leptien and Robin Mariona.

2. **Approval of Minutes: March 12, 2009**

**Motion:**

Motion to approve minutes made by Commissioner Kindle and seconded by Commissioner Como

Motion carried 3 in favor and 1 abstention.

3. **Public Comment:** None

4. **Announcements/Communications:** Commissioner Kindle stated that he might have to leave early.

5. **Director's Report:** Director Leach stated that high school student Hailey Frail would be doing a community-weeding project. She further stated that Council had approved the purchase of the property at 842 Masonic Avenue next to the Senior Center, and escrow was due to close on April 20<sup>th</sup>. Plans for the building before demolition were storage, police SWAT training and possible use by BART as office for the retrofit project.

Director Leach stated that community groups were encouraged to participate in the City 4<sup>th</sup> of July event, as long as they provided an activity that supported the theme.

6. **Discussion and possible action on matters related to the following items, which could include reports and/or proposed resolutions if any:**

**6-1. General Plan Update: Staff will update the Commission on the City's efforts to update the General Plan.** Planning Manager Jeff Bond stated that the old plan dates from 1992-2010 were about to expire and formulating the new plan would be a 2-year process. He stated that the General Plan was an important legal document as a foundation for consistency in all of the City's planning, building and engineering projects. Fern Tiger would form the foundation for the General Plan during the waterfront planning process, and the Park and Recreation Master Plan would be a component.

**6-2. Lighting and Landscaping District (LLD): Annually the Commission recommends expenditures/projects for the City's LLD.** City Engineer Randy Leptien stated that the assessment revenues were generally used for street lighting, street maintenance, parks, acquisition of open space, creation of playfields, vegetation management, creek restoration, street trees, urban forest and tennis court resurfacing.

He stated that monies from the funds had acquired Albany Hill property; funded play field projects, Cordonices Creek restoration and vegetation management.

Commissioner Class questioned the financial schedules from 2007-2008. Mr. Leptien stated that he would need to check some of the figures and verify what they were used for.

Director Leach recommended vegetation management on Albany Hill for fire prevention and invasive control for a total of \$30,000. She further recommended creating a \$10,000 annual allotment for ongoing management on Albany Hill and strategizing with ShelterBelt.

**Public Comment:** Doug Donaldson stated support for staff's recommendation for vegetation management on Albany Hill and urged the Commission to adopt it. Albany resident Robert Uhrhammer was in favor of vegetation management and an ongoing program. He stated that street lighting was not full cutoff and installation of full cut off lighting would be much more efficient and asked what had happened to the owl burrows.

Randy Leptien stated that residential lighting was not funded by the assessments, but he would take Mr. Uhrhammer's recommendations back to the Public Works manager. Director Leach stated that she would find out about the owls.

**Motion:**

Motion to recommend to Council to accept staff recommendations to fund Albany Hill vegetation management for \$30,000 and \$10,000 annually made by Commissioner Kindle and seconded by Commissioner Mullarkey. Motion carried all in favor.

**6-3. Accessibility of Albany Parks: Review accessibility of Albany parks to determine if any changes/additions need to be made.** Director Leach stated that there had been concerns about ADA accessibility in parks and the staff report addressed possible solutions for the problems and some of the costs.

Commissioner Kindle clarified some of the practical problems and stated that regular maintenance was important for ADA accessibility according to Berkeley standards. He suggested an annual audit to evaluate ADA accessibility compliance, and asked if there were funds available. Vice Chair Mullarkey suggested tabling the issue until next months meeting, for further discussion of annual audits for all parks including Ohlone.

**6-4. Terrace Park: Update and recommendations regarding issues brought to the Commission from Terrace Park residents.** Director Leach stated that items 6-4 and 6-5 could be discussed together. She stated that Council had not acted on all four of the recommendations that the Commission had made for Terrace Park. Council agreed to remove three of the BBQ stands, but did not act on any of the other recommendations.

Terrace Park residents asked for additions to the signage in the park including a good neighbor message about picking up garbage, no glass in the park, park hours and notification of two City ordinances requiring picking up of dog feces and dogs under the control of a capable person. There was currently no code for enforcement of hours in Albany parks.

Director Leach recommended including language in the municipal code for hours that dogs would not be allowed in parks. She recommended leaving the language vague, which would allow each park including the waterfront to easily be more specific about hours via resolution if necessary, and allow time for evaluation. Funding for doggie bag stations would be partially donated by the Community Foundation.

Commissioner Kindle stated that no dogs in play structure areas, proper voice control as well as dogs not creating a nuisance to other park users should be added.

**Public Comment:** Terrace Park neighbor, Bill Cooper, stated that people should be able to go into parks without being bothered by dogs and proper control language should be more specific. He further asked that the dog bag stations should be filled frequently.

Commissioner Como stated that the public would monitor the situation, and if the system didn't work, leash laws and specific hours should be discussed.

**Motion:**

Motion to recommend to Council to approve staff verbage with regard to two ordinances stating requirement for picking up dog feces and dogs under voice control at the parks, with the addition of no dogs in play structure areas, if there was not already an ordinance stating so, made by Commissioner Kindle and seconded by Commissioner Como.

**Motion:**

Motion to recommend to Council approval of funding for the doggie stations made by Commissioner Class and seconded by Commissioner Kindle. Motion carried all in favor.

**Motion:**

Motion to create and install signs with language as indicated in the staff report with the addition of garbage in the proper receptacles made by Commissioner Kindle and seconded by Commissioner Como. Motion carried all in favor.

**6-5. Discussion re Dogs in Parks: The Commission will continue to discuss possible options and alternatives for addressing recent concerns regarding dogs in Albany's parks.** Discussed in item 6-4.

**6-6. Proposition WW: The Commission will continue to discuss possible uses of Prop WW funds. An update on the proposed projects is due to Council June 2009.** Director Leach recommended a joint meeting with the Waterfront Committee on April 27<sup>th</sup> to attempt to agree on certain projects for WW funds. The recommendations would then be forwarded to Council via a staff report. Vice Chair Mullarkey stated that the Commission needed a selection strategy to determine projects worthy of the money and recommended using the process used by the Waterfront Committee.

Commissioner Class requested the bond language for Measure R. Director Leach stated that she would get that information and the Burrowing Owl staff report.

Director Leach stated that she needed at least one recommendation from each of the Commissioners by end of business on April 21<sup>st</sup>. Her recommendation for a portion of the money was the creation of a permanent stage at Memorial Park that would cost \$20,000 or less.

**Motion:**

Motion to join the Waterfront Committee for a joint meeting/planning session on April 27<sup>th</sup> to discuss projects for WW funds, to further discuss the recommendations from that meeting at the May Commission meeting, and to forward those recommendations on to Council made by Commissioner Kindle and seconded by Commissioner Como. Motion carried all in favor.

**Public Comment:** Robert Uhrhammer stated that he supported the joint meeting and recommended using WW funds for a Pierce St. Park, as there was great need for a park on that side of Albany. He stated that he would make efforts to contact and set up meetings with CALTRANS to discuss the land.

**6-7. Meeting Dates: Discussion of Commissioner conflicts re next months meeting date as well as a possible joint meeting with the Water Front Committee on Monday, April 27, 2009.** It was agreed that May 14<sup>th</sup> meeting date was workable for a quorum of Commission members and that the Commission would meet with the Waterfront on April 27<sup>th</sup> at 7pm.

**6-8. Tree Task Force Update: Update from the TTF**

**Motion:**

Motion to approve Valerie Risk as a Tree Task Force member made by Commissioner Mullarkey and seconded by Commissioner Kindle. Motion carried all in favor.

**6-9. Ocean View Sports Field Improvements Update: Staff will give an update on the progress of the project.** Director Leach stated that bids were high for the field improvements and there were two alternatives. Project Manager Ana Bernardes could possibly make modifications to the plans to lessen the price. The other alternative was to have Little League build the project for less. Director Leach also proposed creating a community build project, bringing together many community organizations to volunteer and build the project. She stated that she was waiting for more information to determine which alternative would be best.

**7. Future Agenda Items:** Uses for/demolition of the house on the newly purchased Masonic property, possible update on Ohlone Greenway.

**8. Adjournment: 9:13pm**

*Please note that if you provide your name and address when speaking before the Commission/Committee/Board it will become part of the official public record, which will be posted on the Internet.*

NOTE: Any writings or documents provided to a majority of the City Council/Commission regarding any item on this agenda will be made available for public inspection at the Community Center counter located at 1249 Marin Ave during normal business hours, 8:30am-5:00pm, Monday through Friday.

**CITY OF ALBANY  
PARKS AND RECREATION COMMISSION  
STAFF REPORT**

Agenda date: May 14, 2008

**SUBJECT:** Buchanan Bicycle and Pedestrian Path-Design Alternatives  
**FROM:** Aleida Andrino-Chavez, Transportation Planner

---

**STAFF RECOMMENDATION**

Provide comments to the Traffic and Safety Commission on the design alternatives for the Buchanan Bicycle and Pedestrian Path.

**BACKGROUND/DISCUSSION**

In 2007 the City obtained a grant in the amount of \$266,000 for the 35% design and environmental work of the Buchanan Bicycle and Pedestrian path project. This path is intended to close the existing gap in the regional and local bicycle network between the Ohlone Greenway and the Bay Trail. As such, this project is ranked No. 1 in the Alameda Countywide Bicycle Plan and therefore, it makes it a prime candidate for funding. The general concept of the design is to extend the bicycle lanes from Cornell Avenue to San Pablo Avenue, explore the possibility of implementing a bike lane in the westbound direction along the north side of Buchanan Street, and build a bicycle and pedestrian path along the south side of Marin Avenue and Buchanan Street from the intersection with San Pablo Avenue to the Buchanan Bridge over crossing. The path along the south side of Marin and Buchanan requires a crossing to the north side of Buchanan Street in order to merge with the bridge over crossing.

The design and environmental work for the project was commissioned to DMJM Harris and its consulting team in February 2008. The City coordinated a kick off meeting between the consultant and institutional stakeholders along the south side of the proposed path in March of 2008. The stakeholders included the University of California, the Albany Unified School District, Ocean View Elementary School, the USDA, and the Albany Strollers and Rollers (AS&R). Originally, the proposed path crossings were Taylor Street and Pierce Street. The AS&R asked the City to include the evaluation of an alternative that would align the path along the northern limit of the USDA property and under the Buchanan over crossing.

The consultant team divided the project in four segments and proposed different alternatives for each segment. The following are the four segments and their alternatives:

**Segment I: From Cornell Avenue to San Pablo Avenue:**

- Alternative I: Remove 9 trees and conserve parking. Build bulb outs at every intersection on that segment. Replacement of 4 trees planted in the bulb-outs

- Alternative 2: Conserve existing trees and remove existing parking

Segment II: From San Pablo Avenue to the intersection of Buchanan St. and Jackson St.

- One proposal: Align a bicycle path along the south side of Buchanan Street and continue the westbound bicycle lane along the north side of Buchanan St. Install an exclusive right turn lane on Buchanan St. in the eastbound direction. This proposal requires median curb realignment, reduction of traffic flow lanes from 12 feet to 11 feet, and additional right-of-way from the University of California for the construction of the right turn lane.

Segment III: From the intersection of Buchanan Street and Jackson Street to the Ocean View Park entrance driveway. Note: there are 25 parking spaces along the south side of Buchanan St.

- Alternative 1: Remove 3 Redwood trees at Ocean View School yard and 2 Redwood trees at Ocean View Park. Install 7 bulb outs and plant trees on five of them to replace the removed trees. Remove 9 to 10 parking spaces (15-16 parking spaces left)
- Alternative 2: Remove 20 parking spaces and conserve all the trees (five parking spaces left).
- Alternative 3: Remove 15 parking spaces, remove 5 young trees and split the path around the mature Redwood trees along Ocean View Park (10 parking spaces left). Conserve the Redwood trees at Ocean View Elementary School.

Segment IV From Taylor Street to the Buchanan Bridge Over crossing

- Alternative 1: Cross the path to the north side of Buchanan Street at Taylor Street. A traffic signal would be needed at this location for the path crossing; however, it is not warranted by any of the parameters. Remove 11 trees ranging from 9" to 3" trunk diameter. Remove parking along the north side of Buchanan Street from Taylor to Pierce St.
- Alternative 2: Cross the path to the north side of Buchanan St. at Pierce St. Vehicular right-turning volumes at this location warrant the implementation of a traffic signal.  
This alternative proposes the closure of the Buchanan St. spur leading to Cleveland St. to create a safer bicycle and pedestrian connection between the proposed path and the Buchanan Bridge Over Crossing. *Note: the Traffic Engineer recommends this location as the best crossing alternative for the path.*
- Alternative 3: Bring the path along the northern limit of the USDA property and under the Buchanan Over Crossing.



- Alternative 4: Bring path around the Redwood trees and along the east side of the Cleveland spur. This creates a 14% slope path from the Buchanan spur/Cleveland intersection under the bridge and the bridge access.
- Alternative 5: Bring path around the Redwood trees and along the west side of the Cleveland spur. This yields a 22% slope for the path from the Buchanan spur/Cleveland intersection to the bridge access.

Project Meeting schedule:

-Design alternatives presentation to the institutional stakeholders: USDA, School District, and University of California—March 11, 2009

-Design Alternatives presentation to the Albany Strollers and Rollers—March 13, 2009

-Initial design alternatives presentation to the Traffic and Safety Commission Meeting—March 26, 2009

-Design alternatives presentation to the Parks and Recreation Commission meeting—May 14, 2009

-Traffic and Safety Commission to formulate recommendation to City Council—May 28, 2009

-Project consideration by City Council—June 15, 2009

Large-scale plans of the project will be available at the presentation to the Parks and Recreation Commission on May 14, 2009.

Attachments

Project plans

CLIENT:  
**Buchanan Bikeway**  
 Feasibility Study  
 FOR  
 CITY OF ALBANY, CA

1000 SAN PABLO AVENUE  
 ALBANY, CALIFORNIA 94706  
 (510) 528-5760

DESIGNER:  
**AECOM**  
 155 Grand Avenue, Suite 700  
 Oakland, CA 94612  
 510.763.2929  
 510.763.2796

CONSULTANTS:

REGISTRATION:

| REV | DATE | DESCRIPTION |
|-----|------|-------------|
|     |      |             |
|     |      |             |
|     |      |             |
|     |      |             |
|     |      |             |
|     |      |             |
|     |      |             |
|     |      |             |
|     |      |             |
|     |      |             |
|     |      |             |

PROJECT NO: 60043220  
 DRAWN BY:  
 CHECKED BY:  
 SCALE: 1"=40'  
 DRAWING START DATE:  
 KEY PLAN:

DRAWING TITLE:

PRELIMINARY BIKEWAY  
 LAYOUT  
 BUCHANAN STREET

DRAWING NUMBER:

1

SHEET

REV



ALTERNATIVE 1 - BIKEWAY CLASS I

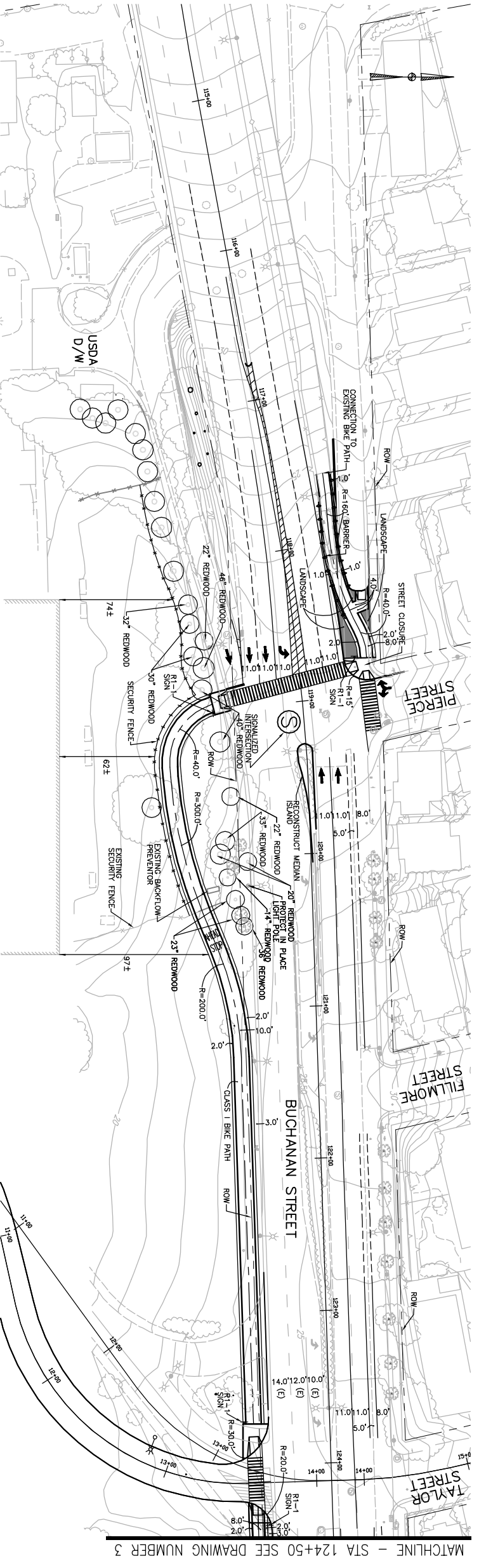

ALTERNATIVE 2 - BIKEWAYS CLASS I AND CLASS II

A  
 B  
 C  
 D  
 1  
 2  
 3  
 4  
 5

CLIENT:  
**Buchanan Bikeway  
 Feasibility Study**  
 FOR

CITY OF ALBANY, CA  
 1000 SAN PABLO AVENUE  
 ALBANY, CALIFORNIA 94706  
 (510) 528-5760

DESIGNER:  
**AECOM**  
 155 Grand Avenue, Suite 700  
 Oakland, CA 94612  
 510.763.2929  
 510.763.2796

CONSULTANTS:

REGISTRATIONS:

| REV | DATE | DESCRIPTION |
|-----|------|-------------|
|     |      |             |
|     |      |             |
|     |      |             |
|     |      |             |
|     |      |             |
|     |      |             |
|     |      |             |
|     |      |             |
|     |      |             |

PROJECT NO: 60043220  
 DRAWN BY:  
 CHECKED BY:  
 SCALE: 1"=40'  
 DRAWING START DATE:  
 KEY PLAN:

DRAWING TITLE:  
**PRELIMINARY BIKEWAY  
 LAYOUT  
 BUCHANAN STREET**

DRAWING NUMBER:  
**2**

SHEET: REV

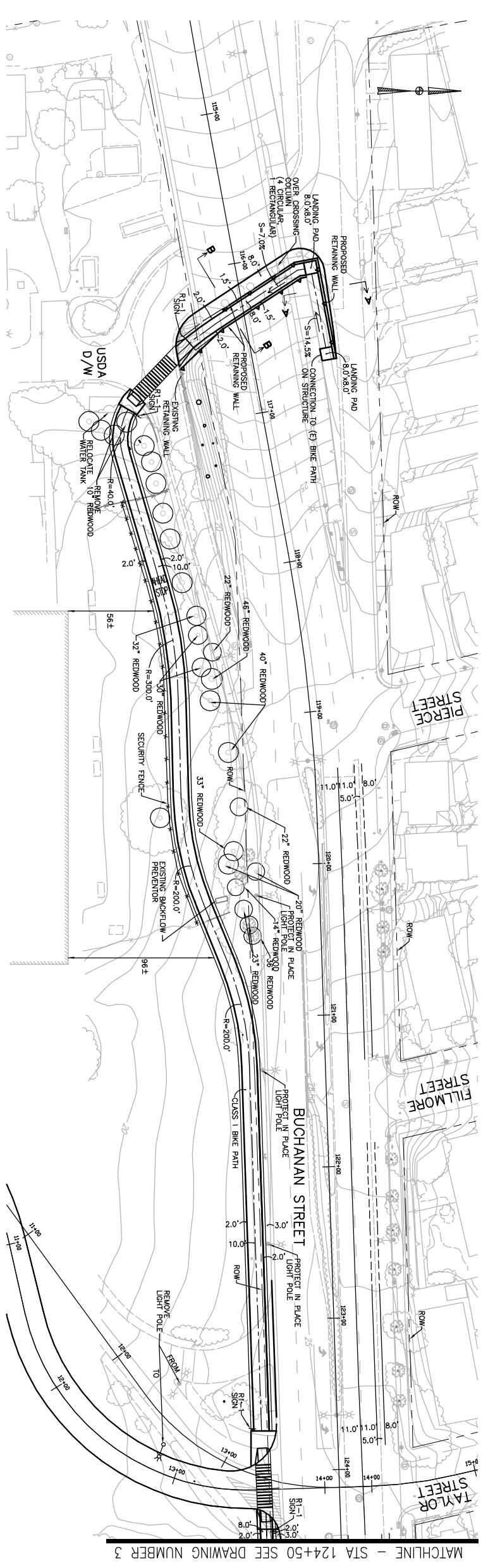

**ALTERNATIVE 3 - OPTION 1 - BIKEWAYS CLASS I AND CLASS II**

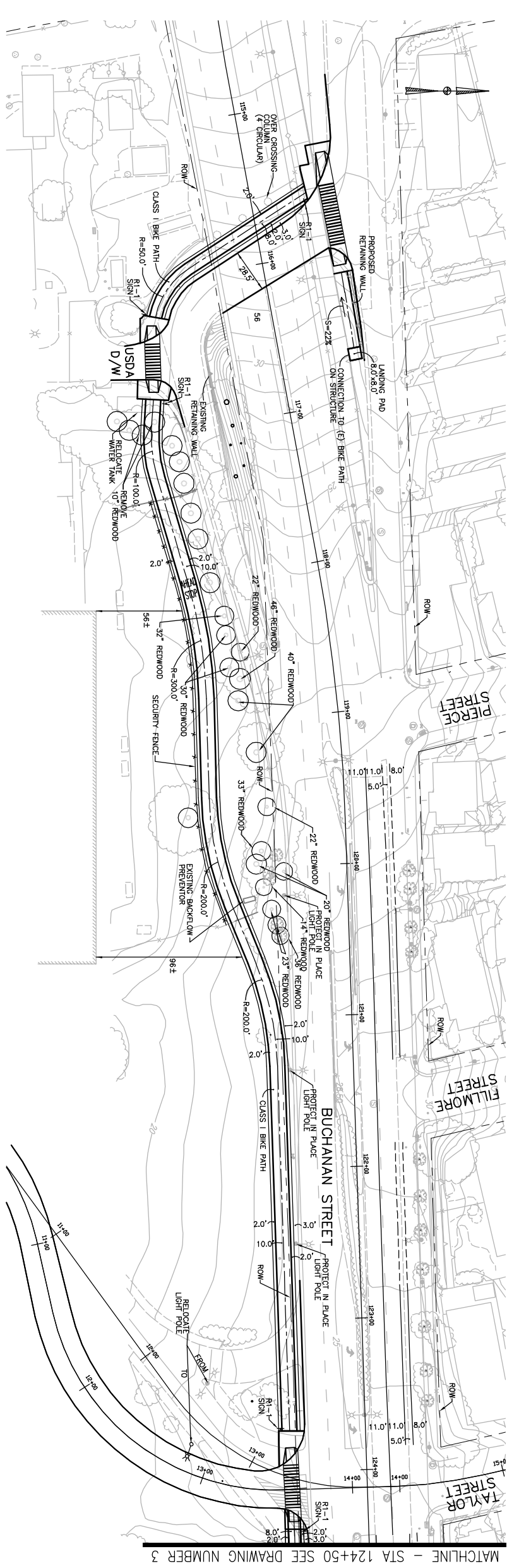

**ALTERNATIVE 3 - OPTION 2 - BIKEWAYS CLASS I AND CLASS II**

© 2003 DMJM+HARRIS

1 2 3 4 5

CLIENT:

Buchanan Bikeway  
Feasibility Study

FOR  
CITY OF ALBANY, CA  
1000 SAN PABLO AVENUE  
ALBANY, CALIFORNIA 94706  
(510) 528-5760

DESIGNER:

**AECOM**  
155 Grand Avenue, Suite 700  
Oakland, CA 94612  
510.763.2929  
510.763.2796

CONSULTANTS:

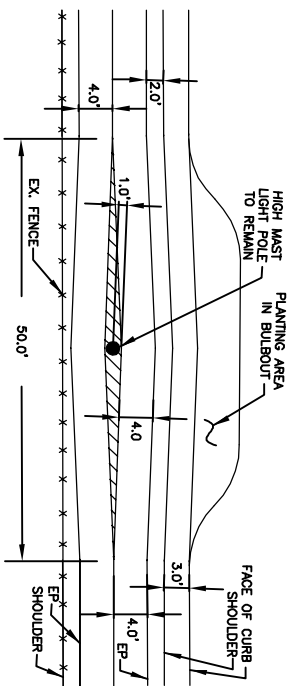

**DETAIL A**

MATCHLINE - STA 124+50 SEE DRAWING NUMBER 1 & 2 ALTERNATIVE 1, ALTERNATIVE 2 & ALTERNATIVE 3

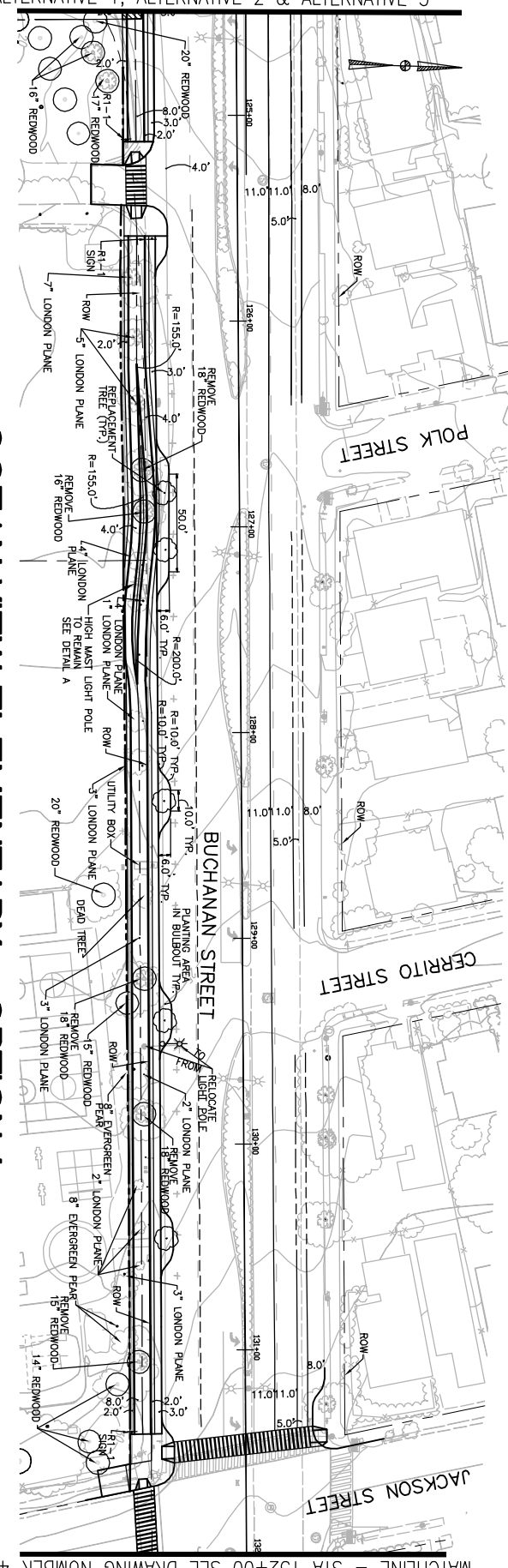

MATCHLINE - STA 132+00 SEE DRAWING NUMBER 4

**OCEAN VIEW ELEMENTARY - OPTION 1**

MATCHLINE - STA 124+50 SEE DRAWING NUMBER 1 & 2 ALTERNATIVE 1, ALTERNATIVE 2 & ALTERNATIVE 3

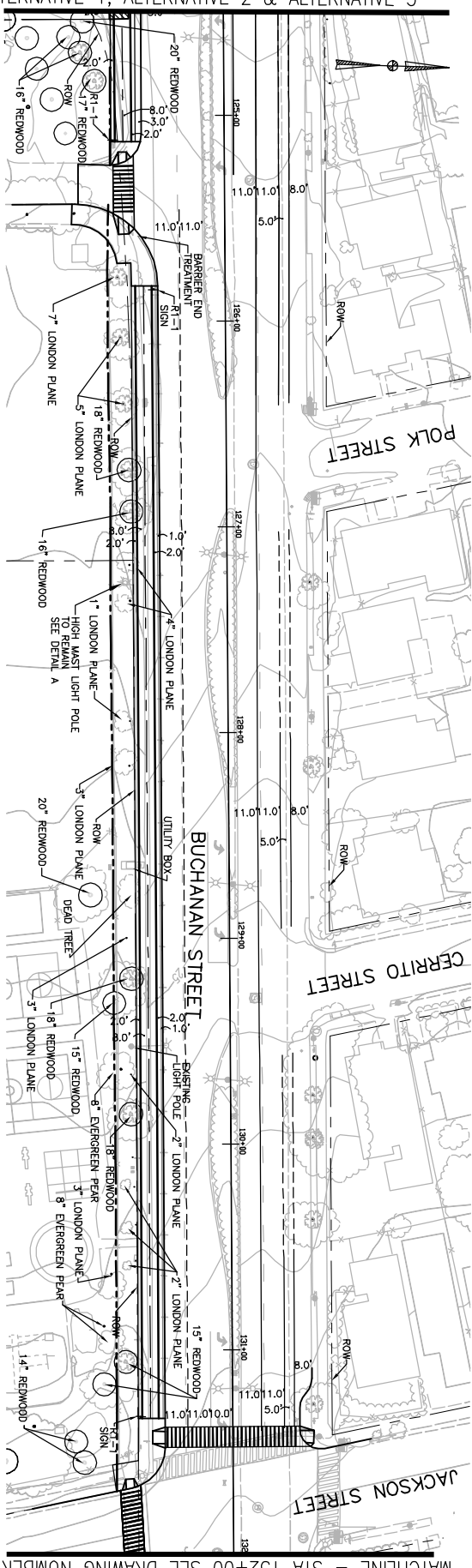

MATCHLINE - STA 132+00 SEE DRAWING NUMBER 4

**OCEAN VIEW ELEMENTARY - OPTION 2**

MATCHLINE - STA 124+50 SEE DRAWING NUMBER 1 & 2 ALTERNATIVE 1, ALTERNATIVE 2 & ALTERNATIVE 3

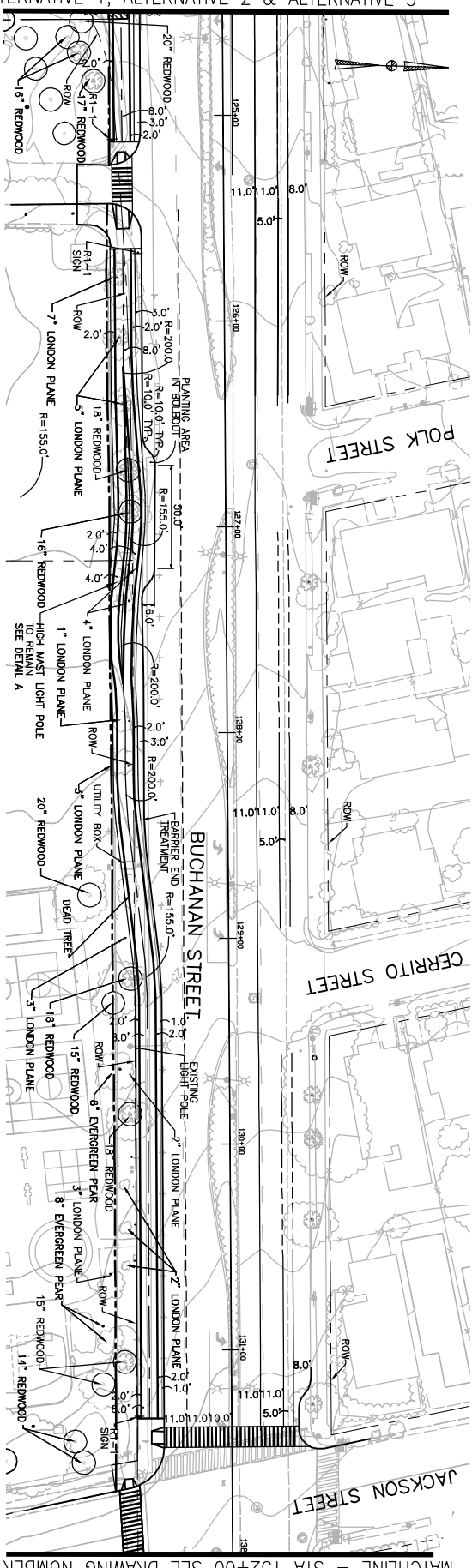

MATCHLINE - STA 132+00 SEE DRAWING NUMBER 4

**OCEAN VIEW ELEMENTARY - OPTION 3**

| REV | DATE | DESCRIPTION |
|-----|------|-------------|
|     |      |             |
|     |      |             |
|     |      |             |
|     |      |             |
|     |      |             |
|     |      |             |
|     |      |             |
|     |      |             |
|     |      |             |
|     |      |             |
|     |      |             |

PROJECT NO: 60043220

DRAWN BY:

CHECKED BY:

SCALE: 1"=40'

DRAWING START DATE:

KEY PLAN:

DRAWING TITLE:

PRELIMINARY BIKEWAY  
LAYOUT  
BUCHANAN STREET

DRAWING NUMBER:

**3**

SHEET: REV

© 2003 DMJM+HARRIS

CLIENT:  
**Buchanan Bikeway  
 Feasibility Study**

FOR  
 CITY OF ALBANY, CA  
 1000 SAN PABLO AVENUE  
 ALBANY, CALIFORNIA 94706  
 (510) 528-5760

DESIGNER:  
**AECOM**

155 Grand Avenue, Suite 700  
 Oakland, CA 94612  
 510.763.2929  
 510.763.2796

CONSULTANTS:

REGISTRATION:

| REV | DATE | DESCRIPTION |
|-----|------|-------------|
|     |      |             |
|     |      |             |
|     |      |             |
|     |      |             |
|     |      |             |
|     |      |             |
|     |      |             |
|     |      |             |
|     |      |             |
|     |      |             |
|     |      |             |

PROJECT NO.: 60043220  
 DRAWN BY:  
 CHECKED BY:  
 SCALE: 1"=40'  
 DRAWING START DATE:  
 KEY PLAN:

DRAWING TITLE:

**PRELIMINARY BIKEWAY  
 LAYOUT  
 BUCHANAN STREET**

DRAWING NUMBER:

**4**

SHEET

REV

© 2003 DMJM+HARRIS

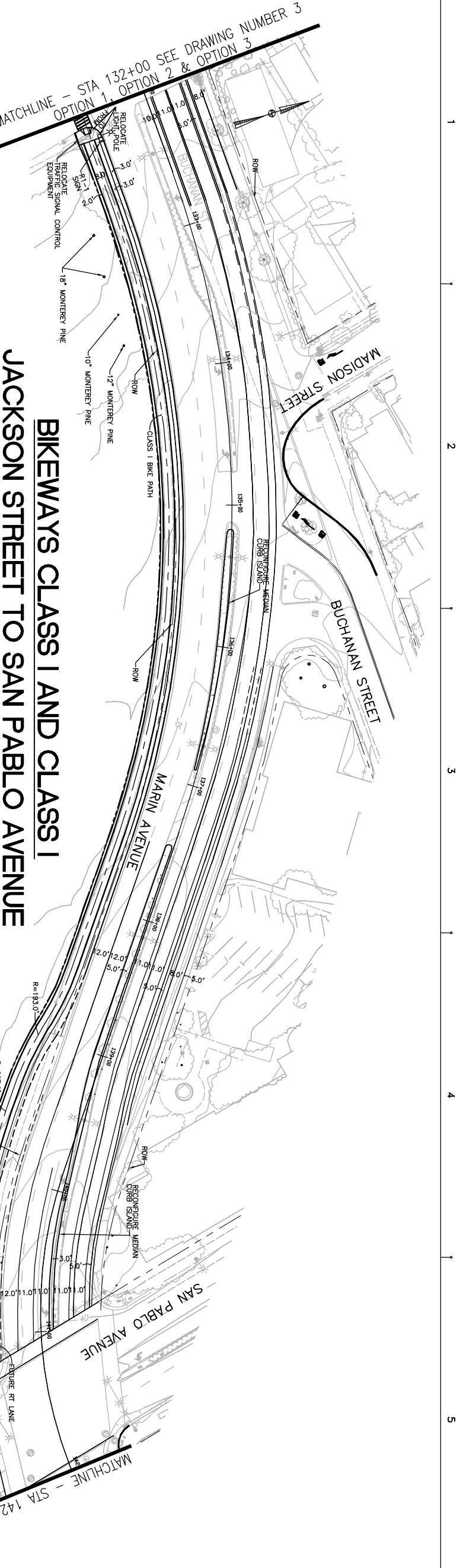

**BIKEWAYS CLASS I AND CLASS I  
 JACKSON STREET TO SAN PABLO AVENUE**

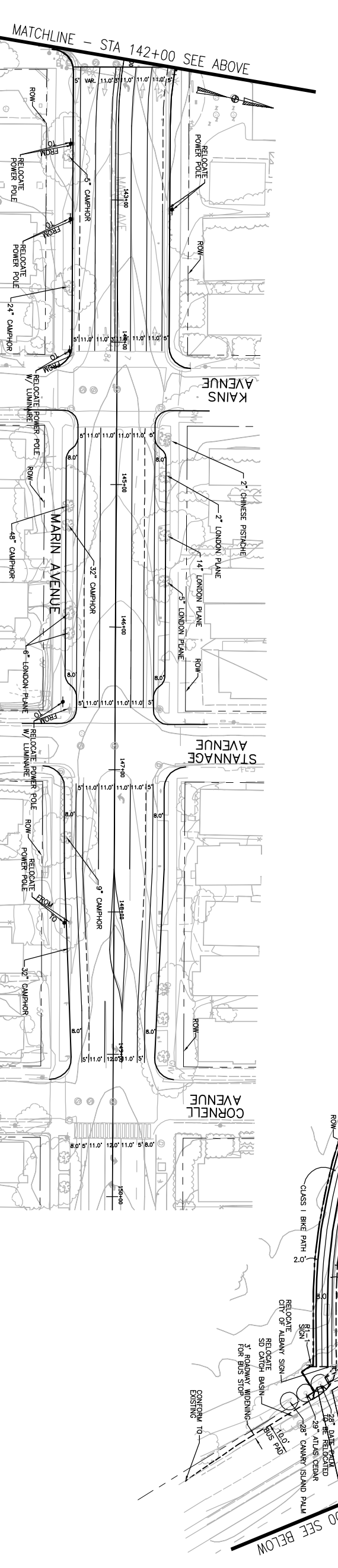

**MARIN AVENUE ALTERNATIVE 1 - BIKEWAY CLASS II (WIDEN-REMOVE TREES)**

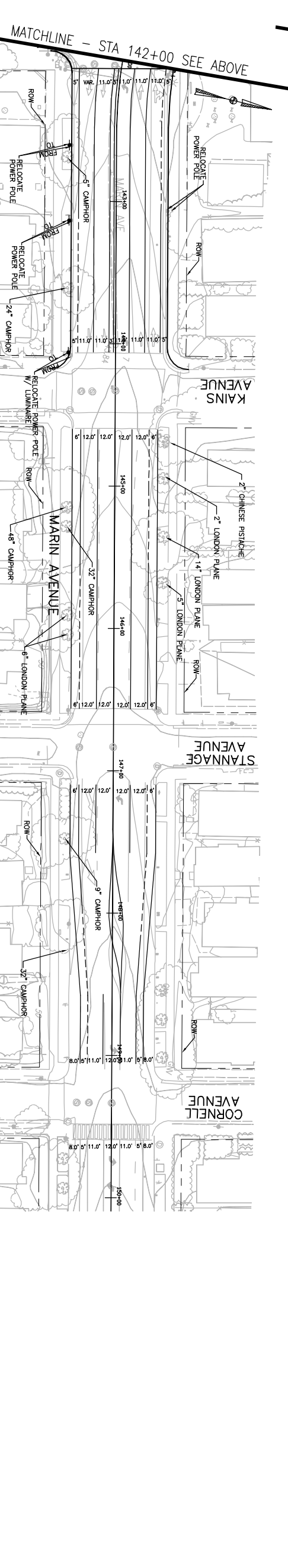

**MARIN AVENUE ALTERNATIVE 2 - BIKEWAY CLASS II (REMOVE PARKING)**

1 2 3 4 5

CLIENT:  
**Buchanan Bikeway**  
 Feasibility Study

FOR  
 CITY OF ALBANY, CA

1000 SAN PABLO AVENUE  
 ALBANY, CALIFORNIA 94706  
 (510) 528-5760

DESIGNER:  
**AECOM**

155 Grand Avenue, Suite 700  
 Oakland, CA 94612  
 510.763.2929  
 510.763.2796

CONSULTANTS:

REGISTRATION:

PROJECT NO.: 60043220  
 DRAWN BY:  
 CHECKED BY:  
 SCALE: 1"=20'  
 DRAWING START DATE:

| REV | DATE | DESCRIPTION |
|-----|------|-------------|
|     |      |             |
|     |      |             |
|     |      |             |
|     |      |             |
|     |      |             |

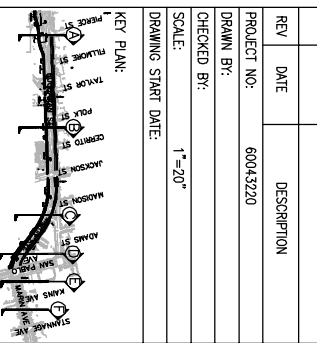
KEY PLAN:  

DRAWING TITLE:  
**BIKEWAY SECTIONS**  
**BUCHANAN STREET**

DRAWING NUMBER:  
**5**

SHEET REV

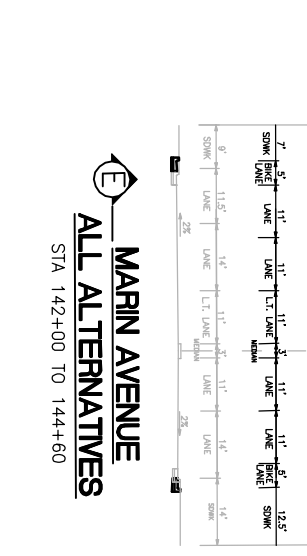
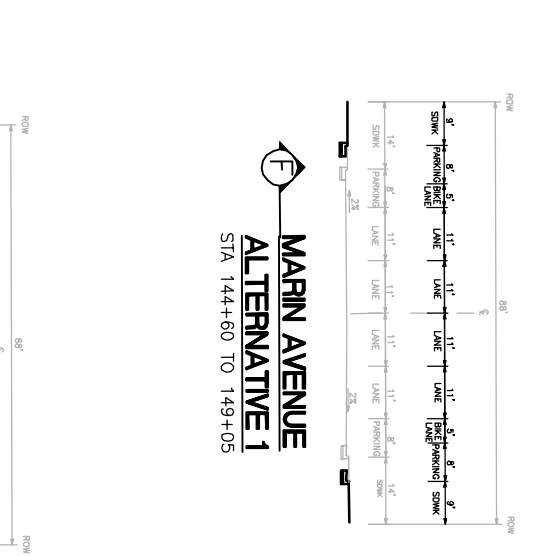
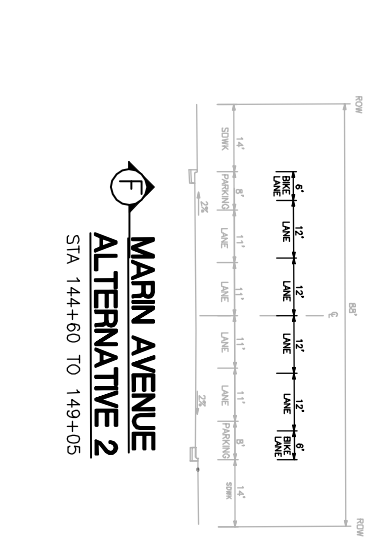
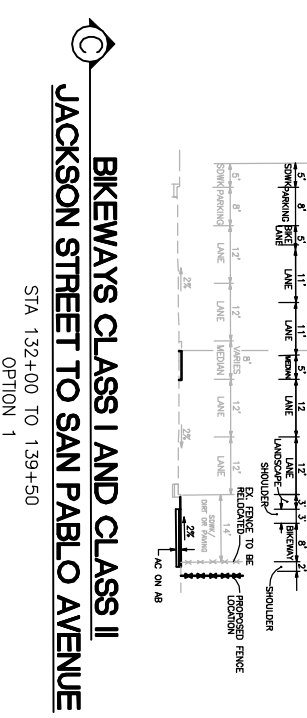
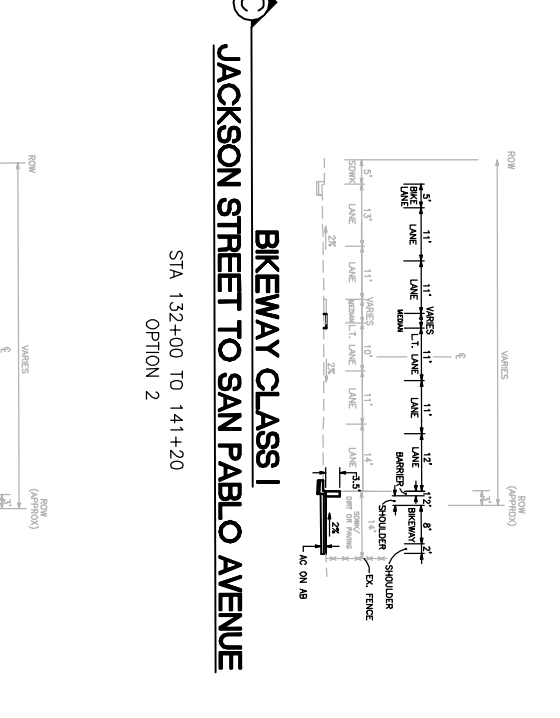
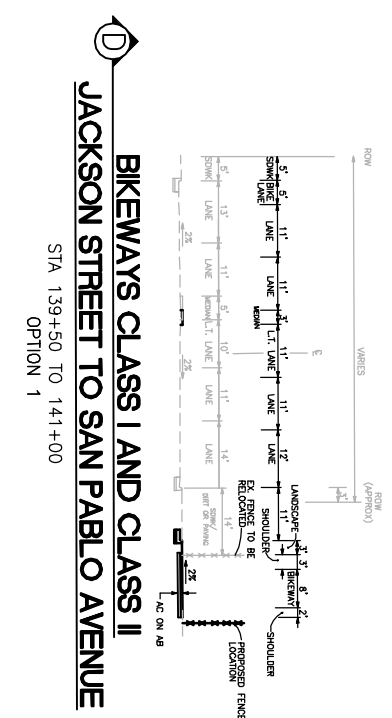
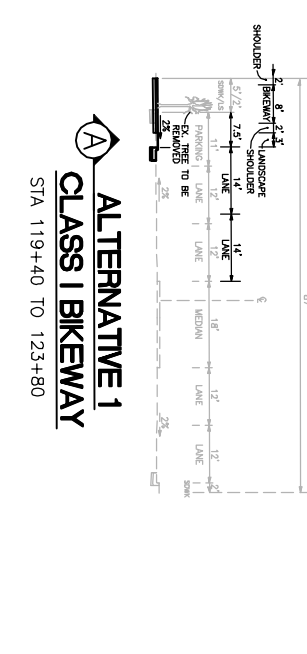
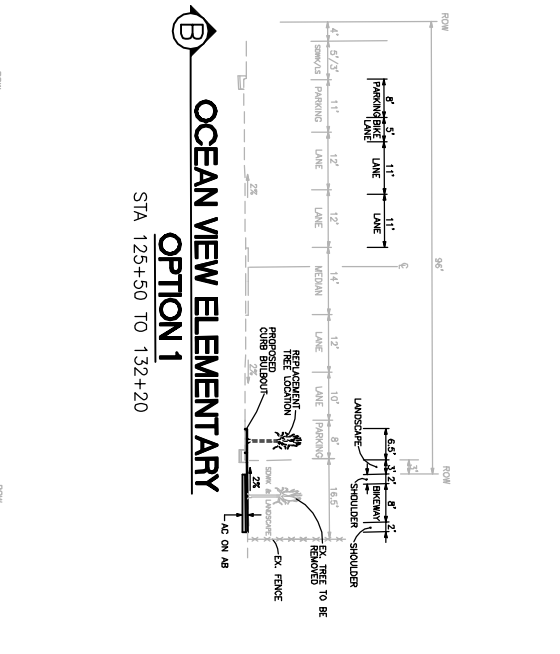
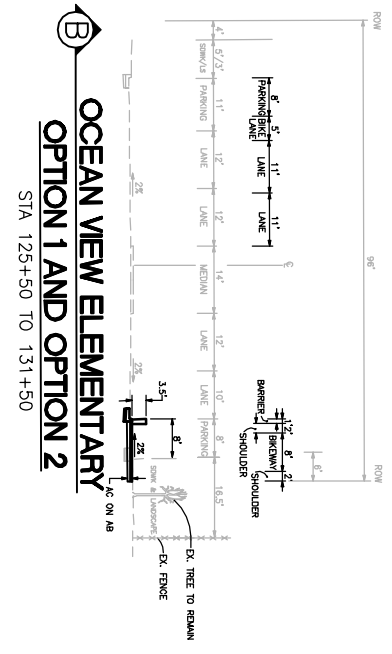
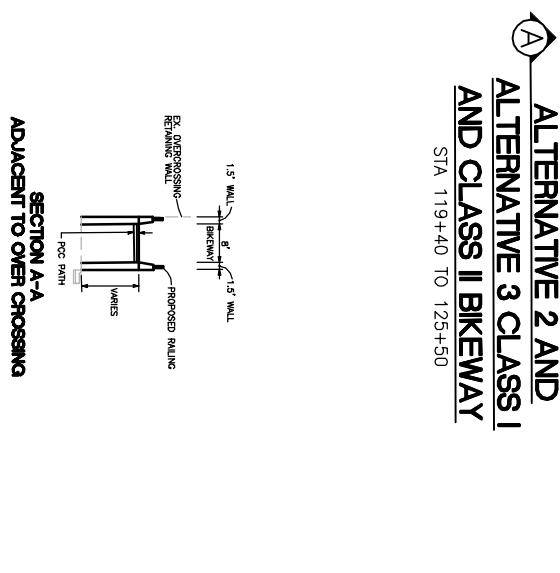
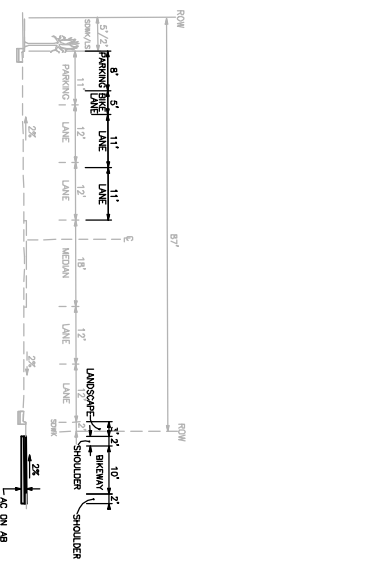

A B C D

**CITY OF ALBANY  
PARKS AND RECREATION COMMISSION  
STAFF REPORT**

Agenda date: May 14, 2009

**SUBJECT:** Accessibility in Albany's Parks

**REPORTED BY:** Penelope Leach, Recreation and Community Services Director  
Rich Cunningham, Public Works Manager

---

**RECOMMENDATION**

Information only.

**BACKGROUND**

The purpose of this staff report is to give the Commission an idea of the current accessibility concerns at Albany parks that staff is aware of to date. This staff report is not an attempt to address all of the issues community members may wish to discuss with the Commission, as staff may not be aware of all of their concerns. Two concerns of which staff is aware pertain to Ocean View Park regarding the use and maintenance of the fibar surface in the playground area and the two Americans with Disabilities Act (ADA) garden beds located in the community garden.

The concern regarding the use of fibar in the play area at Ocean View Park and whether or not it is ADA compliant was raised to City staff in October 2007. Staff asked the park design architect for information regarding fibar's ADA compliance. The architect's response was as follows:

"Fibar is a widely used, less expensive alternative to poured-in-place (rubberized) surfacing. They both accomplish the same thing - they provide wheel chair access to play features and also act as a safety cushion from the tallest "fall-height" of the specified equipment. It is a ASTM (American Society of Testing Materials) approved product. This product is also endorsed by ADAAG (American with Disabilities Accessibility Guidelines) and IPEMA (International Playground Equipment Manufacturer's Association). It is deemed wheelchair accessible by [all] organization[s] that have any influence or involvement in playground design and accessibility."

The question lately appears to be the unevenness of the fibar surface and how often it is groomed to maintain a level surface. There are a few issues staff is having regarding the fibar surface. For instance, additional fibar needs to be added in the areas that are prone to more wear and tear and to keep the level flush with the sidewalk. Typically fibar is only delivered in very large quantities. Finding a place to store the material until it is

needed is one issue. Staff is working with the fibar distributor to see if the City can have smaller loads delivered, possibly in bags. Another issue is how often staff should and is able to maintain the area. There are non-specific intervals stated in the Fibar maintenance instructions that would require two full days to dig in and turn over the Fibar to fluff it up. It is also an intense type labor that calls for machine assistance. Staff is also looking into this with the Fibar distributor.

An alternative to the fibar surface is a rubberized surface like that used at the main play area at Memorial Park. During the recent renovations when Ocean View Park was in its design phase, the rubberized surface was considered, but was cost prohibitive. Staff met with a representative from Tot Turf, a primary distributor of rubberized playground surfaces, in March 2009 to discuss the cost of covering the play area at Ocean View Park with the rubberized surface. The cost to cover the entire play area at Ocean View Park is estimated to be \$62,222. This estimate does not include the removal and disposal of the existing fibar, which would add approximately \$25,000 to the estimate, for a total estimate of \$87,222. A second alternative would be to cover only a portion of the play area and use a combination of fibar and rubberized surface. The area under and around the ADA swing as well as the area under and around the play structure could be covered for an estimated cost of \$30,868. The cost of removing and disposing of the existing fibar for this portion of the total area would be an additional \$13,500, for a total estimate of \$44,368. Please see the attached estimates and a sketch of the play area showing the partial rubberized surface alternative. The square footage of the rubberized surface for the second alternative could be diminished to further bring down the cost.

Regarding the ADA garden beds at Ocean View, staff does not have a clear understanding of the concerns at the this time, but is open to hearing from the public their concerns and any solutions they may have.

### **SUSTAINABILTY IMPACT**

Tot Turf uses recycled California tires in their product and the product does not have to be replaced due to wear and tear. Instead, Tot Turf resurfaces playgrounds at a slightly lesser cost than the original installation so there is no need to dispose of the surface. The rubberized surface lasts between 5 to 8 years before having to be resurfaced depending on the level of use and the exposure to heat and sunlight.

### **FISCAL IMPACT**

Estimated cost of:

|  |          |
|--|----------|
| Rubberized Surface covering the entire playground site | \$87,222 |
| Rubberized Surface covering a portion of the site:     | \$44,368 |

With the rubberized surface, there would be an initial cost savings as the City would not have to maintain and refill the fibar; however, the rubberized surface has to be resurfaced every 5 to 8 years at a cost that is between 65%-75% of the original cost. For example, if



the original cost to cover the entire surface was \$62,222, the replacement cost would be approximately \$40,444 - \$46,666. Similarly, if the original cost to cover a portion of the area was \$30,868, the cost for resurfacing would be approximately \$20,064 - \$23,151.

If the Commission recommends a rubberized surface, the Commission would need to add this project to the projects for consideration of Measure WW funds, as there are no other funds available at this time.

#### Attachments

Tot Turf estimates and sketch

Estimated cost for covering entire OV playground site



**By Robertson Industries**  
 4145 W. Mercury Way  
 Chandler, Az 85226  
 602.340.8873 | Fax: 602.340.0402

**Project Number P09-3392**  
**03/29/2009**  
 For Official Use Only

An IPEMA Certified Product

**PROJECT INFORMATION**

Name OCEANVIEW PARK - ALBANY  
 Address 900 BUCHANAN  
 ALBANY, CALIFORNIA 94706  
 Contact PENELOPE LEACH  
 Phone 510-524-9283  
 Fax 510-528-8914

**SALES CONTACT**

**Alex Tsitovich**  
 Phone (510)381-8294  
 Fax (925) 256-6472

Terms and Conditions: Quote is based on the information provided and is subject to change based on final installation unless indicated below. Sub-base provided by others is to meet TotTurf specifications and grade elevations. Sub-base work performed by others is the responsibility of the owner. In the event that a change in color, color percentage, thickness, or square footage is requested, a revised proposal and/or purchase order will be required before installation can begin. Bonding is not included in quote pricing unless otherwise specified.

|                |            |                    |    |                  |     |
|----------------|------------|--------------------|----|------------------|-----|
| Wage Rate      | Prevailing | Aliphatic Urethane | No | Excavation       | No  |
| Impact Testing | No         | Saw Cutting        | No | Turn Down (SqFt) | 0.0 |

| Product Type | Product Description              | Total Sq Ft |
|--------------|----------------------------------|-------------|
| TotTurf PIP  | NEW 3.5' 50-50 BLK AND STD COLOR | 5000.0      |

**Special Notes:**

1. COLOR TO BE 50% BLACK AND CUSTOMER TO SELECT 50% FROM BLUE, GREEN, TERRA COTTA RED OR TAN. 2. DOES NOT INCLUDE SITE PREPARATION BY OTHERS: REMOVE AND DISPOSE OF 16" DEEP ENGINEERED WOOD FIBER; ADD 12.5" NEW BASE AGGREGATE WITH A MINIMUM OF 4" CLASS 2 AB COMPACTED IN 2" LIFTS TO 95% COMPACTION. 3. PRICING IS BASED UPON TRUCK BEING ABLE TO ACCESS PLAY AREA AND PARK ON CONCRETE WALKWAY WITH 50' OF PLAY AREA.

|                    |                    |
|--------------------|--------------------|
| Pad Base Price     | \$60,366.44        |
| Subbase            | \$0.00             |
| Discount           | \$0.00             |
| Tax                | \$1,855.52         |
| <b>Total Price</b> | <b>\$62,221.96</b> |
| Total Unit Price   | \$12.44            |

Prepared By: \_\_\_\_\_ Quote is Valid Until: 06/27/2009



Help prolong the life of your new TotTurf product! The Robble Maintenance Program is designed to add years of life to your safety surface. For more information please contact your sales representative at the number above or call our corporate office at 1-800-858-0519



This Project will recycle 3,906 Passenger Tire Equivalents (PTE's)



**Estimate Only**  
**Does not include cost of removing fibar**

Estimated cost for covering a portion of the site.  
See attached sketch.

3/10



**By Robertson Industries**  
4145 W. Mercury Way  
Chandler, Az 85226  
602.340.8873 | Fax: 602.340.0402

**Project Number P09-3393**  
**03/29/2009**  
For Official Use Only

An IPEMA Certified Product

**PROJECT INFORMATION**

Name OCEANVIEW PARK - ALBANY  
Address 900 BUCHANAN  
ALBANY, CALIFORNIA 94706  
Contact PENELOPE LEACH  
Phone 510-524-9283  
Fax 510-528-8914

**SALES CONTACT**

**Alex Tsitovich**  
Phone (510)381-8294  
Fax (925) 256-6472

Terms and Conditions: Quote is based on the information provided and is subject to change based on final installation unless indicated below. Sub-base provided by others is to meet TotTurf specifications and grade elevations. Sub-base work performed by others is the responsibility of the owner. In the event that a change in color, color percentage, thickness, or square footage is requested, a revised proposal and/or purchase order will be required before installation can begin. Bonding is not included in quote pricing unless otherwise specified.

|                |            |                    |    |                  |       |
|----------------|------------|--------------------|----|------------------|-------|
| Wage Rate      | Prevailing | Aliphatic Urethane | No | Excavation       | No    |
| Impact Testing | No         | Saw Cutting        | No | Turn Down (SqFt) | 345.0 |

| Product Type | Product Description              | Total Sq Ft |
|--------------|----------------------------------|-------------|
| TotTurf PIP  | NEW 3.5' 50-50 BLK AND STD COLOR | 2426.0      |

**Special Notes:**

1. COLOR TO BE 50% BLACK AND CUSTOMER TO SELECT 50% FROM BLUE, GREEN, TERRA COTTA RED OR TAN. 2. DOES NOT INCLUDE SITE PREPARATION BY OTHERS: REMOVE AND DISPOSE OF 16" DEEP ENGINEERED WOOD FIBER; ADD 12.5" NEW BASE AGGREGATE WITH A MINIMUM OF 4" CLASS 2 AB COMPACTED IN 2" LIFTS TO 95% COMPACTION. 3. PRICING IS BASED UPON TRUCK BEING ABLE TO ACCESS PLAY AREA AND PARK ON CONCRETE WALKWAY WITH 50' OF PLAY AREA.

|                    |                    |
|--------------------|--------------------|
| Pad Base Price     | \$29,967.80        |
| Subbase            | \$0.00             |
| Discount           | \$0.00             |
| Tax                | \$900.30           |
| <b>Total Price</b> | <b>\$30,868.11</b> |
| Total Unit Price   | \$12.72            |

Prepared By: \_\_\_\_\_ Quote is Valid Until: **06/27/2009**



Help prolong the life of your new TotTurf product! The Robbie Maintenance Program is designed to add years of life to your safety surface. For more information please contact your sales representative at the number above or call our corporate office at 1-800-858-0519



This Project will recycle 1,895 Passenger Tire Equivalents (PTE's)



**Estimate Only**  
**Does not include cost of removing fiber**

TOTTURF WORKSHEET: TSITOVICH

|           |                         |        |                   |            |                |
|-----------|-------------------------|--------|-------------------|------------|----------------|
| PROJECT:  | OCEANVIEW PARK - ALBANY | OWNER: | CITY              | DATE:      | 3/25/9         |
| CITY      | ALBANY                  |        | ALBANY            |            |                |
| NAME      |                         |        | RECREATION & CS   |            |                |
| ADDRESS   | 900 BUCHANAN            |        | 1249 MARIN AVENUE | WAGE RATE: | PREVAILING     |
| CITY      | ALBANY                  |        | ALBANY            |            |                |
| STATE/ZIP | CA 94706                |        | CA 94706          | COLORS:    |                |
| PHONE     |                         |        | 510-524-9283      |            | EXISTING ENTRY |
| FAX       |                         |        | 510-528-8914      |            | PAD 50.50      |
| CELL      |                         |        |                   |            | GEN. BLK       |
| EMAIL     |                         |        |                   |            |                |
| CONTACT   |                         |        | PENELOPE LEACH    |            |                |
| COUNTY    | ALAMEDA 8.75%           |        |                   |            |                |

NOTES: 1. CHANGEPLAY AREA FROM EWF TO PIP: "ENVIRONMENTALLY GREEN" CITY

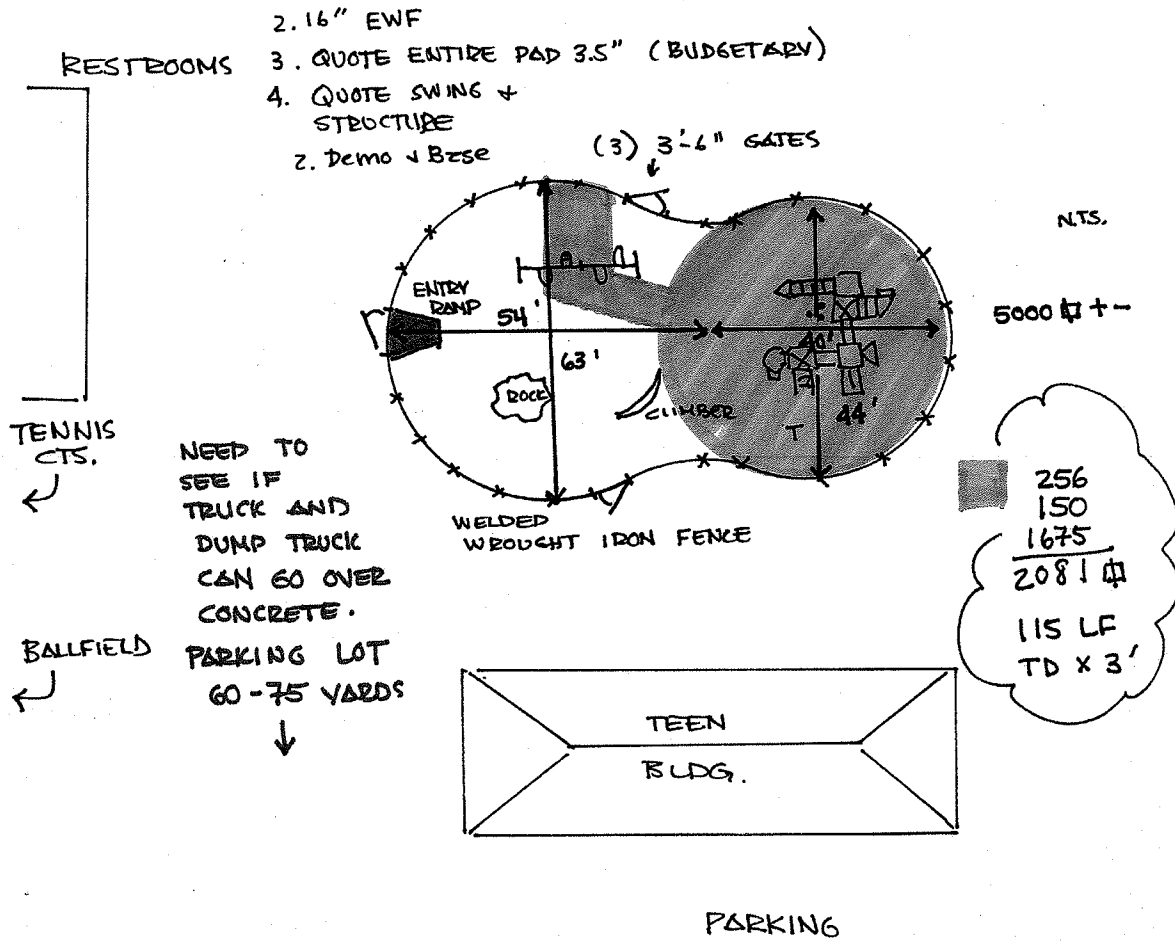

Estimate Only  
 Does not include cost of removing fibar

CITY OF ALBANY  
PARKS AND RECREATION COMMISSION  
STAFF REPORT

Agenda date: April 14, 2009

**TO:** Parks and Recreation Commission  
**FROM:** Penelope Leach, Recreation and Community Services Director  
**SUBJECT:** East Bay Regional Park District Proposition WW

---

**RECOMMENDATION**

Discuss possible uses for Proposition WW funds.

**BACKGROUND**

East Bay Regional Parks District Measure WW, which passed in November 2008, is an extension of Measure AA passed by East Bay voters 20 years ago. Measure AA helped preserve 34,000 acres of open space, developed over 100 miles of new trails, and funded hundreds of local parks and recreation projects. While much has been accomplished, the growing East Bay population further increases the need for acquiring new parklands, protecting and restoring natural habitat, and helping communities with their local park and recreation facilities. Measure WW will be used to continue to restore urban creeks; protect wildlife; purchase and save open space, wetlands, and bay shoreline; and acquire, develop, and improve local and regional parks, trails, and recreational facilities close to home for East Bay residents.

The measure allocates funds to cities based on population. The City of Albany will be allocated \$771,363, and has up to the year 2018 to use the funds. Cities are able to submit projects to East Bay Regional Park District in February and March of each year. This allows East Bay Regional Park District the ability to sell enough bonds, on an as-needed basis, to pay for the submitted eligible projects.

At the February 2, 2009 Council meeting, the City Council voted to refer to the Parks & Recreation Commission for discussion, deliberation and recommendation regarding the use of the City of Albany's per capita portion of Measure WW funds, and to also refer to the Waterfront Committee for its recommendation. The Waterfront Committee is to forward to the Parks & Recreation Commission their recommendations by June 2009, when the Commission will present all recommendations to the Council.

**DISCUSSION**

Staff has attended two workshops regarding Proposition WW funds. The purpose of the workshops is to make clear the procedures and guidelines for eligible projects as well as the various documents necessary for reimbursement for projects. In order for a project to be considered, staff must submit an application form, cost estimates, CEQA certification

forms, evidence of ownership or lease and site control of the property, project location map, site plan, photographs, required permits, etc. Cities are required to pay for the project upfront. Cities may be reimbursed throughout the project with 20% of the total cost of the project being retained until the project is complete and signed off by EBRPD.

Since Measure WW passed in November 2008, several projects have been mentioned for use of the funds. Also, in the Parks, Recreation, and Open Space Master Plan completed in 2004, there are project recommendations that have not been developed. Please visit the City's website, [www.albanyca.org](http://www.albanyca.org), to see the full text of the Recommendations Section of the Master Plan. Click on the Parks and Recreation Commission agenda for April 14, 2009 to see the recommendations section. Attached is a brief summary of the recommended projects from the 2004 Master Plan.

Based on discussions from previous meetings with the Commission and community members, below is a list, in no particular order, of items that have been mentioned to date:

1. Add to the funding for the purchase of Pierce Street Park. The land is currently owned by Caltrans. More information regarding Pierce Street Park will be discussed at the May 14, 2009 Commission meeting.
2. Ohlone Greenway improvements
3. Developing the practice field at Memorial Park into a full-sized softball field.
4. Senior Center Expansion.
5. Permanent stage at Memorial Park for the City's special events.
6. Purchase and renovation of the Veteran's Memorial Building.

#### Attachments

Summary of recommendations from the 2004 Parks, Recreation, and Open Space Master Plan.

## **Albany Waterfront Committee**

### **Measure WW –Local Grant Program - \$771,363**

#### **Project Recommendations**

April 13, 2009

- Waterfront Trail Park improvements
  - Permanent enhancements to a city-owned recreational facility consistent with Recreation and Open Space Master Plan
  - Project will promote public use of the waterfront
  - Estimated cost \$75,000 per 2004 Recreation and Open Space Master Plan  
Possible \$100,000 project in 2009 costs
  
- Albany Bulb (Albany Waterfront park) Safety Enhancement
  - Prepare assessment and plan for removal rebar. Remove rebar.
  - Guideline No. A-13 in Eastshore State Park plan “Develop and implement a program for the removal of safety hazards associated with construction debris on the surface of the Neck and Bulb...”
  - First step toward improving safety of Albany controlled land making more useful to all age groups
  - Will help leverage additional funding for removal of additional hazards, i.e., concrete and rubble
  - Estimated cost \$95,000
  
- Cove and “Triangle” improvements
  - Install new landscaping, redesign seating area, install one or two picnic benches; relocate bike racks in the area of the Cove and “triangle” (mounded land area at the intersection of the access road (lower road) and upper trail path.
  - Intended to enhance the vista and visual experience; current condition clutters the vista (create sense of place: an oasis on the Waterfront)
  - Estimated cost \$50,000 per City staff

Note: Additional handouts that may further describe projects and individual WF Committee recommendations to be distributed at Joint Meeting of April 27.

## Summary of Recommendations from the 2004 Parks, Recreation, and Open Space Master Plan

---

**Table 1:** Recommendations from the Plan for improvements on property **not** currently owned by the City of Albany

| <b>Recommendation</b>                        | <b>Brief Description</b>   | <b>Comments</b>   |
|--|--|---|
| Pierce Street Park                           | Develop a neighborhood park. Other possibilities are bike trail linkage, community gardens, and natural open space.                | Property is currently owned by Caltrans. Negotiations for its purchase continue.  |
| East Shore State Parks                       | Transfer the “Bulb” to State of Ca., work with EBRPD to implement Master Plan, explore alternatives to secure waterfront property. | Property owned by State of Ca., managed by EBRPD.   |
| Vista Neighborhood Park                      | New playground, ADA improvements and new steps to improve access   | Site may not be available for redevelopment and it is not known how long the existing lease is with the current occupant.   |
| Veteran’s Memorial Building                  | Purchase and renovate the building for recreational purposes.  | The City updated the cost for renovation in 2008. Total cost is \$10.2 million. After more community meetings were held and the community was surveyed, the community appeared to have a lukewarm response to the project |
| UC Village Gill Tract                        | Purchase if possible, or work with UC Village to provide recreation facilities/programs  | Property owned by the University of California.   |
| Albany School District Facilities in general | Work with the District to develop joint use agreement  | Staff has drafted a Joint Use Agreement. The City Attorney is currently reviewing the draft. Staff hopes to present the draft to the Commission for their consideration by June 2009.                                     |



**Table 2:** Additional Recommendations

| <b>Recommendation</b>    | <b>Brief Description</b>   | <b>Comments</b>   |
|--------------------------|--|---|
| Senior Center            | Upgrade building to include new roof, and minor rehabilitation                               | \$49k from Prop 40 grant funds have been approved for new roof and HVAC system. Currently, funds frozen by State.   |
| Key Route Median         | Redevelop into a linear park equipped with trail, landscaping, and site amenities            |   |
| Ohlone Greenway          | Specialized trail surfaces, game courts, native plantings, community garden, play structures | Although BART has hired Gates & Assoc to complete plans for the bike/pedestrian path, trees, and landscaping per Albany's preferences, there are no plans currently to develop a Master Plan for the Greenway. The Master Plan would include the mentioned recommendations for the game courts, community garden, recreation structures, etc. |
| Waterfront Trail Park    | Upgrade area with restrooms, picnic tables, drinking fountain                                |   |
| Creekside Park           | Add signage, benches, vegetation management, possible bridge, trail connectors,              |   |
| Cerrito Creek Bay Trails | Participate with other agencies to develop links between El Cerrito Plaza & the Bay Trail    |   |
| Bay Trail                | Participate with other agencies to complete segments of regional trail                       |   |
| Albany Hill Trails       | Complete a system of trail connections to Albany Hill Park                                   |   |
| Albany Hill Park         | Explore options to acquire land contiguous to the park. Implement 1991 Master Plan.          |   |

|                              |   |  |
|------------------------------|---|--|
| Catherine's Walk             | Prepare plan for site to include safety improvements and maintenance plan                   | Some maintenance and safety improvements have been made.   |
| Cerrito Creek Restoration    | Coordinate planning and improvement with interested/imparted parties                        | Friends of Five Creeks is the primary group that takes care of El Cerrito Creek for the City of Albany. Their efforts are ongoing. |
| Codornices Creek Restoration | Complete plan to realign and landscape the creek corridor with the City of Berkeley and UC. | Staff can provide more information upon request. Project is ongoing.   |

**Table 3:** Completed Projects

| <b>Recommendation</b>     | <b>Brief Description</b>   | <b>Comments</b>             |
|---------------------------|--|-----------------------------|
| Dartmouth Tot Lot         | Playground replacement and repair  |                             |
| Ocean View Park           | Improvements to sports field, picnic area, new playground equipment and community garden.      |                             |
| Terrace Park              | New restrooms, turf, picnic area, landscaping, path, basketball resurface, park art, etc       |                             |
| Memorial Park             | Ball field improvements, irrigation, picnic area, landscaping, signage, waste receptacles, etc |                             |
| Albany Preschool Retrofit | Retrofit of building for seismic improvements  | To be completed August 2009 |
| Community Center          | Wood floors refurbished and new landscaping.   |                             |

## Parks and Recreation Commission’s Proposed Measure WW Project List

Each Parks and Recreation Commissioner may select up to 5 projects and send the list to staff filling out as many of the columns of this document as possible. Staff will collate, remove duplicates, and fill out the rest of the columns as best they are able and present the collated list to the Commission. The Commission will discuss and rank projects at its next meeting.

**Recommended in Parks and Rec Master Plan** - does the project appear in the Master Plan. Please list page number.

**Meets which Master Plan Goal** - which Master Plan goal does the project meet?

**BRIEF description of merits** - As brief as possible a description of the merits of the project and why it should be considered at this time.

**Could possibly be funded by other sources** - are there other, perhaps easily available sources of funding for the project?

| Project Name                            | Recommended in Parks and Rec Master Plan | Meets which Master Plan Goal | BRIEF description of merits  | Could possibly be funded by other sources | Estimated cost   | Proposed by                       |
|---|--|------------------------------|--|---|--|-----------------------------------|
| Teen center computer and home-work area | yes                                      | 3.3                          | Expanded programming, enhanced services, services and underserved population |   | \$120,000 was the original quote for a second building | Christine Mullarkey               |
| Tot lot at Ohlone Greenway              | yes                                      | 3.4 & 5.1                    | Expanded recreation space for young children on the “other side” of Albany   |   | Up to \$60,000 depending on size                       | Christine Mullarkey<br>Nick Pilch |

| Project Name                      | Recommended in Parks and Rec Master Plan | Meets which Master Plan Goal | BRIEF description of merits  | Could possibly be funded by other sources                 | Estimated cost                                  | Proposed by  |
|-----------------------------------|--|------------------------------|--|---|---|--|
| Pierce Street park                | yes                                      | 1.4                          | <p>Large population that is underserved in terms of recreation space/park</p> <p>A great deal of input from public that this park is needed and should be completed for West Albany residents.</p> | Yes – some funds already allocated to this from Measure F | Up to the full amount                           | <p>Christine Mullarkey</p> <p>Kim Linden</p> <p>Nick Pilch</p> |
| Cerrito Creek Bay Trail Connector | yes                                      | 5                            | Complete Albany's portion from the El Cerrito border to Buchanan St.   | yes   | Up to the full amount                           | Nick Pilch   |
| Bathroom at Waterfront            | yes                                      | 1                            | Have heard many members of public call for this. School Board expressed interest in this   |   |   | Nick Pilch   |
| Community Gardens                 | yes                                      | 2                            | Called for by members of community – appears to be a need for them. (Nick) Increasing funding/infrastructure for city-community garden program   |   | Depends on size, location, and area preparation | <p>Nick Pilch</p> <p>Kim Linden</p>                            |

| Project Name                      | Recommended in Parks and Rec Master Plan            | Meets which Master Plan Goal | BRIEF description of merits  | Could possibly be funded by other sources | Estimated cost  | Proposed by                      |
|-----------------------------------|---|------------------------------|--|---|---|----------------------------------|
|                                   |   |                              | with collaboration from schools is in the Master Plan, and includes potential for a program at the Gill Tract as well at all other parks. The Oceanview Community Garden has been successful, and the Teen Center gardening program should be supported and expanded, linked to other youth efforts in the city/schools. (Kim) |   | needed  |                                  |
| Senior Center Expansion           | Yes, in that it increases indoor recreational space | 3                            | Expansion of the current Senior Center with additional rooms, office space and storage.  |   | Up to a designated amount.                              | Joe Como                         |
| Upgrade the Waterfront Trail Park | yes   | 4                            | Drinking fountain, landscaping, replace posts/fencing, cove enhancements, etc. (See WFC attachment)  |   | \$75,000 from 2004 Master Plan, \$100,000 in 2009 costs | Joe Como<br>Waterfront Committee |

| Project Name                        | Recommended in Parks and Rec Master Plan | Meets which Master Plan Goal | BRIEF description of merits   | Could possibly be funded by other sources        | Estimated cost            | Proposed by |
|-------------------------------------|--|------------------------------|---|--|---------------------------|-------------|
| Complete segments of the Bay trail. | Yes                                      | 4,5                          | Portions of the trail are currently owned by Golden Gate Fields. EBRPD has tried to negotiate with Golden Gate Fields.  | EBRPD may have funds earmarked for the Bay Trail |                           | Joe Como    |
| Permanent Stage at Memorial Park    |  | 2                            | Install a permanent stage at Memorial Park for the many special events/performances at the park i.e. July 4th, Arts & Music Festival, Concert Series, etc.  |  | \$16,000                  | Staff       |
| Ohlone Greenway Improvements        | Yes                                      | 6                            | Irrigation; specialized trail surfaces for bicycles, running, & walking; game community garden, native plantings, play structures, Tree demonstration area, Bay friendly garden demonstration areaReplace current sidewalk. Master plan needs to be completed, 75% completed. |  | Up to a designated amount | Staff       |

| <b>Project Name</b>                          | <b>Recommended in Parks and Rec Master Plan</b> | <b>Meets which Master Plan Goal</b> | <b>BRIEF description of merits</b>   | <b>Could possibly be funded by other sources</b> | <b>Estimated cost</b> | <b>Proposed by</b>   |
|--|---|-------------------------------------|--|--|-----------------------|----------------------|
| Albany Bulb                                  |   | 1,4                                 | Prepare assessment plan for removal or rebar. Remove rebar. (See WFC attachment)                             |  | \$95,000              | Waterfront Committee |
| Cove and "Triangle" improvements at the Bulb |   | 1,4                                 | Install landscaping, redesign seating area, 1-2 picnic tables, relocate bike racks, etc (See WFC attachment) |  | \$50,000              | Waterfront Committee |

Possible attributes/considerations for ranking - immediacy of need, no other funding sources exist, project on hold for too long, perfect time for this project, etc.