

CITY OF ALBANY

PAVEMENT REHABILITATION PROJECT

FOR

ADAMS STREET: SOLANO AVE TO BUCHANAN ST

PROJECT NO. C20-47

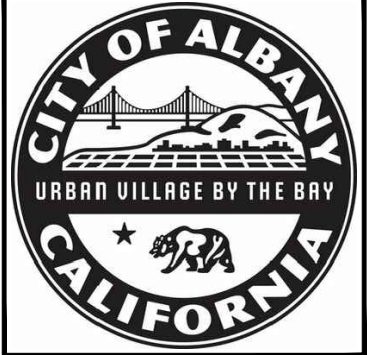

City of Albany
Maintenance Center
540 Cleveland Avenue
Albany, CA 94706
(510) 524-9543



GENERAL NOTES:

1. ALL MATERIALS AND METHODS OF CONSTRUCTION SHALL BE IN ACCORDANCE WITH THE LATEST CITY OF ALBANY STANDARD PLANS AND SPECIFICATIONS & SUBJECT TO INSPECTION BY THE CITY OF ALBANY.
- 2.
3. AT LEAST ONE SET OF APPROVED PLANS AND APPROVED PERMITS SHALL BE ON THE SITE AT ALL TIMES FOR INSPECTION.
4. IT SHALL BE THE CONTRACTOR'S RESPONSIBILITY TO ASCERTAIN THE EXISTENCE OF ANY AND ALL UNDERGROUND FACILITIES, WHICH MAY BE SUBJECT TO DAMAGE BY REASON OF HIS OPERATIONS. THE CONTRACTOR SHALL NOTIFY UNDERGROUND SERVICE ALERT (USA) AT 811, SEVENTY-TWO (72) HOURS PRIOR TO ANY EXCAVATION. WORK SHALL START WITHIN 5 DAYS AFTER THE ISSUANCE OF A USA INQUIRY IDENTIFICATION NUMBER.
5. CONTACTING USA DOES NOT RELIEVE THE CONTRACTOR FROM HIS RESPONSIBILITY TO DETERMINE LOCATION AND DEPTH OF BURIED UTILITIES OR REPAIR OF BURIED UTILITIES DAMAGED BY HIS OPERATION.
6. NOISE-PRODUCING CONSTRUCTION OPERATIONS SHALL BE LIMITED TO WEEKDAYS (MONDAY THROUGH FRIDAY) EXCEPT CITY HOLIDAYS AND FROM THE HOURS OF 8:00 A.M. TO 5:00 P.M. ALL EQUIPMENT SHALL BE ADEQUATELY MUFFLED AND MAINTAINED. NO CHANGES SHALL BE ALLOWED WITHOUT PRIOR WRITTEN CONSENT OF THE CITY. ALL REQUESTS FOR CHANGES MUST BE MADE A MINIMUM OF 72 HOURS PRIOR TO THE PROPOSED CHANGE.
7. IT SHALL BE UNDERSTOOD THAT THE TERM "CITY ENGINEER" AS USED HEREIN IS THE CITY ENGINEER OF THE CITY OF ALBANY OR HIS AUTHORIZED REPRESENTATIVE.
8. THE CONSTRUCTION CONTRACTOR AGREES, THAT IN ACCORDANCE WITH GENERALLY ACCEPTED CONSTRUCTION PRACTICES, TO ASSUME SOLE AND COMPLETE RESPONSIBILITY FOR THE JOB SITE CONDITIONS DURING THE COURSE OF CONSTRUCTION OF THE PROJECT, INCLUDING SAFETY OF ALL PERSONS AND PROPERTY; THAT THIS REQUIREMENT SHALL BE MADE TO APPLY CONTINUOUSLY AND NOT BE LIMITED TO NORMAL WORKING HOURS.
9. THE CONTRACTOR SHALL NOT DISTURB OR DESTROY ANY PERMANENT SURVEY POINTS WITHOUT THE CONSENT OF THE CITY ENGINEER FOR THE CITY OF ALBANY. ANY PERMANENT MONUMENTS OR POINTS DISTURBED OR DESTROYED SHALL BE REPLACED BY A REGISTERED CIVIL ENGINEER OR LICENSED SURVEYOR AT THE CONTRACTOR'S EXPENSE.
10. FOR AREAS OF REMOVE & REPLACE HMA, THE CONTRACTOR SHALL ONLY REMOVE MATERIAL QUANTITIES THAT CAN BE REPLACED DURING THE SAME WORK PERIOD.
11. THE CONTRACTOR SHALL CONTROL DUST BY WATERING EXPOSED SURFACES AS NEEDED. INCREASED WATERING SHALL BE REQUIRED WHEN WIND SPEEDS EXCEED 10 MPH OR WHEN DIRECTED BY THE CITY.
12. NO PERSON SHALL, WHEN HAULING ANY EARTH, SAND, GRAVEL, STONE, DEBRIS, OR ANY OTHER SUBSTANCE OVER ANY PUBLIC STREETS OR OTHER PUBLIC PLACE, ALLOW MATERIAL TO BLOW OR SPILL OVER AND UPON SAID PUBLIC OR ADJACENT PRIVATE PROPERTY.
13. MUD TRACKED ONTO STREETS OR ADJACENT PROPERTIES SHALL BE REMOVED IMMEDIATELY. STREET SHALL BE SWEEPED WITH A POWER SWEEPER (NOT PRESSURE WASHED) AS DIRECTED BY THE CITY.
14. THE CONTRACTOR SHALL SWEEP STREETS DAILY, OR AS NECESSARY, WITH WATER SWEEPERS IF VISIBLE SOIL MATERIAL IS CARRIED ONTO ADJACENT PUBLIC STREETS.
15. CONTRACTOR IS RESPONSIBLE FOR REPLACING ALL TRAFFIC STRIPING, PAVEMENT MARKINGS, AND RED CURB PAINT DAMAGED OR OBLITERATED WITHIN LIMITS OF WORK. TRAFFIC STRIPING, PAVEMENT MARKINGS, AND RED CURB PAINT SHALL MATCH EXISTING UNLESS OTHERWISE SHOWN ON PLANS OR DIRECTED BY THE CITY. ALL STRIPING SHALL BE THERMOPLASTIC UNLESS OTHERWISE INDICATED.
16. THE CONTRACTOR SHALL PROVIDE FOR CONTINUOUS INGRESS AND EGRESS TO ALL PRIVATE PROPERTY ADJACENT TO THE WORK THROUGHOUT THE PERIOD OF CONSTRUCTION UNLESS OTHERWISE SHOWN.
17. THE CONTRACTOR SHALL BE RESPONSIBLE FOR ANY DAMAGES TO THE SITE OR THE SURROUNDING AREA AS A RESULT OF THE CONTRACTOR'S WORK OR OPERATIONS. EXISTING FACILITIES THAT ARE DAMAGED OR DISPLACED BY THE CONTRACTOR SHALL BE REPLACED AT THE CONTRACTOR'S EXPENSE.
18. CONTRACTOR SHALL ENSURE POSITIVE DRAINAGE TO THE EXISTING DRAINAGE FACILITIES FROM THE NEW PAVEMENT AREAS.
19. CONTRACTOR SHALL DISPOSE OF ALL PROJECT WASTE IN A LEGAL MANNER.
20. OVERNIGHT STORAGE OF CONSTRUCTION MATERIALS AND/OR EQUIPMENT IS NOT PERMITTED IN THE PUBLIC RIGHT-OF-WAY UNLESS OTHERWISE APPROVED IN WRITING BY THE CITY OF ALBANY.

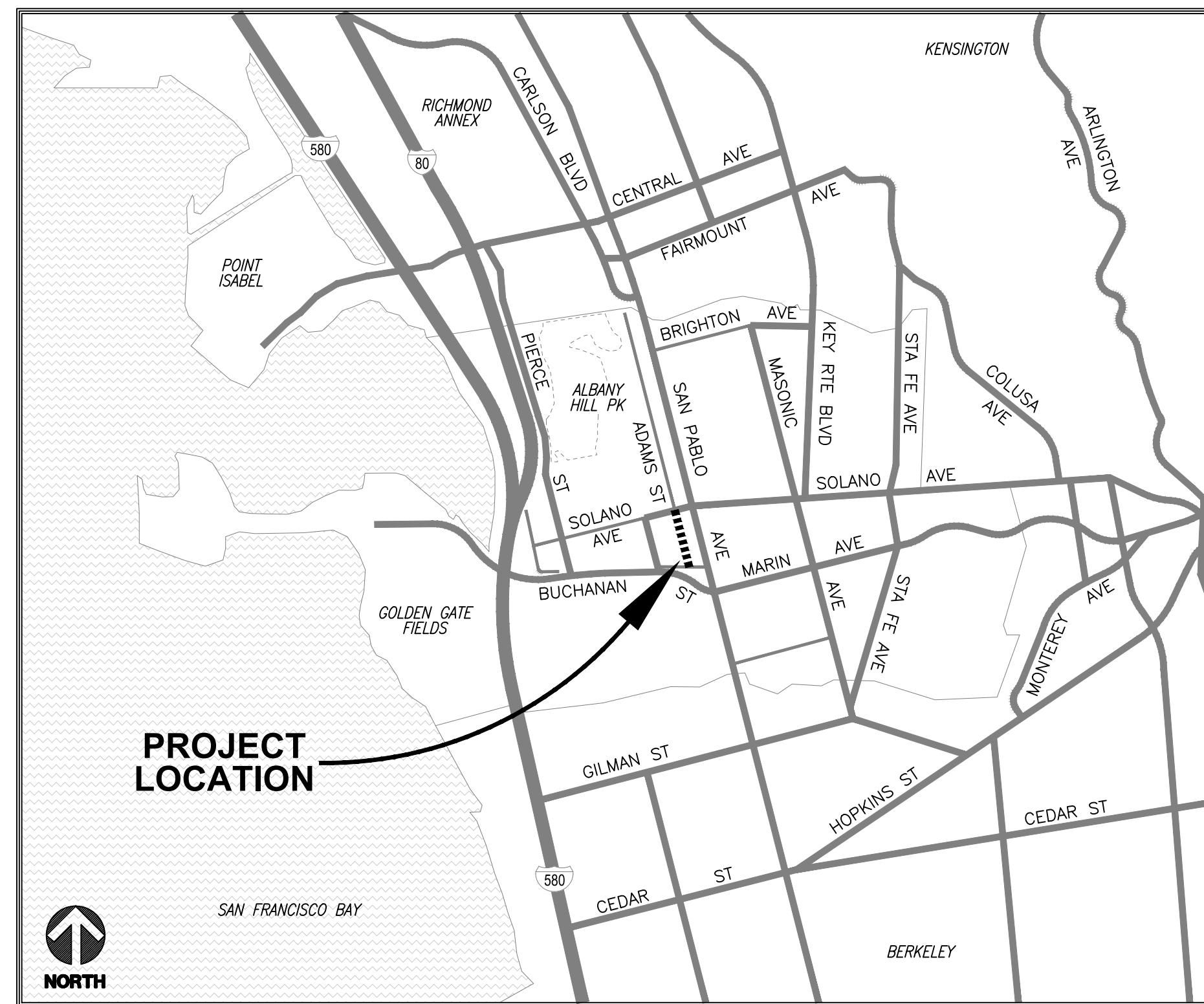

CITY OF ALBANY: LOCATION MAP
NOT TO SCALE

SHEET INDEX		
SHEET	SHEET #	SHEET DESCRIPTION
T-1	1	TITLE SHEET
C-1	2	SITE PLAN
C-2	3	ENLARGEMENT A: CURB RAMPS @ BUCHANAN STREET
C-3	4	ENLARGEMENT B: CURB RAMPS @ SOLANO AVENUE
C-4	5	DETAILS
SHEETS 1 - 12		ALBANY ACTIVE TRANSPORTATION PLAN <i>(prepared by FEHR & PIERS)</i>

LEGEND

- TYPICAL SECTION NO. 1:
4-1/2" HMA OVER 9" F.D.R.
- REMOVE & REPLACE 6" HMA
- REMOVE & REPLACE PCC
SIDEWALK, CURB & GUTTER
- DETECTABLE WARNING SURFACE
- 7-1/2" PCC PAVEMENT
- TEMPORARY PATCHING PRIOR
TO PAVEMENT REHABILITATION
- BACKFILL W/TOPSOIL & REGRADE
- INTEGRAL CURB TYPE A3
- ELECTRICAL
- GAS
- STORM DRAIN
- SANITARY SEWER
- WATER MAIN

SYMBOLS & ABBREVIATIONS

- B# BORE LOCATION
- ⊙ S SANITARY SEWER MANHOLE
- ⊙ D STORM DRAIN MANHOLE
- ⊙ T TELECOM MANHOLE
- ⊙ MW MONITORING WELL
- U.P. UTILITY POLE
- S.C.O. SEWER CLEANOUT
- ⊗ LIGHT STANDARD
- ⊗ WATER VALVE
- WM WATER METER
- ⊙-F FIRE HYDRANT
- BRPM BLUE REFLECTIVE PAVEMENT MARKER
- C.I. CURB INLET
- J.B. STORM DRAIN JUNCTION BOX
- ELEC ELECTRICAL
- PACBELL TELECOMMUNICATIONS
- PG&E PACIFIC GAS & ELECTRIC
- TV TELECOMMUNICATIONS
- WM WATER METER
- UTIL. UNKNOWN UTILITY

TRAFFIC CONTROL NOTES:

1. TRAFFIC CONTROL DURING CONSTRUCTION SHALL BE IN ACCORDANCE WITH THE CURRENT EDITION OF "TRAFFIC CONTROLS IN CONSTRUCTION AND MAINTENANCE WORK ZONES" BY THE U.S. DEPARTMENT OF TRANSPORTATION.
2. THE CONTRACTOR SHALL PROVIDE, AT ALL TIMES, LIGHTS, SIGNS, BARRICADES, CONES, FLAG MEN OR OTHER DEVICES NECESSARY TO PROVIDE FOR PUBLIC SAFETY & TO MAINTAIN TRAFFIC CONTROLS.
3. THE CONTRACTOR SHALL NOTIFY, IN WRITING, ANY PROPERTY/BUSINESS OWNERS OF IMPENDING DETOURS OR LANE CLOSURES THAT MAY IMPACT THEIR PROPERTY AND/OR BUSINESS. THE WRITTEN NOTICE WILL BE HAND DELIVERED THREE (3) BUSINESS DAYS PRIOR TO IMPLEMENTING THE DETOUR AND/OR LANE CLOSURE. THE PERMITTEE SHALL SUBMIT TO THE CITY PROOF THAT NOTICE WAS GIVEN AT LEAST TWO (2) BUSINESS DAYS PRIOR TO THE START OF WORK.
4. TRAFFIC CONTROL DURING CONSTRUCTION SHALL BE THE CONTRACTOR'S RESPONSIBILITY. ALL TRAFFIC CONTROL AND DEVICES SHALL BE IN ACCORDANCE WITH THE LATEST EDITION OF THE "MANUAL OF UNIFORM TRAFFIC CONTROL DEVICES" (MUTCD) ISSUED BY THE STATE OF CALIFORNIA DEPARTMENT OF TRANSPORTATION.
5. THE CONTRACTOR SHALL SUBMIT TRAFFIC CONTROL, PEDESTRIAN HANDLING, & SIGNAGE PLAN TO THE CITY AT THE PRE-CONSTRUCTION MEETING.

CITY COUNCIL
NICK PILCH - MAYOR PEGGY MCQUAID - VICE MAYOR ROCHELLE NASON MICHAEL BARNES PETER MAASS
NICOLE ALAGUER - CITY MANAGER MARK HURLEY - PUBLIC WORKS DIRECTOR/CITY ENGINEER ROBERT GONZALES - CAPITAL IMPROVEMENT PROJECTS PROGRAM MANAGER

VERIFY SCALE
BAR REPRESENTS
1" ON ORIGINAL

Plans Prepared By:



Corporate Office:
3485 Sacramento Drive, Suite A
San Luis Obispo, CA 93401
805.781.2265

TITLE SHEET
PAVEMENT REHABILITATION PROJECT
CITY OF ALBANY
ADAMS STREET: SOLANO AVENUE TO BUCHANAN STREET

Submittal / Revision:	
▲	
▲	
▲	
▲	
▲	
▲	

Job No: 190368
Drawn By: MPW
Checked By: JLR
Date: MAR 2020

Sheet Number:
T-1
1 of 5

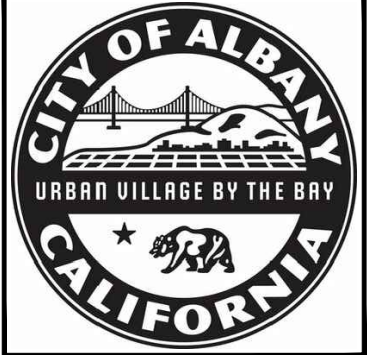

City of Albany
Maintenance Center

540 Cleveland Avenue
Albany, CA 94706
(510) 524-9543



SITE PLAN
PAVEMENT REHABILITATION PROJECT
CITY OF ALBANY
ADAMS STREET: SOLANO AVENUE TO BUCHANAN STREET

Submital / Revision:

Job No: 190368
 Drawn By: MPW
 Checked By: JLR
 Date: MAR 2020

Sheet Number:
C-1
 2 of 5

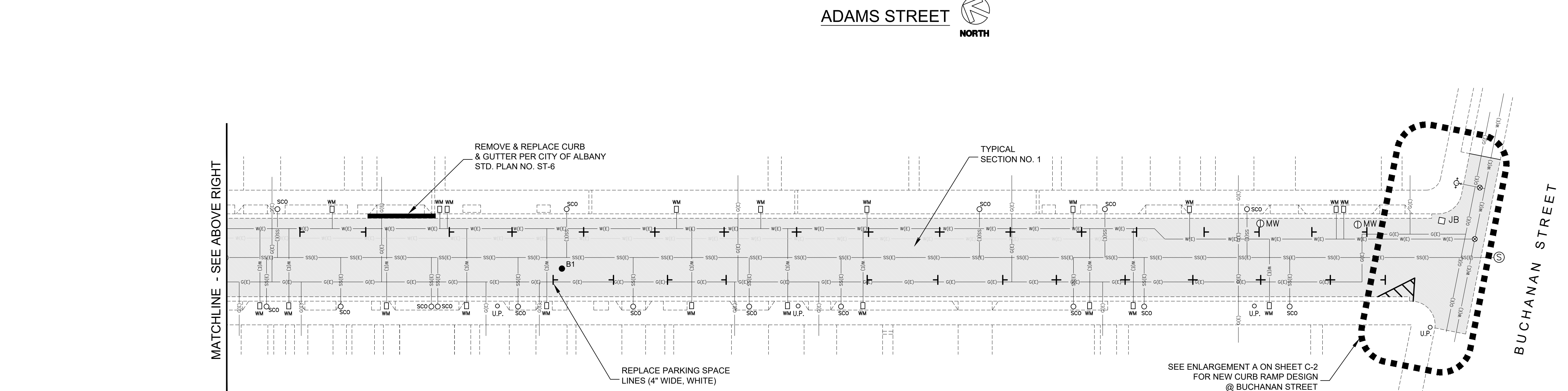
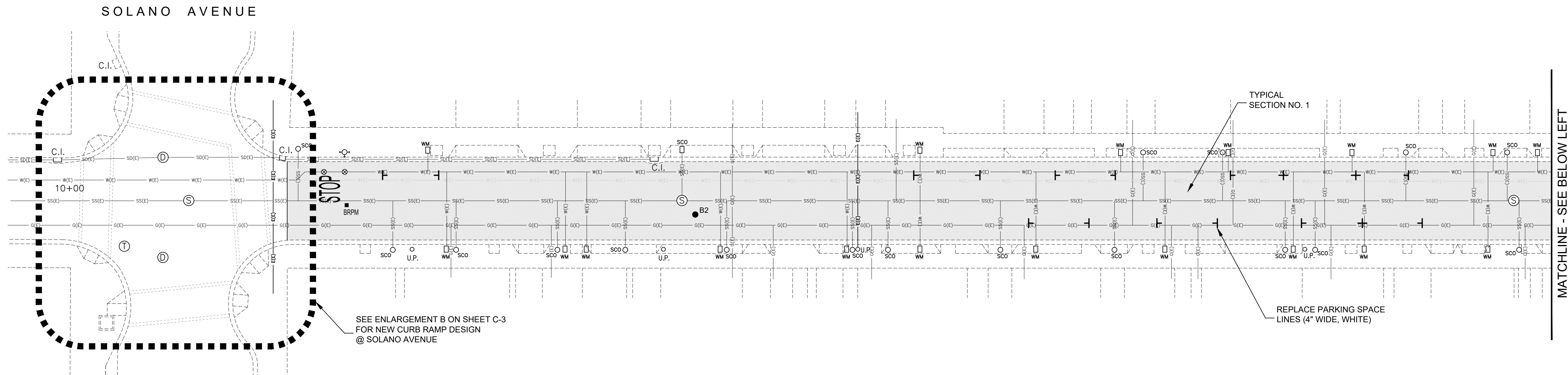

- UTILITY NOTES:**
- WHERE 4" WATER LINE CROSSES OVER SEWER LATERALS DEPTH IS REPORTED TO BE REDUCED TO APPROX. 24" - 28" W/A 6" CONCRETE CAP APPROX. 15" TO 18" BELOW PAVEMENT SURFACE.
 - 2" GAS LINE DEPTH IS UNVERIFIED BUT REPORTED TO BE GREATER THAN 30".
 - WATER SERVICE LATERALS @ THE WEST SIDE OF THE ROAD MAY BE RELATIVELY SHALLOW AS REPORTED BY EBMUD.
 - ALL UTILITY LINES SHOWN ON PLAN ARE APPROXIMATE. OTHER UTILITY LINES NOT SHOWN ON THE PLANS MAY EXIST. LOCATIONS OF ALL UTILITY LINES SHALL BE VERIFIED BY THE CONTRACTOR BY CALLING U.S.A. IN ADVANCE OF THE WORK. CONTRACTOR SHALL REPORT POT HOLE UTILITIES & REPORT ANY CONFLICTS TO CITY PRIOR TO ANY EXCAVATION, DEMOLITION OR TRENCHING.

- CONSTRUCTION SEQUENCE:**
- PULVERIZE HMA & BASE MAT'L TO A DEPTH OF 13.5"
 - REMOVE & DISPOSE OF PULVERIZED MAT'L TO A DEPTH OF 4-1/2"
 - CEMENT SOIL TREATMENT PER APPROVED MIX DESIGN TO A DEPTH OF 9"; GRADE TO MAINTAIN EX. CROSS-SLOPE.
 - PLACE 2-1/2" HMA BASE COURSE.
 - PLACE 2" HMA SURFACE COURSE.

BORING LOG

NO.	HMA	AB	PAVING FABRIC
B1	3-1/2"	6-1/2"	YES
B2	4-3/4"	5-1/2"	NO

CORING DATA IS FOR INFORMATION ONLY. EXIST. SECTION MAY VARY FROM SECTION(S) FOUND AT CORING LOCATION(S) SHOWN ABOVE. FABRIC MAY BE PRESENT IN SECTIONS EVEN IF NOT FOUND AT CORING LOCATION(S).

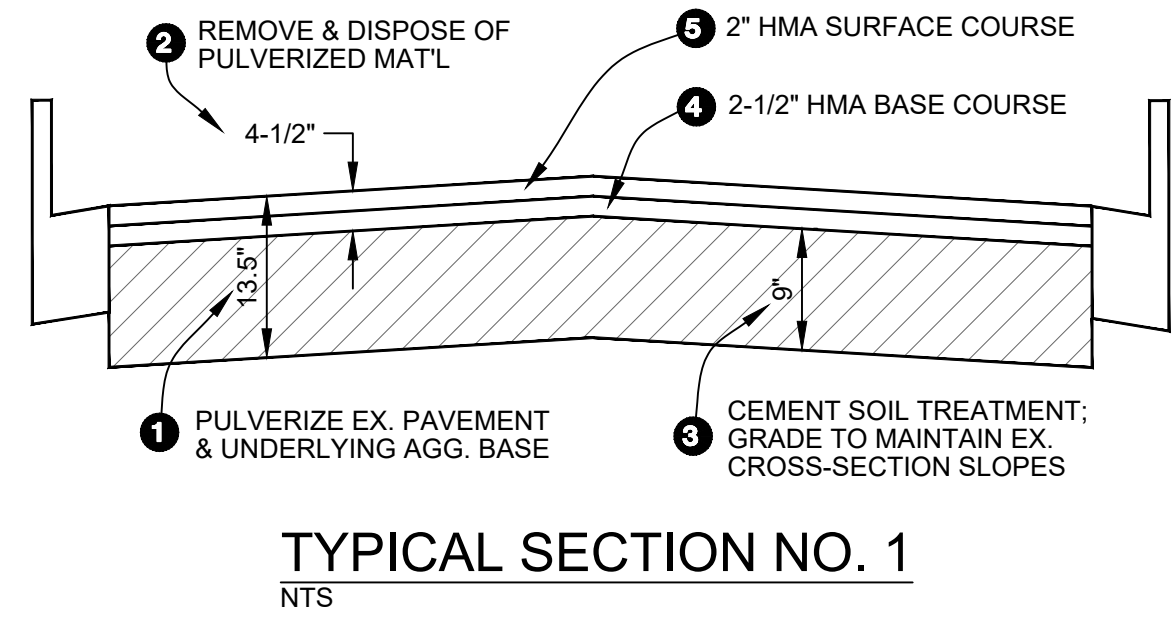
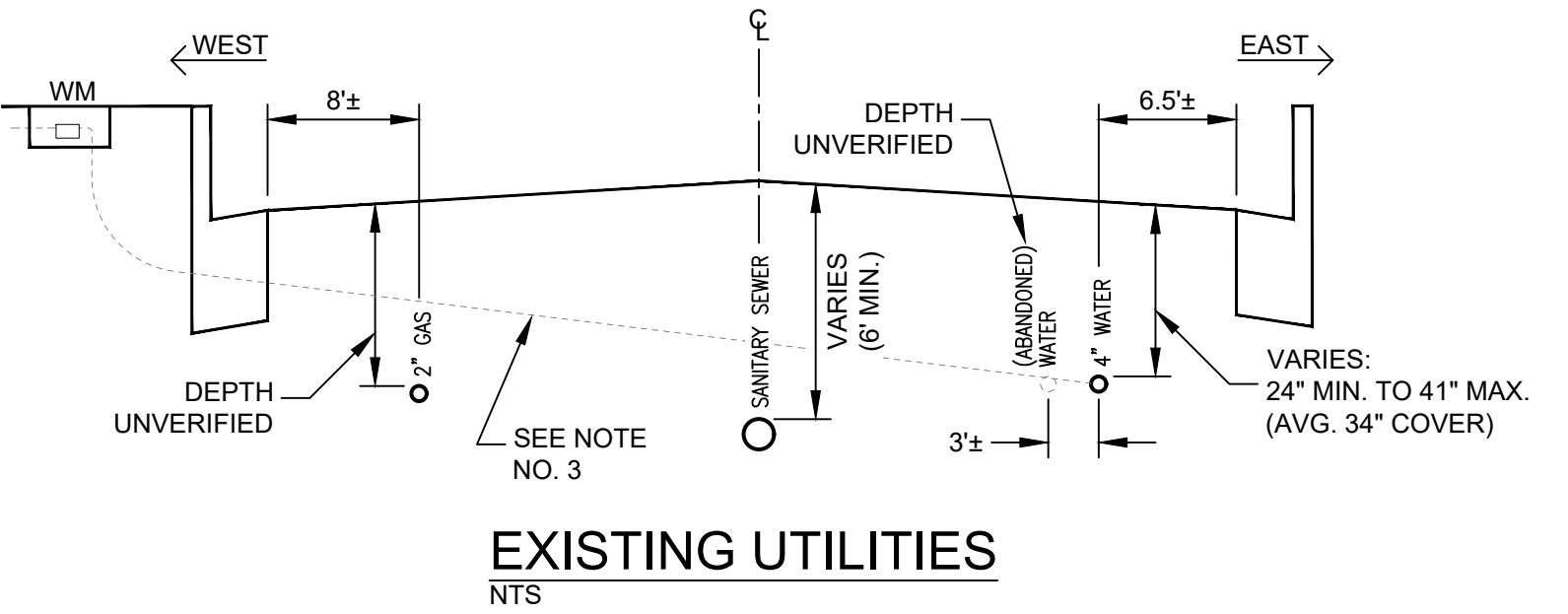
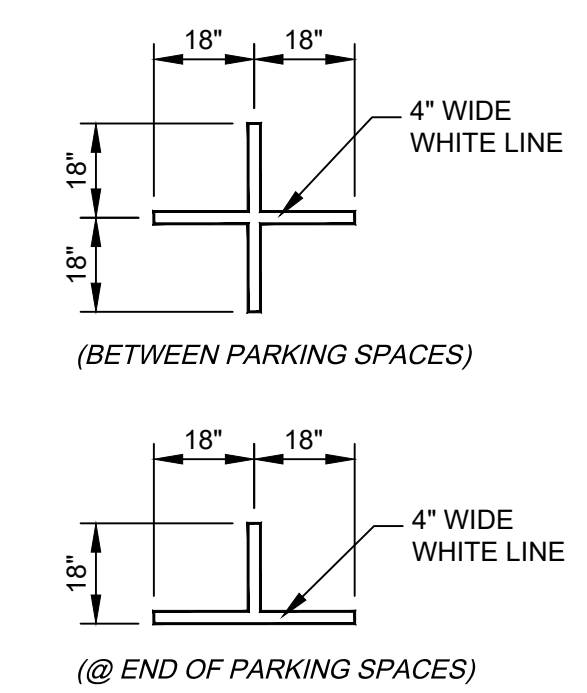

VERIFY SCALE
 BAR REPRESENTS
 1" ON ORIGINAL

Plans Prepared By:

Pavement Engineering Inc.
You can ride on our reputation
 Corporate Office:
 3485 Sacramento Drive, Suite A
 San Luis Obispo, CA 93401
 805.781.2265

Plot: 2: (Drawn) Date: 10/10/2020 10:00:00 AM
 Path: Z:\Users\j\OneDrive\Projects\City of Albany - Adams Street\Task_01\Drawings\190368-01_Site_Plan.dwg
 Plot Date: Sun 10/10/2020 at 14:13

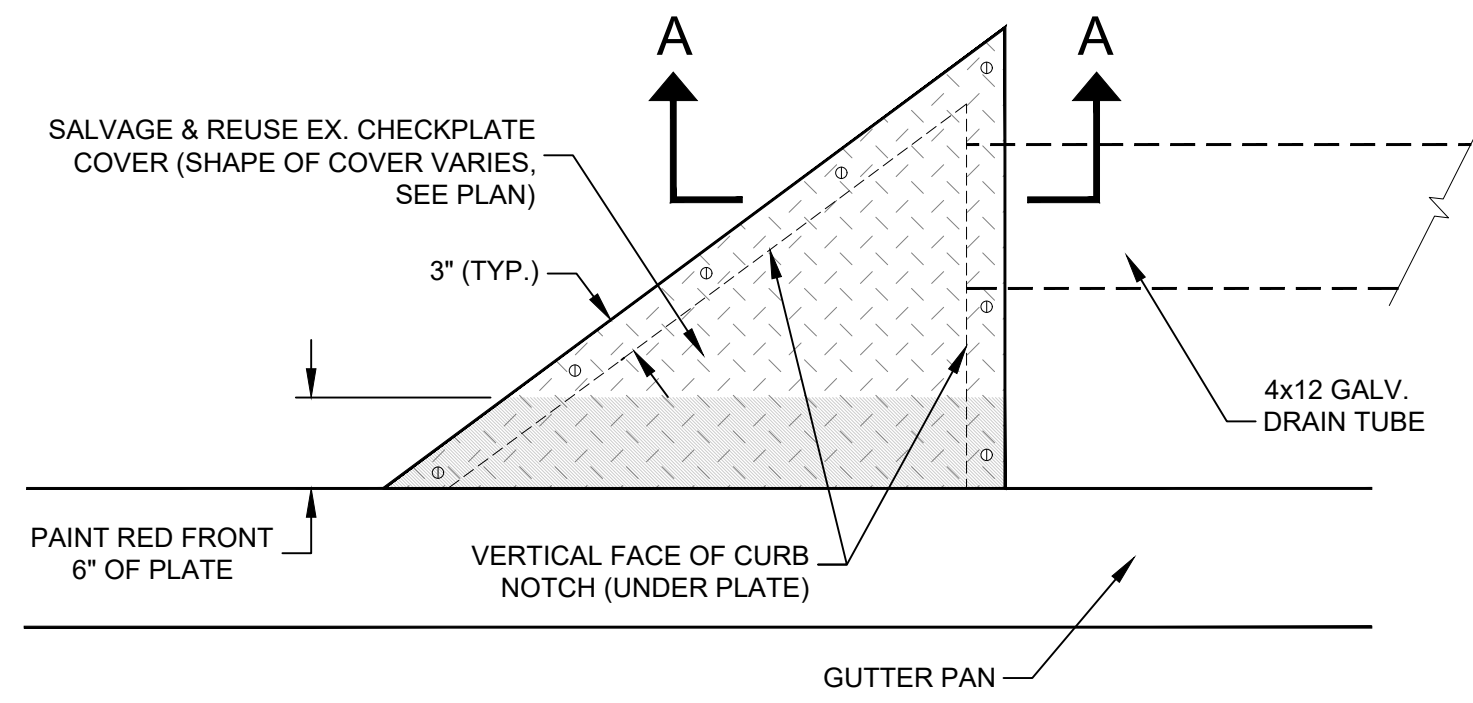

PLAN VIEW

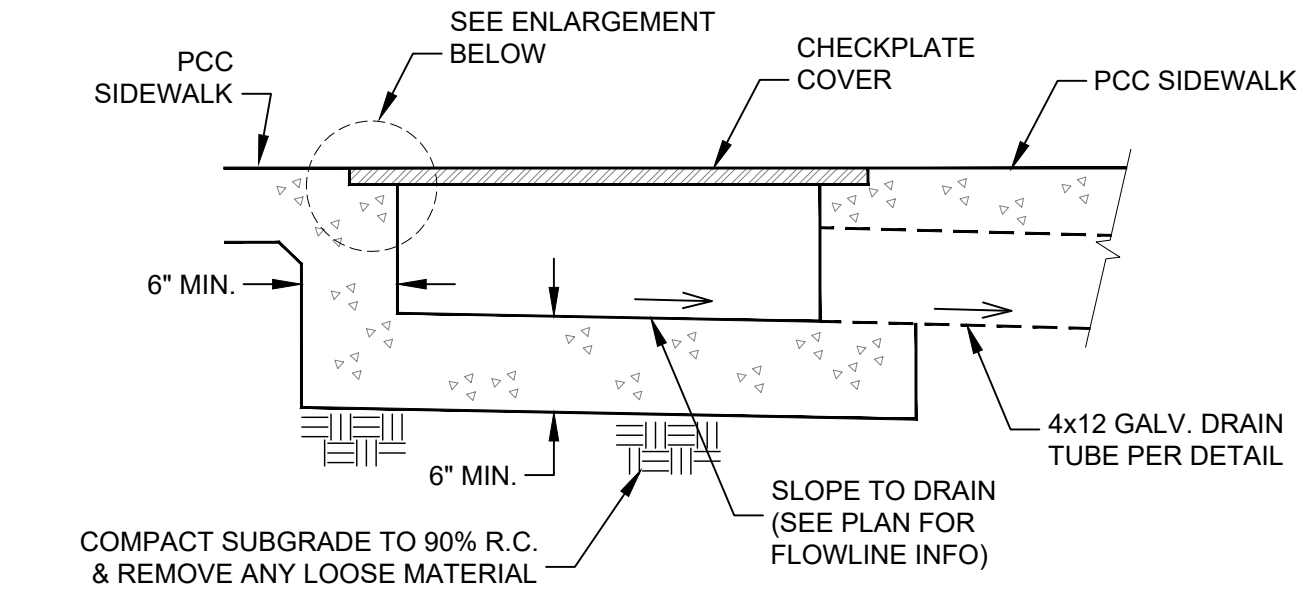

SECTION A-A

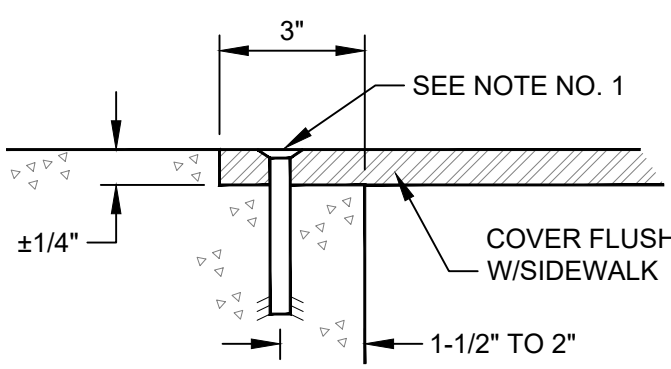

ENLARGEMENT

CURB NOTCH W/CHECKPLATE COVER DETAIL
NTS

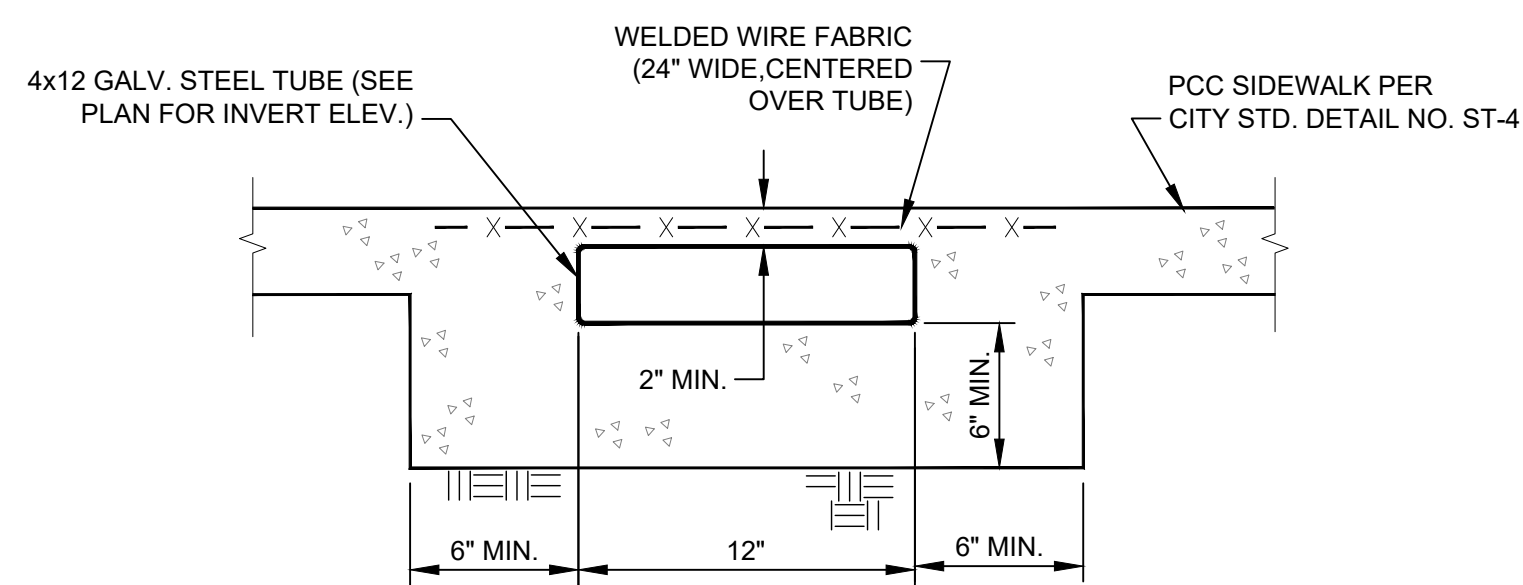

4x12 STEEL DRAIN TUBE UNDER SIDEWALK
NTS

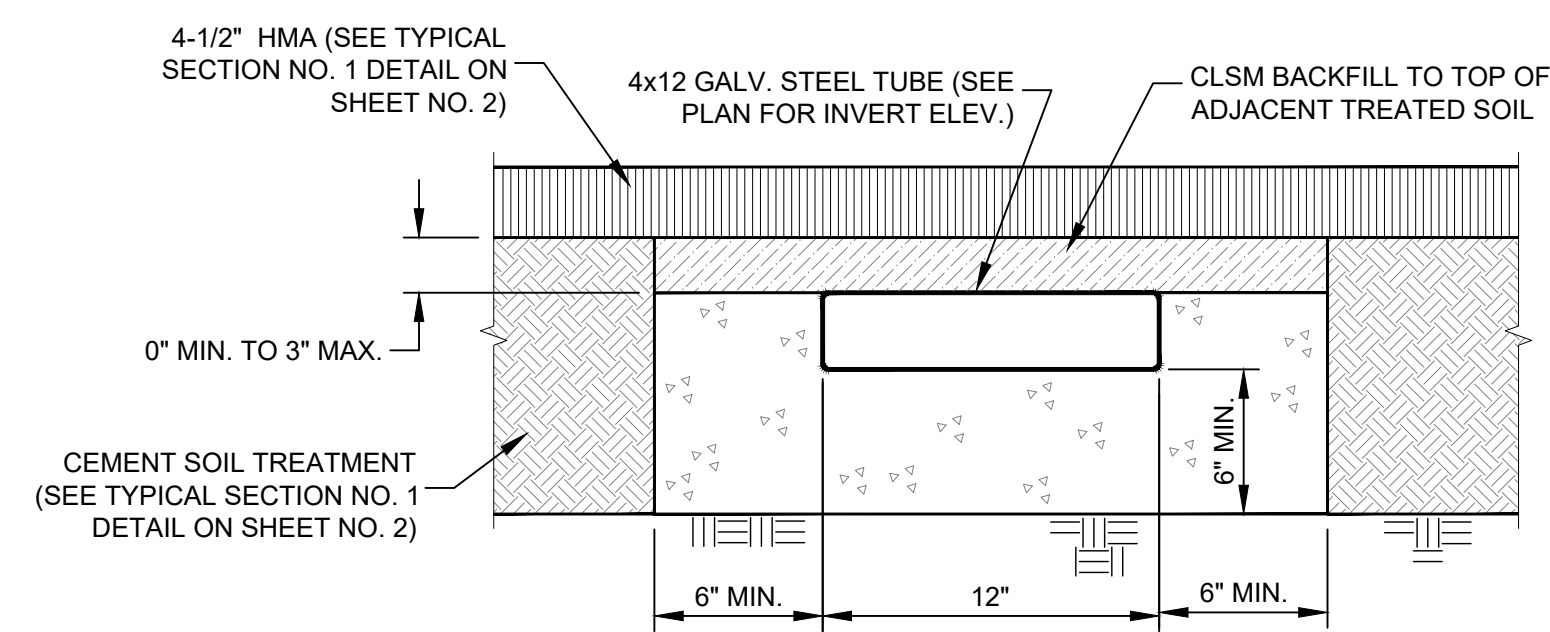

4x12 STEEL DRAIN TUBE UNDER PAVEMENT
NTS

NOTE:
ATTACH COVER TO CONC. SURFACE
W/3/8\"/>

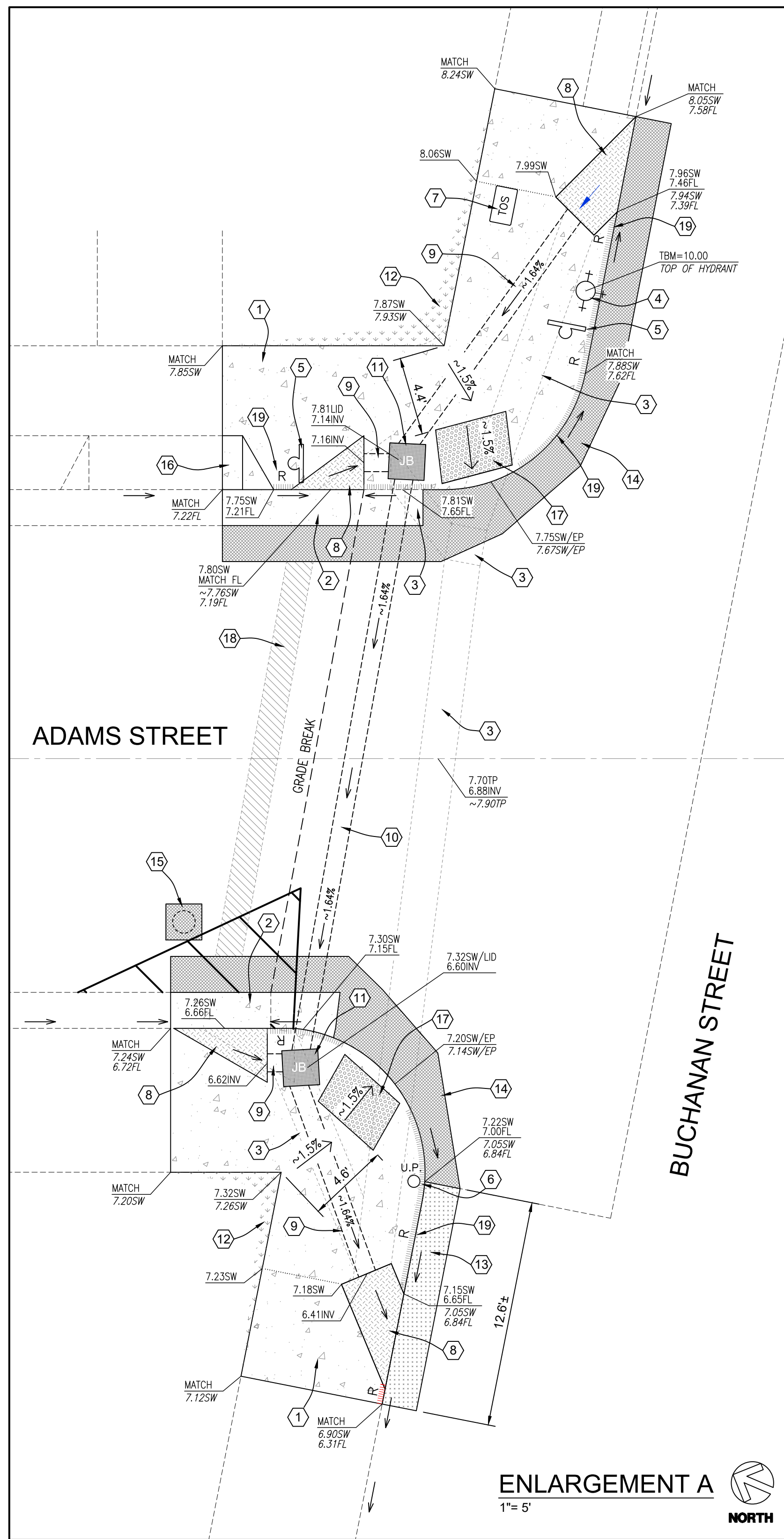

ENLARGEMENT A
1" = 5'

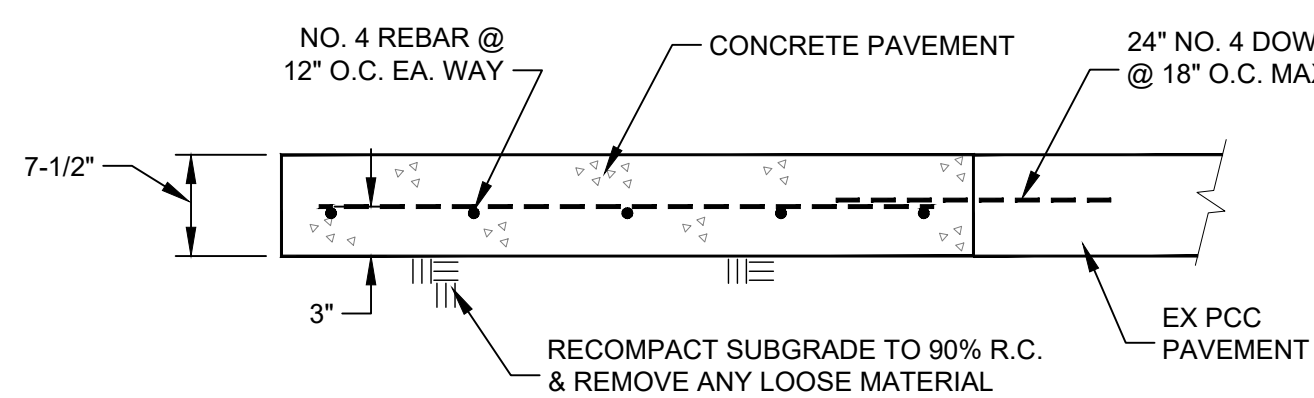

PCC PAVEMENT DETAIL
NTS

NOTE
SEE CITY OF ALBANY STD. PLAN #ST-8 FOR CONCRETE
CONSTRUCTION REQUIREMENTS.

VERIFY SCALE
BAR REPRESENTS
1" ON ORIGINAL

NOTES

- 1 REMOVE & REPLACE PCC SIDEWALK PER CITY OF ALBANY STD. PLAN # ST4 W/JOINTS PER STD. PLAN #ST5. REFER TO CITY STD. PLAN #ST8 FOR ADDITIONAL REQUIREMENTS REGARDING CONCRETE CONSTRUCTION.
- 2 REMOVE & REPLACE "TYPE A" PCC CURB & GUTTER PER CITY OF ALBANY STD. PLAN #ST1.
- 3 REMOVE JUNCTION BOX & CULVERT UNDER SIDEWALK & PAVEMENT. BACKFILL TRENCH ACROSS ROADWAY W/CLASS II AB & COMPACT TO 95% R.C.
- 4 PROTECT IN PLACE EX. FIRE HYDRANT.
- 5 EXISTING SIGN & POST - PROTECT IN PLACE IF POSSIBLE; IF NOT POSSIBLE, REMOVE & REINSTALL NEW POST PER CITY OF ALBANY STD. PLAN #ST11 & #ST12 (SALVAGE & REUSE EXISTING SIGN).
- 6 PROTECT IN PLACE EX. UTILITY POLE.
- 7 ALL UTILITY BOXES WITHIN LIMITS OF CONCRETE WORK TO BE REPLACED (MATCH EXISTING BOX SIZE). EXISTING BOXES & LIDS MAY BE REUSED ONLY IF FOUND TO BE IN SALVAGEABLE CONDITION BY THE CITY. ALL NEW LIDS TO BE LABELED TO MATCH EXISTING LIDS.
- 8 SALVAGE EXISTING CHECKPLATE COVER & RE-INSTALL IN NEW SIDEWALK SURFACE. ATTACH NPDES MEDALLION PER CITY OF ALBANY STD. PLAN #ST17 IN TOP OF CONCRETE CURB, 6" FROM EDGE OF RE-INSTALLED COVER.
- 9 INSTALL 4"x12" HIGH-STRENGTH STEEL DRAIN TUBE UNDER PCC SIDEWALK; SLOPE TO DRAIN AS SHOWN.
- 10 INSTALL 4"x12" HIGH STRENGTH STEEL DRAIN TUBE UNDER ROADWAY; SLOPE TO DRAIN AS SHOWN.
- 11 CONSTRUCT CHRISTY B24 JUNCTION BOX (OR EQUAL). TOP OF BOX TO BE FLUSH W/ADJACENT SIDEWALK SURFACE.
- 12 LANDSCAPE RESTORATION: CAREFULLY REMOVE TURF @ BACK OF SIDEWALK & PRESERVE DURING CONCRETE DEMOLITION & CONSTRUCTION. AFTER COMPLETION OF WORK, BACKFILL W/CLEAN, IMPORTED TOPSOIL & GRADE TO 2" BELOW TOP OF ADJACENT CONCRETE. LIGHTLY TAMP FILL SOIL TO PREVENT FUTURE SETTLEMENT (DO NOT OVER-COMPACT). REPLACE SALVAGED TURF OVER GRADED TOPSOIL. REPAIR OR REPLACE IN KIND ANY IRRIGATION UTILITIES @ BACK OF SIDEWALK WHICH ARE DAMAGED DURING CONSTRUCTION (IF APPLICABLE).
- 13 SAWCUT, REMOVE & REPLACE 7-1/2" PCC PAVEMENT AGAINST NEW SIDEWALK & CURB. DOWEL INTO EXISTING CONCRETE PAVEMENT W/ 24" LONG NO. 4 BARS SPACED @ 18" O.C. MAX.
- 14 SAWCUT & REMOVE PAVEMENT AS NEEDED TO SET FORMWORK FOR NEW CONCRETE FACILITIES. BACKFILL W/CLASS II AB OR PULVERIZED MATERIAL & COMPACT TO 95% R.C.
- 15 REMOVE CONCRETE PLUG IN ASPHALT PAVEMENT AREA. BACKFILL W/CLASS II AB & COMPACT TO 95% R.C.
- 16 SAWCUT, REMOVE & REPLACE PORTION OF PCC DRIVEWAY APPROACH PER CITY OF ALBANY STD. PLAN #ST7. REFER TO CITY STD. PLAN #ST8 FOR ADDITIONAL REQUIREMENTS REGARDING CONCRETE CONSTRUCTION.
- 17 INSTALL TRUNCATED DOMES PANEL(S) IN SIDEWALK, 6" MIN., 8" MAX. FROM EDGE OF SIDEWALK. SIDEWALK & PAVEMENT FLUSH FOR ENTIRE WIDTH OF PANEL.
- 18 ABANDONED C.M.P. CULVERT - SIZE, LENGTH & LOCATION UNKNOWN. CONTRACTOR TO FIELD VERIFY LOCATION & DEPTH. IF CULVERT IS LOCATED WITHIN 18" FROM SURFACE OF ROADWAY, REMOVE CULVERT & BACKFILL W/CLASS II AB.
- 19 PAINT TOP & FACE OF CURB RED (2 COATS MIN.). REPAINT RED CURBS IMMEDIATELY ADJACENT TO NEWLY PAINTED CURBS.

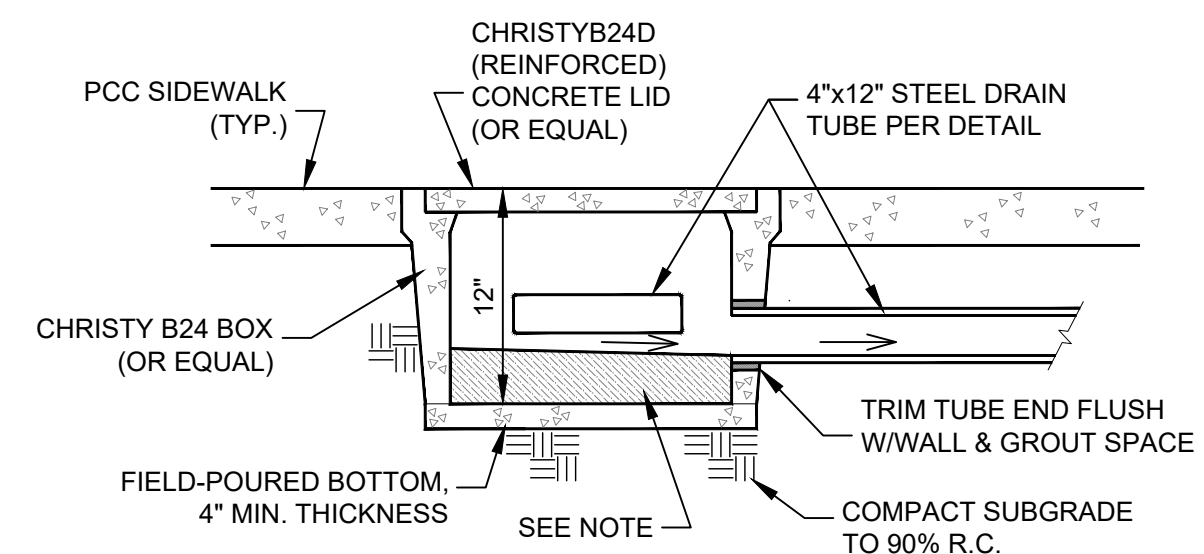

JUNCTION BOX DETAIL
NTS

NOTE:
FILL BOTTOM OF JUNCTION BOX W/CONCRETE TO INVERT OF
OUTLET DRAIN PIPE; SLOPE CONCRETE INFILL TO DRAIN.

Plans Prepared By:

Pavement Engineering Inc.
You can ride on our reputation

Corporate Office:
3485 Sacramento Drive, Suite A
San Luis Obispo, CA 93401
805.781.2265

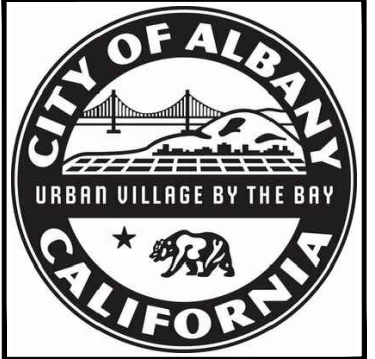

City of Albany
Maintenance Center

540 Cleveland Avenue
Albany, CA 94706
(510) 524-9543



ENLARGEMENT A
PAVEMENT REHABILITATION PROJECT
CITY OF ALBANY
ADAMS STREET: SOLANO AVENUE TO BUCHANAN STREET

Submital / Revision:

Job No: 190368
Drawn By: MPW
Checked By: JLR
Date: MAR 2020

Sheet Number:

C-2

3 of 5

NOTES

- 1 TYPE 'A' CURB RAMP PER CALTRANS STD. A88A.
- 2 TYPE 'G' CURB RAMP PER CALTRANS STD. A88A.
- 3 REMOVE & REPLACE PCC SIDEWALK PER CITY OF ALBANY STD. PLAN #ST4 W/JOINTS PER STD. PLAN #ST5. REFER TO CITY STD. PLAN #ST8 FOR ADDITIONAL REQUIREMENTS REGARDING CONCRETE CONSTRUCTION.
- 4 REMOVE & REPLACE "TYPE A" PCC CURB & GUTTER PER CITY OF ALBANY STD. PLAN #ST1. PAINT FACE & TOP OF CURB RED (2 COATS MIN.) - LIMITS OF RED PAINT TO BE DETERMINED BY CITY.
- 5 PROVIDE LEVEL LANDING @DOORWAY TO SHOP; 2% MAX. SLOPE IN ANY/ALL DIRECTIONS WITHIN LIMITS OF LANDING.
- 6 GRIND RAISED EDGE OF SIDEWALK PER CITY OF ALBANY STD. PLAN #ST16 (LENGTH OF GRIND ~12", DEPTH OF GRIND ~1").
- 7 NOT USED.
- 8 EXISTING TREE TO REMAIN. CONTRACTOR SHALL INSTALL TREE-PROTECTION MEASURES & SHALL USE METHODS OF WORK WHICH DO NOT DAMAGE OR DESTROY ANY OR ALL PARTS OF TREE. ANY LIVE TREE ROOTS LARGER THAN 2"Ø ENCOUNTERED WITHIN THE WORK ZONE SHALL NOT BE CUT WITHOUT PRIOR APPROVAL OF CITY.
- 9 ENLARGE TREE PLANTER AREA - REMOVE EXISTING SIDEWALK & UNDERLYING AGG. BASE, BACKFILL W/CLEAN, IMPORTED TOPSOIL. LIGHTLY TAMP FILL SOIL TO PREVENT FUTURE SETTLEMENT (DO NOT OVER-COMPACT). TOP OF SOIL LEVEL 2" FROM TOP OF ADJACENT CONCRETE SURFACE.
- 10 CONSTRUCT TYPE A3 INTEGRAL CURB AROUND ENLARGED PLANTER AREA.
- 11 SEE "TREE PLANTER SECTIONAL VIEW" ON SHEET 4.
- 12 RAISE LIGHT POLE APPROX. 3.75" (0.30').
- 13 CONCRETE INFILL AROUND LIGHT POLE BASE.
- 14 REMOVE UNDER SIDEWALK DRAIN PIPE & JUNCTION BOX.
- 15 INSTALL TYPE 'A' CURB INLET PER CITY OF ALBANY STD. PLAN #SD1.1. ATTACH NPDES MEDALLION TO TOP OF INLET PER CITY STD. PLAN #ST17.
- 16 EX. CURB INLET (TO REMAIN).
- 17 INSTALL 8" SDR-35 DRAIN PIPE W/1.0% MIN. SLOPE (SEE PLAN FOR INVERT ELEVATIONS). CLSM TRENCH BACKFILL TO TOP OF NEW BASE ROCK LAYER.
- 18 CONNECT 8" SDR-35 PIPE TO EXISTING CURB INLET CUT PIPE END FLUSH W/INTERIOR WALL OF INLET & GROUT SMOOTH ANY VOID SPACE AROUND PIPE.
- 19 EXISTING SIGN & POST - PROTECT IN PLACE IF POSSIBLE; IF NOT POSSIBLE, REMOVE & REINSTALL NEW POST PER CITY OF ALBANY STD. PLAN #ST11 & #ST12 (SALVAGE & REUSE EXISTING SIGN).
- 20 ALL UTILITY BOXES WITHIN LIMITS OF CONCRETE WORK TO BE REPLACED (MATCH EXISTING BOX SIZE). EXISTING BOXES & LIDS MAY BE REUSED ONLY IF FOUND TO BE IN SALVAGEABLE CONDITION BY THE CITY. ALL NEW LIDS TO BE LABELED TO MATCH EXISTING LIDS.
- 21 CONTRACTOR TO COORDINATE W/CITY FOR REMOVAL, TEMPORARY STORAGE & RE-INSTALLATION OF TRASH & RECYCLING RECEPTACLES.
- 22 CONTRACTOR SHALL SALVAGE & RESET BRICK EDGING @ BACK OF SIDEWALK WHERE AFFECTED BY CONCRETE WORK.
- 23 REMOVE EXISTING CROSSWALK LINES (METHOD OF REMOVAL TO BE APPROVED IN ADVANCE BY THE CITY). INSTALL NEW CROSSWALK LINES IN THERMOPLASTIC PER "TRIPLE FOUR" LAYOUT AS SHOWN IN CALTRANS STD. A24F. CROSSWALKS TO BE ALIGNED TO NEW CURB RAMPS.
- 24 SAWCUT, REMOVE & REPLACE 6" HMA AGAINST NEW CONCRETE FACILITIES.

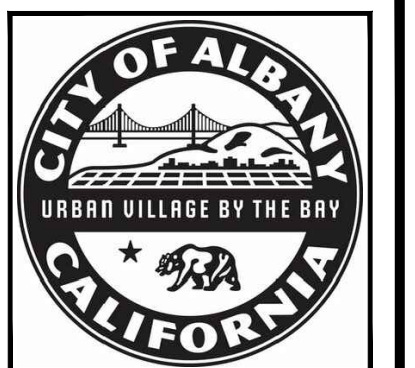
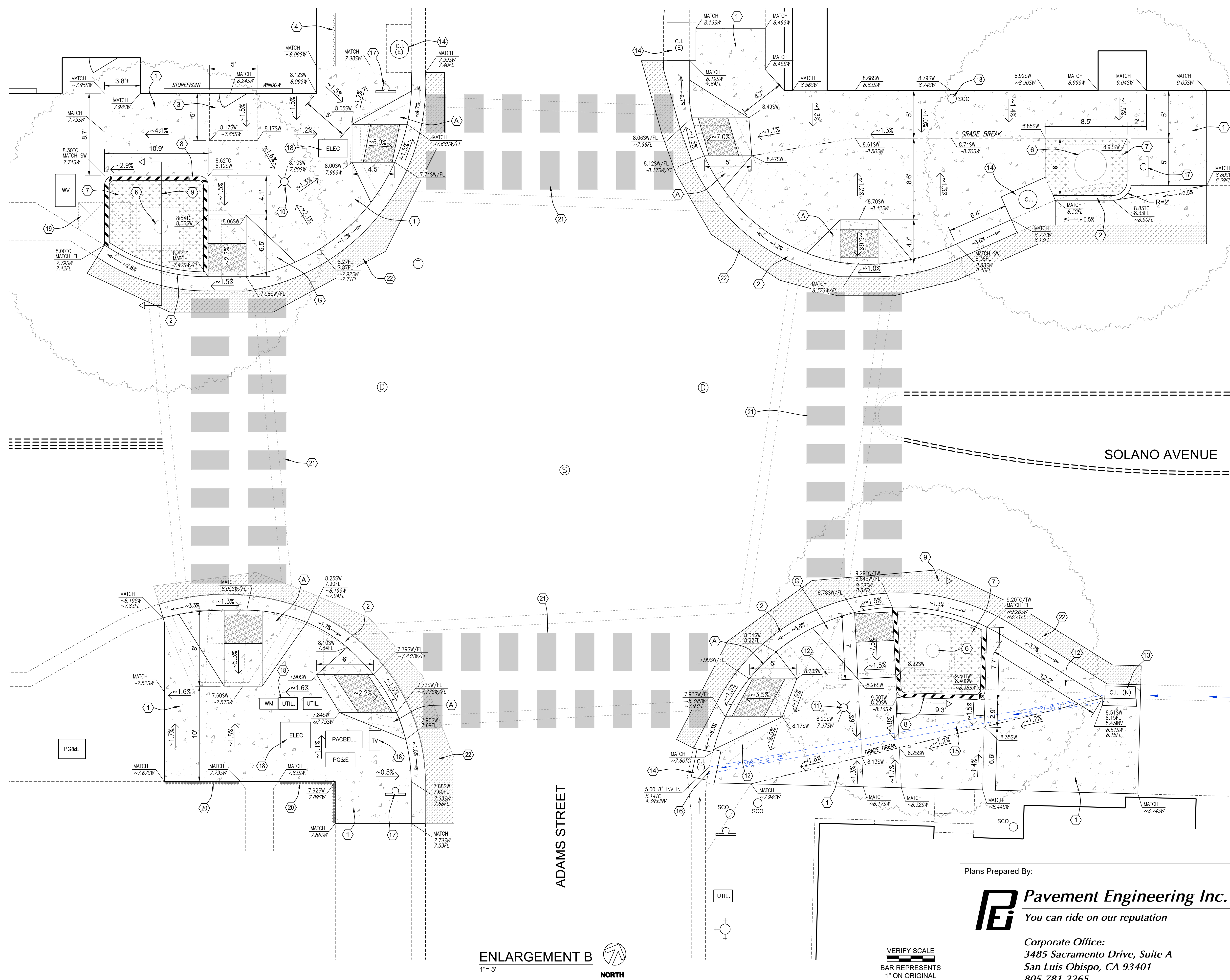

City of Albany
Maintenance Center
540 Cleveland Avenue
Albany, CA 94706
(510) 524-9543



ENLARGEMENT B
PAVEMENT REHABILITATION PROJECT
CITY OF ALBANY
ADAMS STREET: SOLANO AVENUE TO BUCHANAN STREET

Submital / Revision:

Job No: 190368
Drawn By: MPW
Checked By: JLR
Date: MAR 2020

Sheet Number:
C-3
4 of 5

Plans Prepared By:
Pavement Engineering Inc.
You can ride on our reputation
Corporate Office:
3485 Sacramento Drive, Suite A
San Luis Obispo, CA 93401
805.781.2265

Plot: 2: (User: J. Deane) View: (Project: Albany, City of) (08/08 - Albany Street) (User: J. Deane) (Date: 08/10/2020 at 14:14)

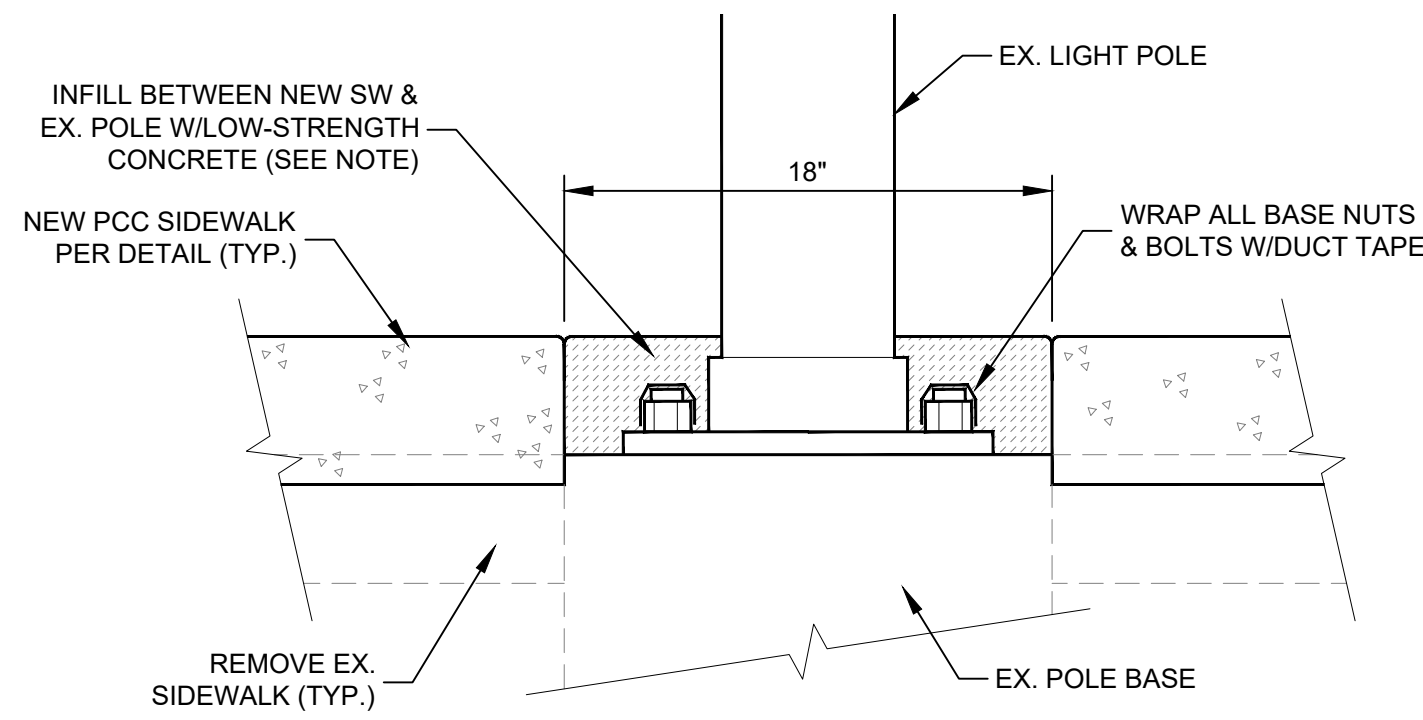

NOTE:
CONCRETE INFILL TO BE 2000 PSI - 2500 PSI WITH 3/8"- ϕ - AGGREGATE (I.E. FENCE POST MIX). TROWEL SMOOTH & FLUSH W/TOP OF ADJACENT SIDEWALK SURFACE.

CONCRETE INFILL AROUND LIGHT POLE
NTS

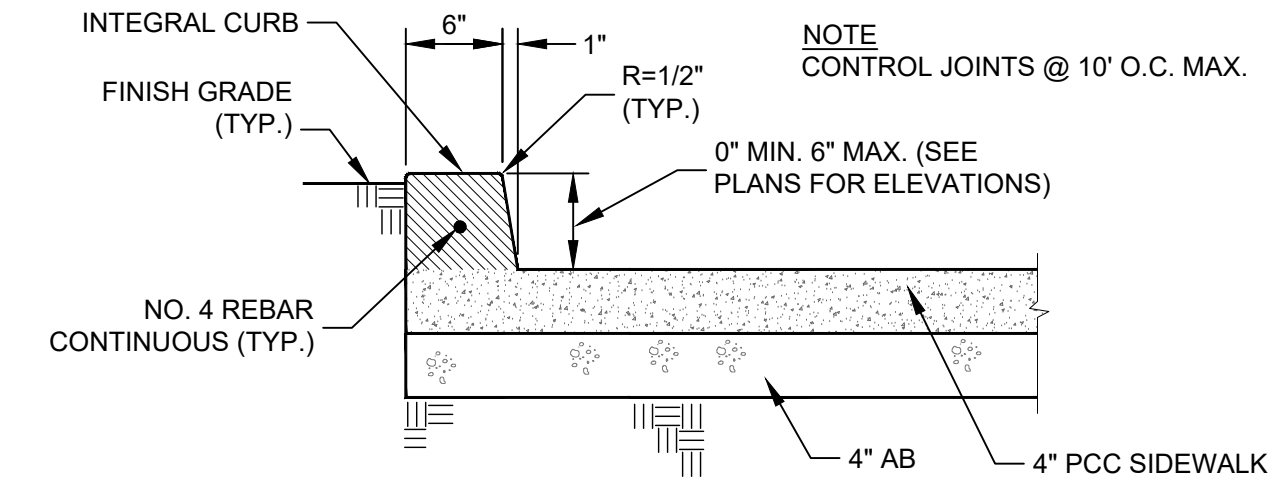

INTEGRAL CURB TYPE A3

NTS

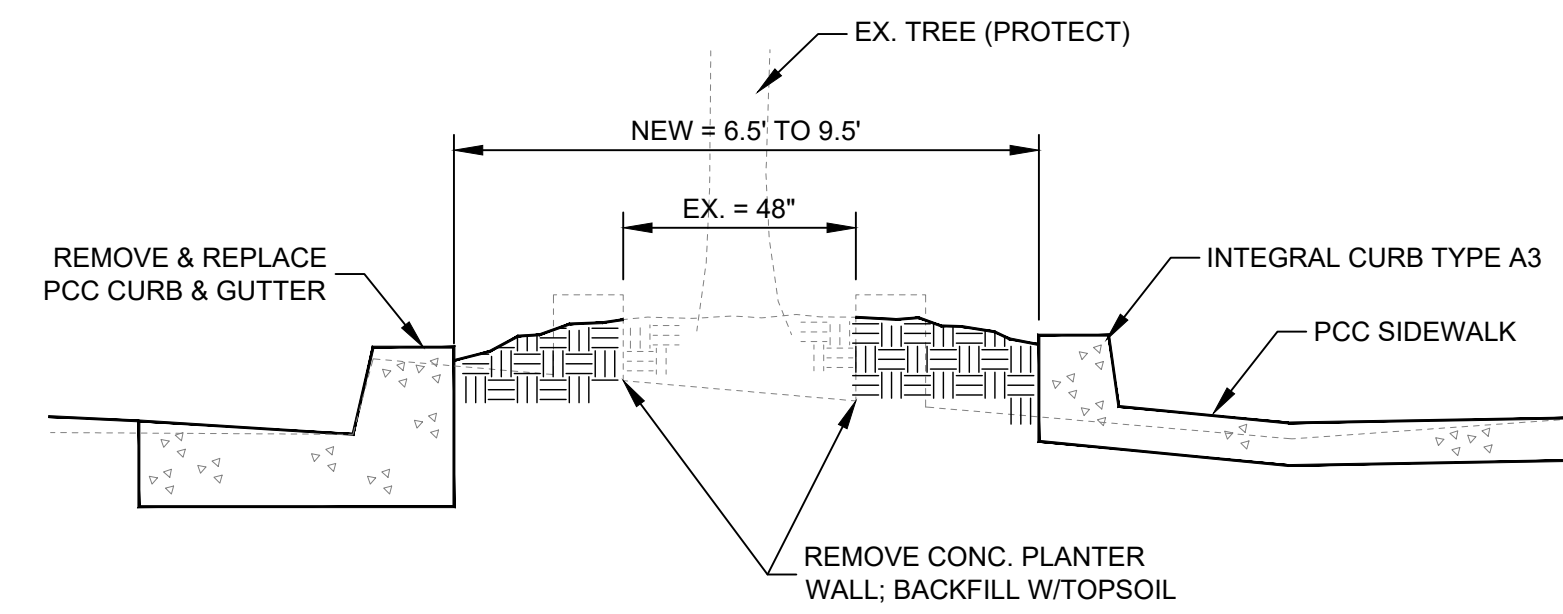

TREE PLANTER SECTIONAL VIEW

NTS

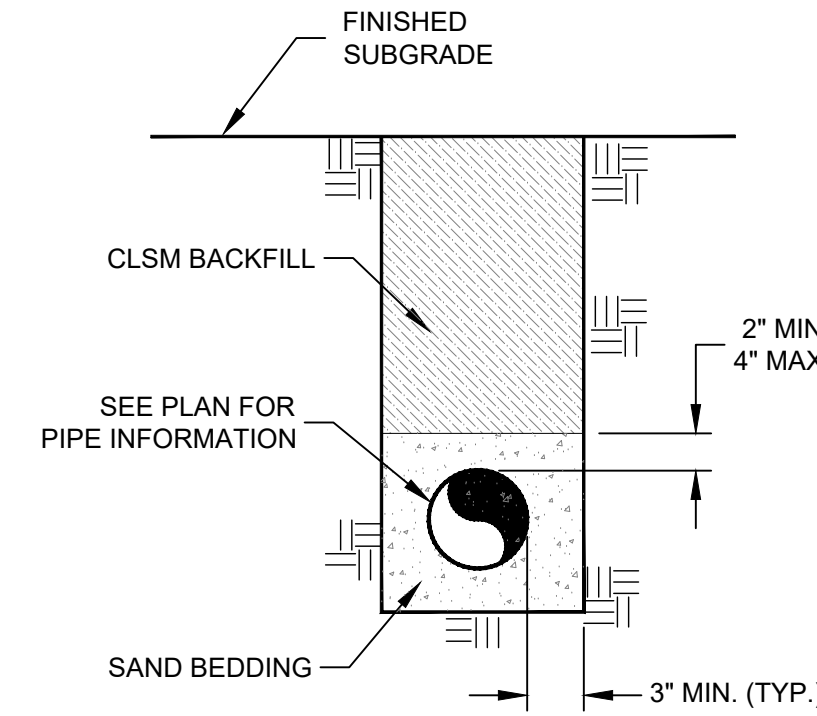

TYPICAL TRENCH BACKFILL DETAIL

NTS

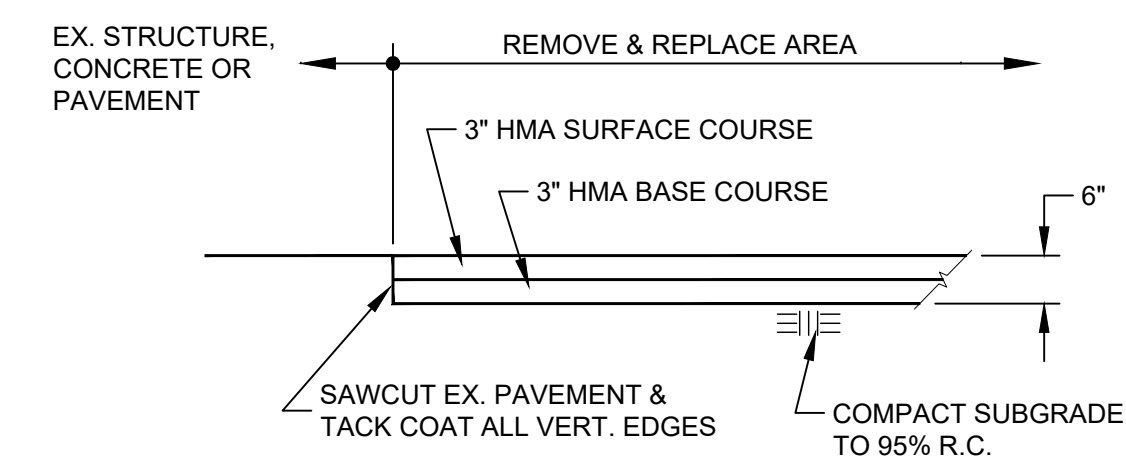

REMOVE & REPLACE 6" HMA

NTS

VERIFY SCALE
BAR REPRESENTS
1" ON ORIGINAL

Plans Prepared By:

Pavement Engineering Inc.
You can ride on our reputation

Corporate Office:
3485 Sacramento Drive, Suite A
San Luis Obispo, CA 93401
805.781.2265

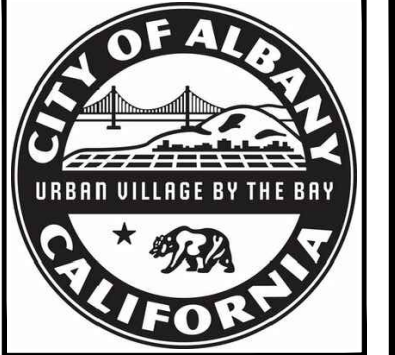

City of Albany
Maintenance Center
540 Cleveland Avenue
Albany, CA 94706
(510) 524-9543



DETAILS
PAVEMENT REHABILITATION PROJECT
CITY OF ALBANY
ADAMS STREET: SOLANO AVENUE TO BUCHANAN STREET

Submittal / Revision:	
△	
△	
△	
△	
△	
△	

Job No: 190368
Drawn By: MPW
Checked By: JLR
Date: MAR 2020

Sheet Number:
C-4
5 of 5