



**ARTS COMMITTEE MEETING AGENDA**  
**Monday, July 10, 2017, 7:00 PM**  
**City Hall Council Chambers, 1000 San Pablo Avenue**

---

**1. CALL TO ORDER**

**2. APPROVAL OF ACTION MINUTES:** June Meeting 2017

**3. PUBLIC COMMENT**

For persons desiring to address the Commission/Committee/Board on an item that is not on the agenda please note that each speaker is limited to three (3) minutes. The Brown Act limits the Committee's ability to take and/or discuss items that are not on the agenda; therefore, such items are normally referred to staff for comment or to future agenda.

**4. ANNOUNCEMENTS FROM COMMITTEE MEMBERS**

**5. ANNOUNCEMENTS FROM STAFF**

**6. PRESENTATION**

**7. UNFINISHED BUSINESS**

**7-1: Ohlone Greenway Public Art – Creek Art:** Frank Wing and Dina Angel from Studio 3 will be on hand to answer questions from the committee and receive comments.

*Recommended Action:* (1) Review artist application and community input received (2) conduct artist interview (3) if there is consensus, make a motion to recommend Studio 3's Hidden Creeks for approval to the City Council

*Attachments:* Staff Report including call for artists, Studio 3 application, Ohlone Greenway Public Art public comments

**7-2: Ohlone Greenway Public Art – Albany Loop:** The Committee will review color samples provided by Groundworks.

*Recommended Action:* Select and make motion to approve color for Albany Loop project.

**7-3: Albany FilmFest:** Chair Goodman will provide an update on the 2018 Albany FilmFest.

*Recommended Action:* Receive Information

**7-4 Community Center Foyer Gallery:** Member Black will provide an update on the 2017 Community Center Foyer Gallery and discuss the 2018 application.

*Recommended Action:* Receive Information

**7-5 Economic Development:** The Committee will nominate an Economic Development Sub Committee and discuss possible partnership with the Economic Development Committee.

*Recommended Action: Receive information and nominate members for the Economic Development Sub Committee*

**7-6 Fall into Haiku:** The Committee will discuss the 2018 Fall into Haiku Program.

*Recommended Action: For discussion*

**7-7 Promotion of Art in Albany:** The Committee will discuss the development of a strategy for promoting the Arts Committee and art in Albany

*Recommended Action: For discussion*

## **8. NEW BUSINESS**

**8-1 Art on BART Columns:** The Committee will discuss the feasibility of commissioning art on the BART columns along the Ohlone Greenway

*Recommended Action: For discussion*

## **9. FUTURE AGENDA ITEMS**

(Commission/Committee/Board Member announcement of requests for future agenda items. No public comment will be taken on announcement of future agenda items). **Next Meeting:** September 11, 2017.

## **10. ADJOURNMENT**

**NOTE:** The Commission/Committee/Board packet is available for public inspection at the Albany Community Center, Senior Center, and City Hall. The agenda and supporting staff reports, if available, can be found on our web page at [www.albanyca.org](http://www.albanyca.org). If you provide your name and address when speaking before the Commission/Committee/Board it will become part of the official public record, which will be posted on the Internet.



**ARTS COMMITTEE MEETING MINUTES**  
**Monday, June 12, 2017, 7:00 PM**  
**City Hall Council Chambers, 1000 San Pablo Avenue**

---

**1. CALL TO ORDER: 7:02 pm**

**Present:** Chair Goodman, Members Black, Daly, Holland, Komaromi, Linden and Schneider.

**2. APPROVAL OF ACTION MINUTES: May Meeting 2017**

**Motion:** A motion was made by Member Komaromi and Seconded by Member Black to approve the May 2017 meeting action minutes:

**Aye:** Chair Goodman, Members Black, Daly, Holland Komaromi, Linden and Schneider

**Noes:** None

**Abstane:** None

The motion carries and so ordered

**3. PUBLIC COMMENT**

**4. ANNOUNCEMENTS FROM COMMITTEE MEMBERS**

**5. ANNOUNCEMENTS FROM STAFF**

**6. PRESENTATION**

**6-1: Poet Laureate update:** Albany's Poet Laureate, Rebecca Black, provided an update.

**7. UNFINISHED BUSINESS**

**7-1: Ohlone Greenway Public Art - San Gabriel Play Sculpture:** Brennen Cox from Groundworks was interviewed by the committee and received public comments for the Albany Loop Project at the San Gabriel Triangle.

**Motion:** A motion was made by Member Holland and Seconded by Member Black to recommend Groundworks' public art project 'Albany Loop' to City Council for final approval pending color approval by the Arts Committee at July 10, 2017 meeting.

**Aye:** Chair Goodman, Members Black, Daly, Holland Komaromi, and Linden

**Noes:** Member Schneider

**Abstane:** None

The motion carries and so ordered

**7-2: Albany FilmFest:** Chair Goodman provided an update on the 2018 Albany FilmFest.

**7-3: Arts and Green Festival:** The Albany Arts and Green Festival sub-committee debriefed the Arts Committee on the 2017 Arts and Green Festival and discussed the committee's role in the 2018 Arts and Green Festival.

**7-4 Community Center Foyer Gallery:** Member Black provided an update on the 2017 Community Center Foyer Gallery and discussed the 2018 application.

**7-5 Public Art Dedication at Belmont Village:** The dedication ceremony will be held on Tuesday, July 11, 2017 at 11:30 AM.

**8. NEW BUSINESS**

**8-1 Economic Development Commission Draft Plan:** Chair Goodman shared with the committee comments he sent regarding the economic development draft plan.

**9. FUTURE AGENDA ITEMS**

Arts and Green follow-up (October), Promotion of Art in Albany, Economic Development sub-committee, Artist Registry, FilmFest, Fall into Haiku, BART Columns Art. **Next Meeting:** July 10, 2017.

**10. ADJOURNMENT**

**NOTE:** *The Commission/Committee/Board packet is available for public inspection at the Albany Community Center, Senior Center, and City Hall. The agenda and supporting staff reports, if available, can be found on our web page at [www.albanyca.org](http://www.albanyca.org). If you provide your name and address when speaking before the Commission/Committee/Board it will become part of the official public record, which will be posted on the Internet.*

**CITY OF ALBANY  
ARTS COMMITTEE  
STAFF REPORT**

Agenda Date: June 12, 2017

**SUBJECT:** Ohlone Greenway Public Art Projects – Groundwork’s Albany Loop

**REPORT BY:** Isabelle Leduc, Community & Human Services Manager

---

**STAFF RECOMMENDATION**

That the Arts Committee review public comments received to date on the Ohlone Greenway Public Art Projects and conduct artist interview- Groundworks.

**BACKGROUND**

On April 4, 2016, Council approved the Arts Committee’s first Public Art Projects Plan which included Public Art installations as part of the Ohlone Greenway Improvement plan. Public art opportunities included “Creek Art” - the demarcation on the pedestrian/bicycle path of Codornices and Cerrito creeks, the two gateways to the Greenway, as well as Marin Creek. Another project, the “San Gabriel Play Sculpture” consists of the creation of an interactive play sculpture at San Gabriel and Portland Avenues.

The Call for Artists (attachment 1) was released June 23, 2016 with a submission deadline of September 22, 2016. A 9-member selection panel consisting of professionals with relevant backgrounds and residents were assigned to review the submissions received. On December 9, 2016, the selection panel recommended four artists to the Arts Committee.

On January 9, 2017 and February 13, 2017, the Albany Arts Committee selected Studio 3 for Creek Art and Groundworks’ Albany Loop for the San Gabriel Play Sculpture.

**DISCUSSION**

As described in the Public Art Master Plan, the Arts Committee must foster community participation in the Public Art Program and provide opportunities for community input by arranging meetings with artists selected for public art projects and arrange for the public display of artists’ models for public art projects under consideration.

**PUBLIC OUTREACH**

Upon selection by the Arts Committee, the artists were asked to create 3 dimensional models of their proposed projects. The Ohlone Greenway Public Art projects 3 dimensional models have been on display at the Albany Community Center since April 17

and will remain in the lobby until June 19. Comment cards and an online form are available for the public to use to share their thoughts and opinions about the proposed public art pieces. Over 300 comments cards have been received so far.

Additional outreach efforts for receiving public input include:

- Social Media (Posts on Recreation Dept. Facebook, Nextdoor and Twitter)
- Citywide e-newsletter
- Postcards and flyers at City events (Arts & Green Festival, Park Clean-up Days, Bike About Town and Bike-In Movie Night)
- Mailing to residential dwellings within 300' of the four public art sites (attachment 2)
- Artist presentation at Traffic & Safety Commission
  - Studio 3 – February 16, 2017
- Artist presentation at Arts Committee meeting
  - Groundworks – February 13
- Artist Interviews
  - Groundworks - June 12, 2017
  - Studio 3 – July 10, 2017

### **NEXT STEPS**

The Arts Committee will analyze all information gathered and public input received to prepare a recommendation to the City Council.

### **Attachments**

1. Call for Artists
2. Groundworks Proposal – Albany Loop
3. List of Public Comments received based on 3 dimensional models



## Application for Ohlone Greenway Public Art Project

Deadline: September 22, 2016, 4:00 PM

Name(s) Studio 3 - Dina Angel Wing, Frank Wing, Alan Osborne  
 Address 3450 Sacramento Street #400 City San Francisco State CA  
 Phone 415.776.1050 Fax \_\_\_\_\_ Email studio3sf@yahoo.com  
 Website address(es) www.dinaangelwing.com www.frankwingphoto.com www.alanosborneart.com

- I am submitting this application for Project 1 - San Gabriel Play Sculpture  
 I am submitting this application for Project 2 - Creek Art

**Application Checklist** – Please submit ten (10) complete, one-sided, collated sets of the written materials listed below. Each set should contain one of each of the materials, in the order in which they are listed below. Please do not bind materials and do not submit in plastic sleeves, folders or binders.

- Written description of the proposed artwork, including the artist's intent, process, and project goals, and the names of all project partners including contractors and subcontractors;
- Artist's resume and/or other supporting materials relevant to the artist's experience with similar projects, such as the artist's website(s) and portfolio and three (3) letters of reference or testimonials;
- Detailed description of proposed materials and methods of installation deemed suitable for the site conditions;
- Photographs of the existing site;
- Adequate visual representation, in color, of the proposed work, in drawing(s) and/or three dimensional model(s), with scale indicated;
- A scale drawing or digital photographic mockup depicting the proposed work in the context of its environs (with surrounding landscape, buildings, sidewalks, etc.);
- A preliminary estimate of all costs related to creating and installing the artwork;
- A project timeline including design process, all city reviews and installation;
- A suggested maintenance plan indicating schedule, instructions, life expectancy of work, etc.

Incomplete or incorrectly assembled applications may not be accepted. Neither the Albany Arts Committee nor the City of Albany staff may be held responsible for lost, missing, or damaged materials submitted. The Albany Arts Committee will endeavor to return the originals to the applicant. The City of Albany reserves the right to refuse all entries.

PLEASE INCLUDE A SELF-ADDRESSED ENVELOPE WITH ADEQUATE POSTAGE FOR RETURN OF APPLICATION MATERIALS.

---

Send Application Form and materials, **prior to September 22, 2016**, to:

City of Albany, Att: Isabelle Leduc

Recreation and Community Services, 1249 Marin Avenue, Albany, CA 94706

## Studio 3

### Proposal for the Albany Greenway Three Creek art Project

#### 1. Proposed artwork for the three intersecting creeks

We see using a map symbol of streams—wavy lines as a graphic way to demarcate the junctions where the three creeks cross the bicycle/pedestrian pathways. Our proposal for identifying the three streams impacting parts of the Greenway consists of parallel bronze wavy lines. These lines are symbolic and will look like golden stripes as they are constantly rolled over and unwittingly polished by bikes and pedestrians. Complementing these lines will be inserts in the shape of local tree leaves, birds and other local animals or insects also made of bronze. These and the wavy lines will be anchored by means of deep seated bolts embedded in newly poured asphalt or concrete. The goal is not only to show where the three creeks cross over the bike and pedestrian trail but also the point out some of the living things that users are passing on their way along the Greenway.

#### 2. Resume and supporting materials

Letters of recommendation are included along with the artists' resume and portfolios indicating experience with bas relief and similar two dimensional treatment of artistic statements.

#### 3. Detail description of proposed materials and installation for artwork

The bronze wave lines will be approximately 3/4 to 1" thick by 6" deep and up to 10' long, set on its side to project flush with the finished road surface. Depending on the cost of materials another solution will be to have a 3/4" to 1" thick by 2" deep ribbon with anchor bolts welded every 6" oc along the length of metal. These could also be fabricated out of stainless steel for a silver look. The small inserts will be made of the same material to match the look.

#### 4. Photographs of the existing site are included in the submission

#### 5. Graphic depiction of the lines and possible silhouette icons are included with the submission.

#### 6. Digital composites depict the effect of installing the proposed art on the locations specified and are included.

#### 7. Preliminary costs for fabricating and installing the proposed are at three site locations

It is estimated that within the given budget each of three installations will have to be \$5000. Further research will be done to determine if casting in bronze or bending stainless steel would be the best solution but we think that the proposal can be fabricated and installed within the budgetary constraints.

#### 8. Projected timeline for creating and installing this particular design

We feel that the projected time to create and install this design would be 2-4 months depending on weather.

#### 9. Maintenance program

Because the exposed metal will be constantly impacted by traffic, it would stay polished not needing maintenance.



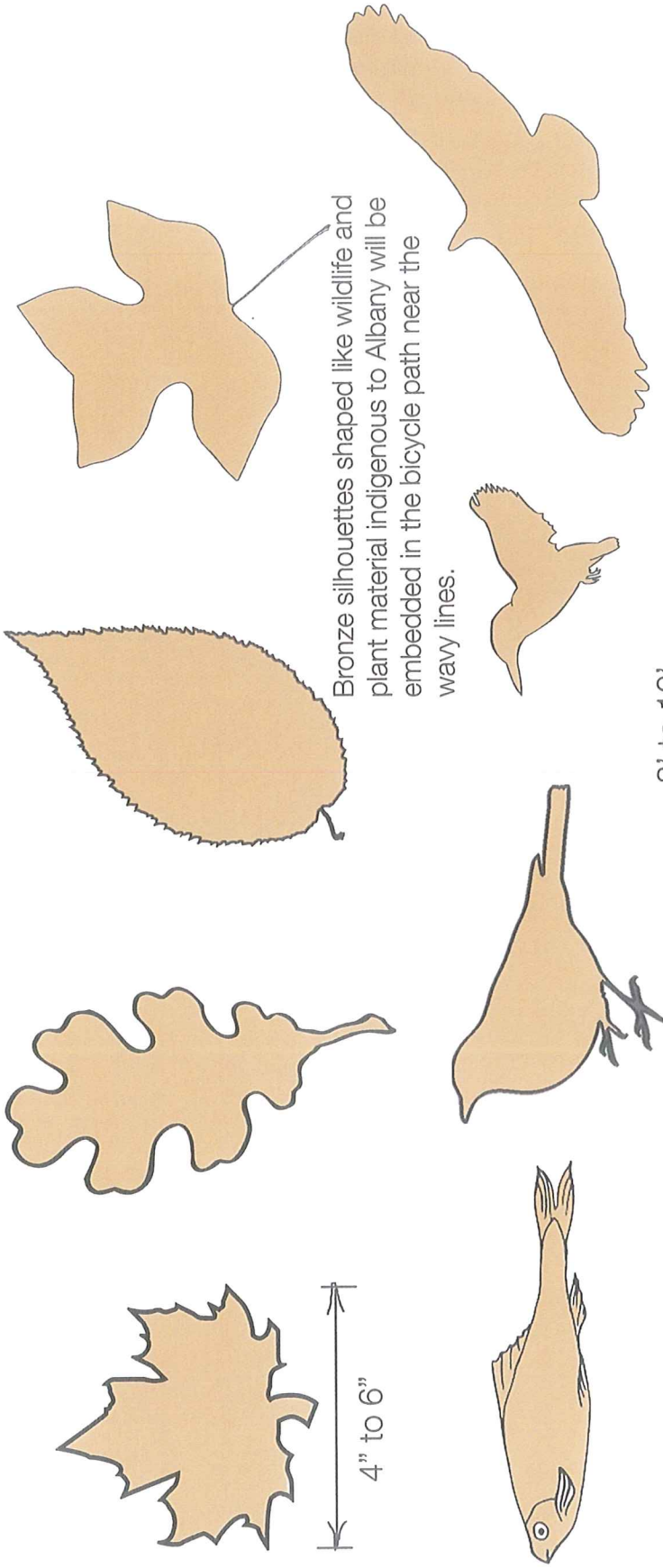

Bronze silhouettes shaped like wildlife and plant material indigenous to Albany will be embedded in the bicycle path near the wavy lines.

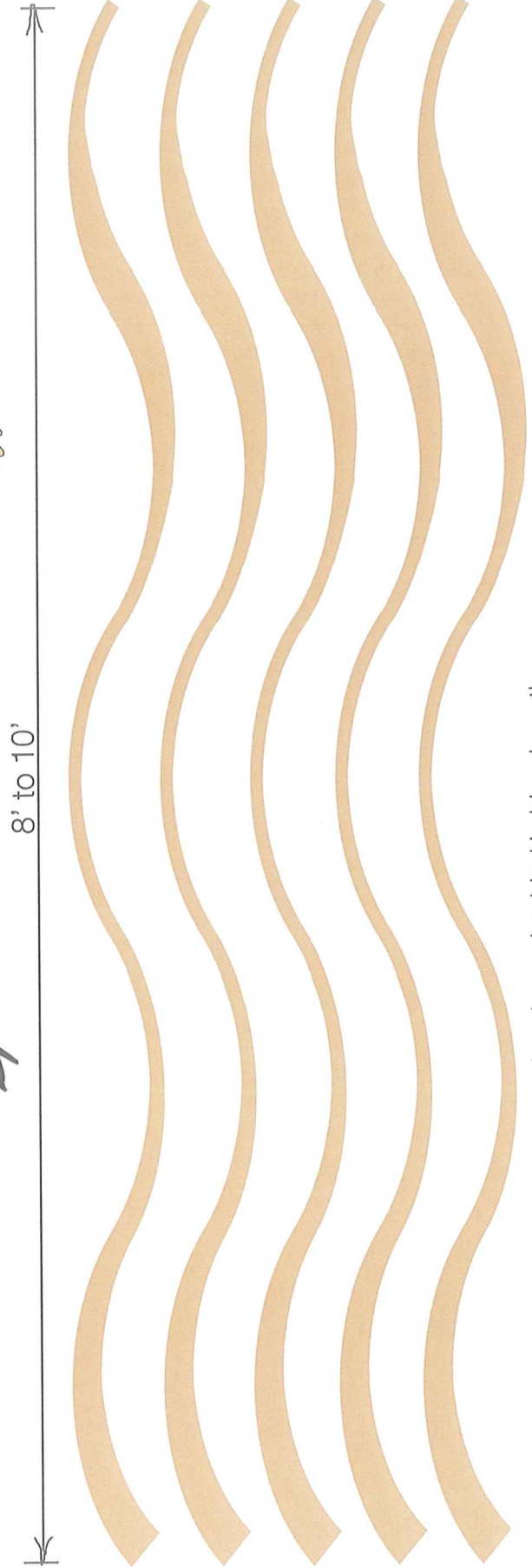

Bronze wavy lines symbolize a creek to be embedded in bicycle path to demarcate points where the three creeks pass under the path

Proposal 2 - the 3 Creeks Art  
by Studio 3

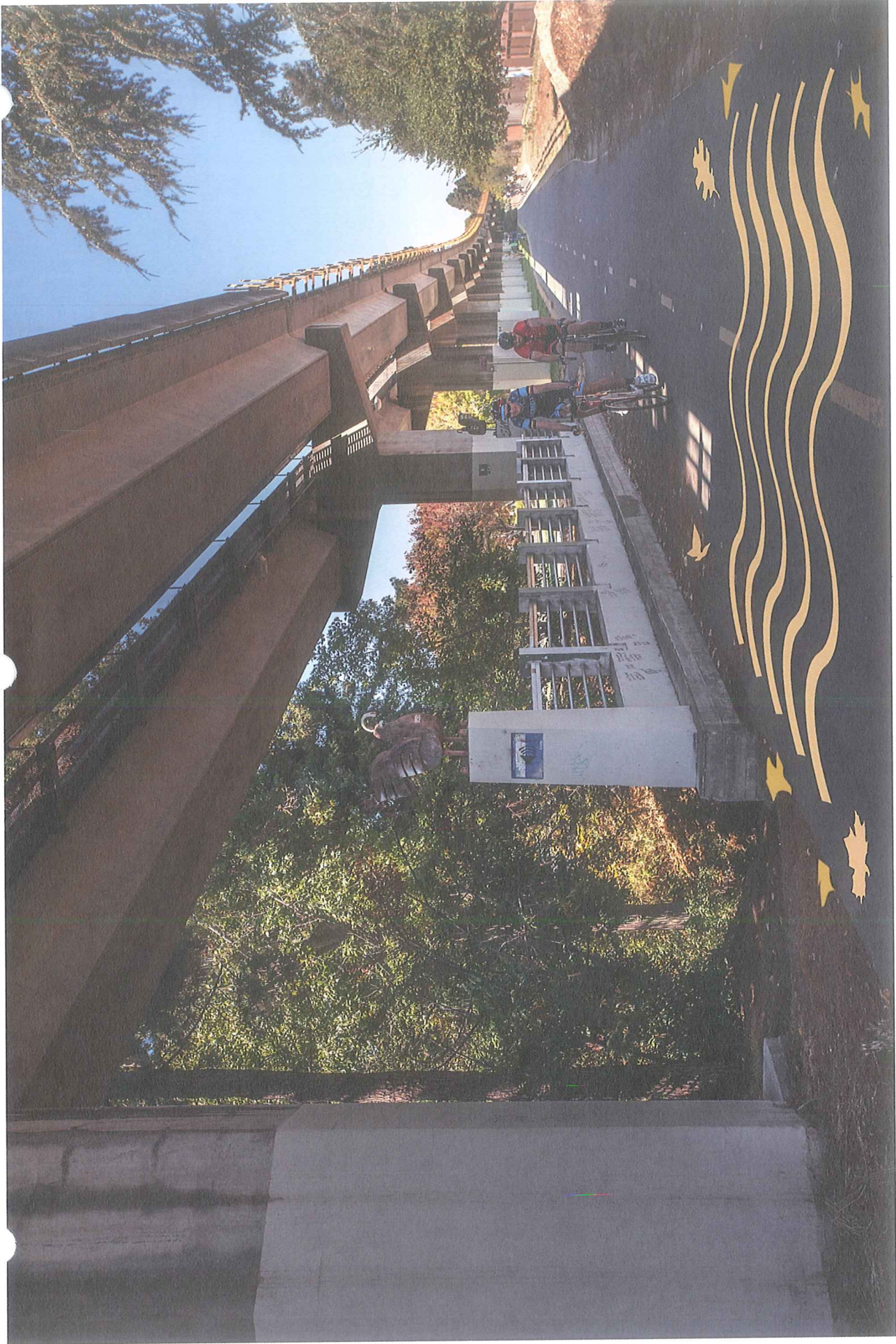

Proposal 2 - Creek Art at Codornices Creek  
by Studio 3

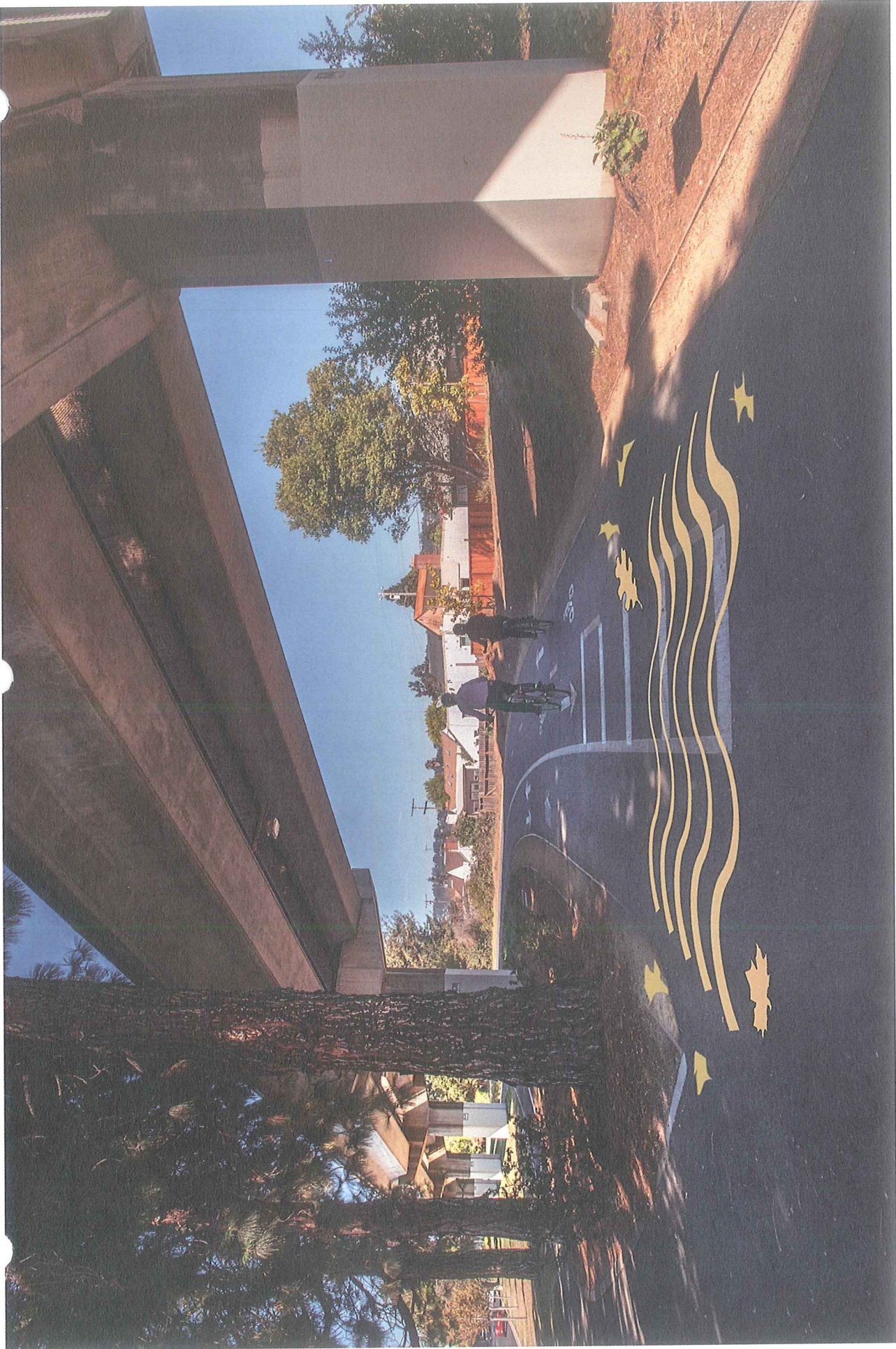

Proposal 2 - Creek Art at Marin Creek  
by Studio 3

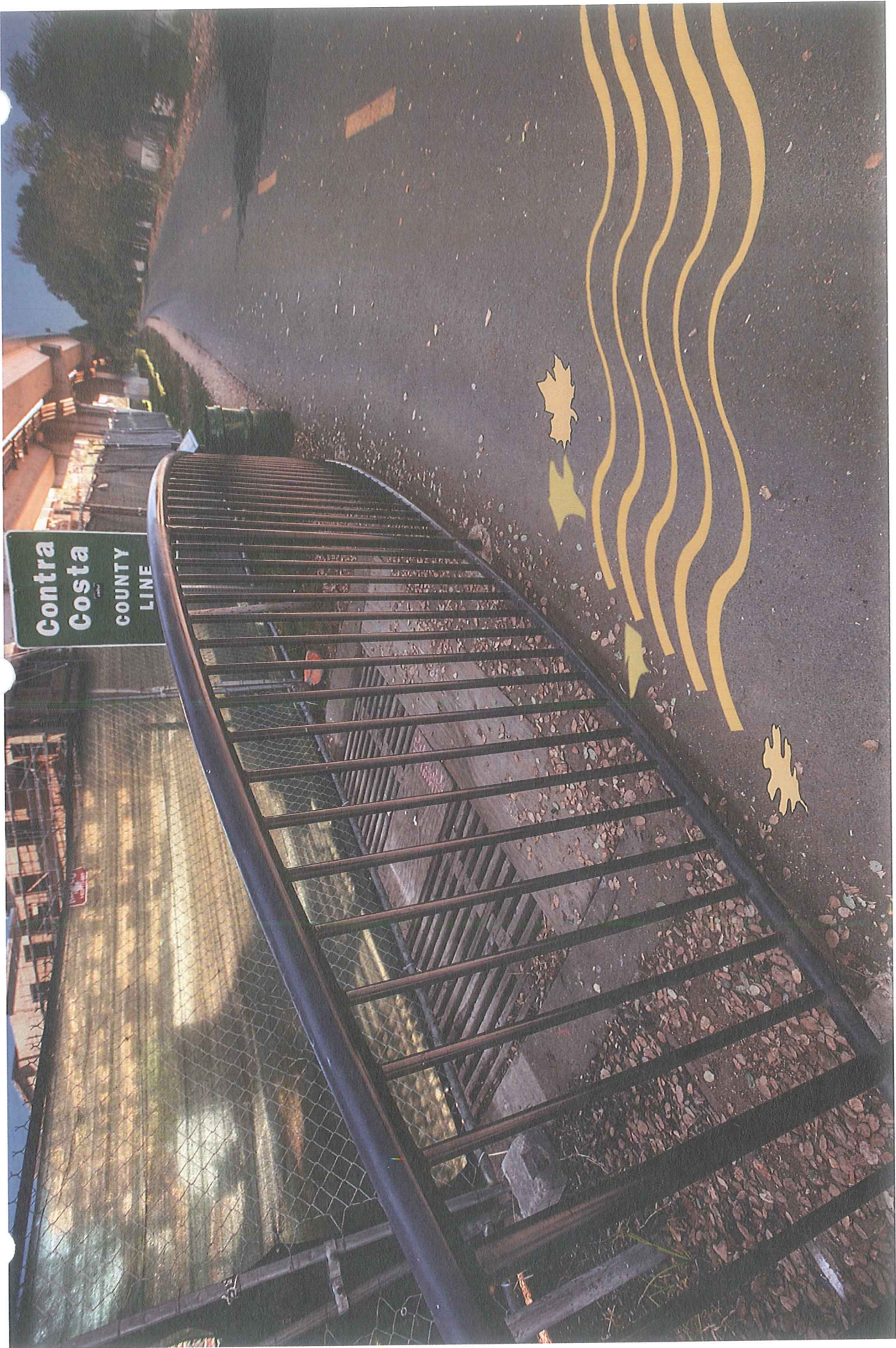

Proposal 2 - Creek Art at Cerrito Creek  
by Studio 3



“Above the Midden” - Studio 3 group proposal for Berkeley Marina  
 budget \$100,000 Competition for environmental art - second place  
 by Dina Angel Wing, Frank Wing, Alan Osborne and architects

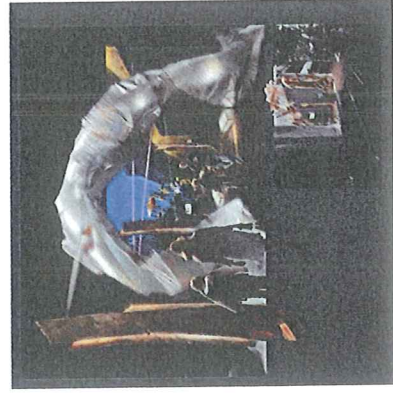

“BART station” by Frank Wing



“Bus Portal” by Alan Osborne

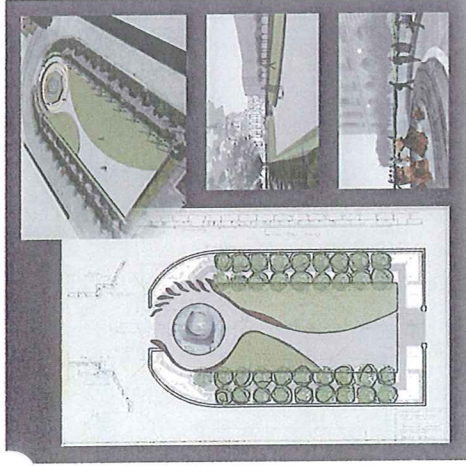

“War Memorial” Studio 3 proposal for War Memorial Auditorium S.F.

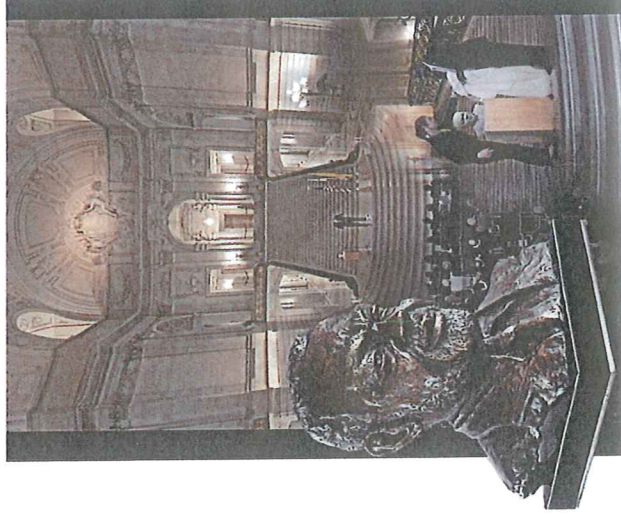

“James Jefferson” bust of SF Commissioner unveiled at SF City Hall  
 Bust of Lawrence Ferlinghetti for SF North Beach Library  
 both by Dina Angel Wing



Civic art & previous competitions by  
 members of Studio 3

## Alan Osborne RESUME

Alan Osborne has been working for more than 30 years on large scale bronze art, winning numerous competitions including the commission to install seven 18'-20' sculptures at the University of Dayton (\$500,000 budget). His 700 foot long bronze and steel installation along Watt Avenue in Sacramento was the winning entry of the SMAC competition (\$300,000).

His studio includes a commercial foundry supplying well known Bay Area artists with highly skilled casting. St Mary's Cathedral in San Francisco has two Coat of Arms plaques created for them by Alan while the BART Station at the SFO airport also has a piece by him. He set up a foundry for large scale art in India.

Osborne's new expression with enamels provides an exciting avenue for him to explore 2-dimensional pieces with heightened intensity by incorporating the raw color only possible with enamels, this provides a permanent medium unaffected by UV and weather.

Education Seattle University

### Selected Major Installations

- 2010 Seven large 15'-20' bronze sculptures University of Dayton, Ohio
- 2009 Ascending, 21 foot bronze sculpture for 1201 K Street, Sacramento
- 2006 Watt Avenue Beautification Project, Sacramento
- 2004 Light Rail Sunrise Station, Citrus Heights, CA  
San Francisco International Airport Bart Station, San Francisco, CA  
State Capital, Sacramento, CA  
YMCA, Charlotte, North Carolina
- 2001 Embassy Suites, Sacramento, CA
- 1997 Court House Plaza, Palo Alto, CA
- 1995 Saint Elizabeth Seton Church, Chicago, Illinois
- 1994 EAA Airport, Oshkosh, Wisconsin  
Saint Elizabeth Seton Church, Chicago, Illinois
- 1992 City of San Leandro, CA  
Government of US Somoa, South Pacific
- 1991 St. Joseph's Cathedral, San Jose, CA
- 1991 Genentech, San Francisco, CA
- 1990 Kashiwazaki Kariwa Nuclear Power Plant, Tokyo, Japan
- 1990 Ronald Reagan California State Building, Los Angeles, CA
- 1989 Brooks - McCormick, McCormick Ranch, Chicago, Illinois
- 1988 Ariens Company, Brillion, Wisconsin
- 1986 Oakland Museum of Art, Oakland, CA

### Selected Commissions & Public/Private Collections

- 2011 Light on Water series of enamel on copper- Mahoney-Getz, Sacramento, CA
- 2006 Coat of Arms, Saint Mary's Cathedral, San Francisco, CA
- 2006 Watt Avenue Art Project
- 2002 Light Rail Sunrise Station, Citrus Heights, CA
- 1997 Coat of Arms, Saint Mary's Cathedral, San Francisco, CA
- 1993 Armor Piece, Tom Duzanaka, Todo Santos, Mexico

### Media Coverage

- 2010 Corporate Design Group - YouTube
- 2009 Examiner San Francisco, CA  
Sacramento Magazine, Sacramento, CA

### Lectures

- 2002 Crocker Art Museum, Sacramento, CA
- 2001, 2002 De-Young Museum, San Francisco, CA

## DINA ANGEL-WING - sculptor, resume

Dina Angel-Wing has focused on creating three dimensional art that appeals to different senses. Her work spans different media from the textural experience of paper and clay to the polished tactile sensibility of smooth bronze and glass.

Her sculpture aims at a visual experience that is both aesthetic as well as intellectually engaging. Some of her work has incorporated humor, puns, and symbolism. Her current work juxtaposes soft curvilinear figures with architectonic geometrically based stands and smooth bronze with rough weathered steel, while her public portrait interpretations captures lively personality in bronze.

### PUBLIC VENUE ART COMMISSIONS:

Bust of Leroy King San Francisco Commissioner - The Heritage Museum Fillmore Jazz Center San Francisco  
Bust of James Jefferson - The Heritage Museum Fillmore Jazz Center San Francisco  
Glass hands A Family - St Lukes Hospital, Cedar Rapids, IO  
"Going Nowhere" site specific sculpture installation - Atlanta, GA  
Suspended Sculpture - Three Divers: Charles Eizen Associates Denver, CO  
Environmental Sculpture - Sheraton Palace Hotel , San Francisco, CA  
Lobby Sculpture - Emerging Markets Investments Building, Bethesda, MD  
Sculpture 5' mixed media - DC Douglas Interiors, Danville, CA  
Site specific Sculpture - Sushi-Ko Restaurant, Washington, DC

### SHOWS:

Sculpturesite - Body Language, Sonoma, CA  
Sculpturesite New Leaf Gallery - Bodyworks, Sonoma, CA  
Art Foundry Gallery - Anniversary Show, Sacramento, CA  
Art Foundry Gallery - Bronze Sculpture Show, Sacramento, CA  
Sirani Gallery - The Figure, Pittsburgh, PA  
The Rentz Gallery - One person show, Richmond, VA  
Los Angeles Country Museum - Figurative sculptures, Los Angeles, CA  
New Leaf Gallery - Figurative sculpture, Berkeley, CA  
Hayward City Gallery - Clay & Glass Sculpture, Hayward, CA  
Triton Museum - Poetry in Clay & Glass, Santa Clara, CA  
LA County Airport Gallery - Art of Clay, Los Angeles, CA  
Cecile Moochnek Gallery - Sculpture & Painting, Berkeley, CA  
William Zimmer Gallery - One Person Sculpture Exhibition, Mendocino, CA  
Japanese Garden Society Gallery - Garden Treasures, San Diego, CA  
Philadelphia Museum of Art - Artcraft Show, Philadelphia, PA

### PUBLICATIONS:

*New York Times, House Beautiful, International Entertaining Magazine, Home and Garden, Los Angeles Times, Washington Post, Oakland Tribune, San Francisco Chronicle, San Francisco Examiner Image Magazine feature.*

Dina Angel-Wing - sculptor, continued

BOOKS:

*The Artful Home* - Toni Sikes, Lark Books 2008

*Object Lessons* - Guild Publishing 2001

*More Than Clay* - The Toki Collection of Ceramics 1998

*Make It In Clay* - Charlotte F. Speight & John Toki, Mayfield Publishing Co. 1997

COLLECTIONS:

Cumm Collection - Los Angeles, California

Leslie Ceramics Collection - Berkeley, California

Antonio Prieto Collection - Mills College, Oakland, California

John Denver collection - Los Angeles, California

Embassy of Luxembourg - Tokyo, Japan

Brunnenburg Museum Collection - Merano, Italy

Gwen Laurie Smits Collection - Los Angeles, California

Other private collections throughout the US, and Europe



Frank Wing | photographer & graphic designer



*Frank Wing is a commercial photographer with an uptown studio in Lower Pacific Heights of San Francisco, specializing in food, products, art and people both in the studio and on location. He provides graphic design incorporating his photography for books, web sites and print collateral.*

Training in architecture provides Mr. Wing with an artistic sensibility which shows in his careful compositions and finesse with color as well as his dynamic lighting that defines three dimensions and texture in products and art. He works directly with art directors and designers to conceptualize a direction for the photography before setting up on site or in his studio.

His graphic design provides clients with print ready, color balanced art for books and brochures. Combining his photographs of Arabic calligraphy and design, he created an award winning catalogue for the Museum of Islamic Art in Doha that features double covers, on one side in Arabic, read from right to left on the other side in English, read in reverse.

Using current camera technology, Frank also has experience shooting, lighting and editing video and works in various camera formats depending on the final requirements. His experience in print output insures that his digital processing and color adjustments are correct for critical pre-press demands or digital use.

## SELECTED EXPERIENCE

### Photography

Over 500 photographs of fine French style bakery products for the 1000 page book *Advanced Bread and Pastry* by Michel Suas.

Over 200 photographs of the complete collection of Auguste Rodin sculptures for the 1000 page catalogue for Stanford University Cantor Center for the Arts published by Oxford University Press titled *Rodin's Art*.

Award winning photography for corporate clients and extensive photography for regional museums, Schloss Tirol and Brunnenburg near Merano, Italy.

Boston Globe staff photographer and journalist with articles in the Boston Globe Sunday Magazine.

## SELECTED AWARDS

AIGA Award of Excellence  
Communication Arts  
Industrial Graphics  
SF Society Communicating Arts  
Western Art Directors Club

## EDUCATION

BLA University of Michigan  
MLA Harvard University

## SPEAKING ENGAGEMENTS

Kodak - Digital Photography  
for the Modern World,  
multi-city tour in China



San Francisco  
Arts Commission  
25 Van Ness Avenue  
Suite 345  
San Francisco, CA 94102  
gchew@dae.com  
sfartscommission.org

**Greg Chew**  
Commissioner  
At Large

To Whom It May Concern,

It is my distinct pleasure to be able to recommend the sculptor, Dina Angel Wing, for a public art commission, both from my position as a San Francisco Art Commissioner and as a private art collector. Her bronze bust interpretation of our famed local Poet Laureate, Lawrence Ferlinghetti, now resides in a place of honor at the North Beach Library in the Ferlinghetti Reading Room and is in line for acceptance to San Francisco's Permanent Art Collection.

As a private collector, I commissioned Dina for a special commemorative sculpture for my personal collection. Together we developed the concept of the piece to fit a particular interior space within the timeline that I required. I felt that she was very professional in her approach to the project both in doing the research, conceptualizing small scale maquettes and producing the finished sculpture under an imposed deadline.

For a public art commission, I highly recommend Dina, for her professional approach to the production of her sculpture. She can handle everything from concept to finished work including final installation in a timely manner while her artistic merit goes without saying. Her portraits, figurative sculpture and abstract pieces show a sophisticated artistic sensibility which I'm sure would enhance any public art commission for the City of Albany.

Should you have any further questions, do not hesitate to contact me directly.

Sincerely,  



*Shelley Bradford Bell ♦ Consultant*

775 Post Street, #109 ♦ San Francisco, CA 94109

415-749-1083 Direct/Office ♦ 415-724-0136 Cell ♦ 800-605-3790 Toll Free

[Shelley@Shelleybradfordbell.com](mailto:Shelley@Shelleybradfordbell.com) ♦ [www.shelleybradfordbell.com](http://www.shelleybradfordbell.com)

September 19, 2016

Letter of recommendation for:  
Dina Angel-Wing

To Whom It May Concern:

It is my great honor to recommend Dina Angel-Wing on her grant application. I had the opportunity to work with Dina on two separate and celebrated projects in San Francisco that recognized two great leaders who have passed on. One, the bust of James Jefferson a community leader, former SF Fire Commissioner and founder of San Francisco African American Chamber. The other, was the bust of our revered leader SF Redevelopment Commissioner and ILWU Union Leader LeRoy King.

Dina's artistic hand capture the essence of both these men. She worked with photos of Jim because he passed before the bust was commissioned. She had the opportunity to meet LeRoy and to unveil the bust for him just a few years before he passed.

Both of these busts are now housed at the African American Jazz Heritage Center in San Francisco's Fillmore community. Both men were instrumental in seeing the center built. Both busts now stand watch over the center's transformation.

Dina is a talented, conscientious, deadline-oriented artist. She is to me a premier sculptor and an incredible woman of integrity and talent.

I could not be more pleased to make this recommendation. I cannot encourage you more to support her with your grant funding.

Please feel free to call me or email if you have questions. I can be reached at 415-749-1083 or [shelley@shelleybradfordbell.com](mailto:shelley@shelleybradfordbell.com).

Sincerely,



Shelley Bradford Bell



*San Francisco Public Library*

September 21, 2016

To Whom It May Concern,

Sculptor Dina Angel Wing, has provided our new North Beach library with a striking bronze portrait of San Francisco's Poet Laureate, Lawrence Ferlinghetti, which dominates a choice corner of the library designated as the Ferlinghetti Reading Room. It was finished just in time for the opening ceremonies and installed securely in place by her own installation crew and represents a masterful commemoration of our famed poet near his City Lights Book Store.

We are delighted to have her sculpture waiting to be added to the permanent city art collection of San Francisco so that it will remain a reminder of the contributions of Lawrence to the literary importance of our city to the world of poetry and literature at our library.

I am happy to recommend Dina for any art commission for public art in Albany and feel that not only will her work be creatively inspired but that she can handle the pragmatic issues facing civic art of timely delivery, installation and community outreach.

Sincerely,

A handwritten signature in cursive script, appearing to read "Luis Herrera".

Luis Herrera  
City Librarian

Looks great!	Looks great, but...	Resident	Comments
189	115	182	
		x	I think it looks ugly and is too industrial looking for our small town. Thanks.
	x	x	That "ALBANY" sign was removed. It completely draws the eye away from the natural beauty and the sights of people and animals enjoying the parklet. No other words left it looks cold to me. Kids will play. The road curves but the structure is ridged and stiff. Not very friendly - also should kids be invited to be so close to high Db (decibels) & EMF(?) from Bart
		x	Love the play sculpture idea, but not was about "ALBANY" in this font - Will look dated instantly + "Albany" is pretty unattractive
		x	Don't like it. To me it looks like Big Pipes. Sorry :(
			The word Albany is awful design! Barley readable.
			Needs chairs + tables for gathering. Why is no place to sit down? Older people not safe on tables.
x	x	x	This project needs to make sure the children who play these are absolutely safe. Is there a traffic threat to children
	x	x	I love the "Albany" sign!! But benches without backs are uncomfortable. I'd like just the "Albany" sign.
		x	Albany Loop: The Scale seems a bit off - it's bulky and too large for the space. Perhaps the tube diameter adds to this. Also, why is the yellow? Is that part of the branded Albany identity? What is the greater significance of the "loop"? It seems too self contained to the sign, as there is no identified loop in Albany, and the Greenway is not so much a loop either. It conveys an industrial feel, which does not capture the history or spirit of Albany.
x	x	x	Please add a play structure
x		x	I think it looks awesome! How did you do it? Where did you get the idea?
x		x	
x		x	
x		x	Awesome!
x			
x		x	What fun! Outdoor Art in Albany!
	x		The model was oriented so North points North - then we could visualize it better. Thanks!
x			It looks so cool!
x		x	I think it looks fabulous. A wonderful replacement of the old wooden "exercise" units-
	x		My kids love it! What if it was green and yellow? It will be fun! Thank you :) Blends in with trees? Looks fun!
	x		What about parking?
x			Yes!
x			It looks awesome, I think it's very creative.
x			It is so so so creative!
x	x	x	The "bench" areas were flat on top like we are when we sit :)
x		x	Sounds amazing! Something for kids would be wonderful!
	x	x	but what if it were a more natural color? Like green or blue?
	x		Would like sculptures on Masonic side facing senior Center.
		x	I can think of better ways to spend this much money
x			I love this idea I think it would really improve Albany.
			Ugly unrelaxing color. I use the path to the library very often, not esthetically pleasing. I think this is very ugly. It is too close to the pathway so if a child falls off they might hit their head on pavement!
x		x	Need more at Northside around Solano
			YUCK! Oil refinery modern - for a town addicted to cars
	x		Vegetable garden and fruit trees would be great too. Places lock bikes. Thing people and animals can eat are important everywhere.
	x	x	I think it looks too industrial - like plumbing pipes. It would be nice if it fit with the natural landscape and were more inviting.
			looks not very functional
	x	x	Will need constant painting to cover up graffiti
x		x	Love it!

			Model says it all - nobody is doing anything! It is an eyesore and yellow and will be taken out after the first accident.
x		x	How long will it take?
x			
x			
x		x	does it have a pull-up bar?
x			
x			My name is Stephen and I go to Thousand Oaks school
	x		Something for kids to play on. Please - Charlie S.
x			
		x	No! No! No! Looks awful
x			
		X	The Giant "Albany" letters don't loud good. Put the money into a par course instead
		x	This looks awful! Looks like a water park without the water. Put a fountain in
x		x	
			Like the "Albany" play structure. Overall project doesn't seem inspired artistically. How about murals on the BART pillars?
		x	UGLY. Limited function. UNAPPEALING.
x			I would LOVE to have that happen! It looks VERY fun! :) :)
		x	Hidden Creeks okay. Don't like the color of the play structure, too bright.
x			Will be fun to play with.
		x	This is a bad design. It doesn't blend it nature; it doesn't offer children a variety of activities; it uses a lot of metal for no real important purpose. It is an eyesore. It is NOT a work of ART!!!
x			Really like the creeks!
			(Border of Albany and Berkeley resident) Does not look great at all!! There is no artistic merit to this supposed sculpture. We can spend city money in a much better way than this project.
	x		What if you added some flowers? I could help if you like! I think it looks great and playful for a kid like me! :)
x			Excited about the prospect of the play space at the Albany loop proposal!
x			
		x	Would prefer a wood sculpture.
		x	Why do this, when there are so MANY infrastructure improvements we must/can make with tax payers money? This is ridiculous, in my opinion. Who cares about this???
		x	Loop structure does not look very engaging. What about something that is musical or scientifically interesting? See SF LIZ projects for ideas (Living Innovation Zone, e.g. Exploratorium and artists)
x			
			I do not like painted representations of the hidden creeks. The paint will fade often, be very distracting and confusing to elderly. I would rather see something more tangible and environmentally conscious/meaningful/natural.
			Don't build it unless you have money to maintain it. Otherwise it will look bad in five years.
x		x	Add more trees. I think it's cool but needs to be more climbable!
		x	I don't see much value in this. I'd rather the funds were spent on weeding and trash pickup.
	x	x	SWINGS.
			Hey there. I like the idea of adorning our bike path, but it just seems like it doesn't use very natural materials. It looks almost industrial, rather than reflecting Albany's small town vibe. Thanks.
			It's great that Albany is dedicated to creative spaces. I worry that this proposed structure will be covered in graffiti, requiring constant maintenance. Also, the width of the bars will make it hard for smaller children to grip and climb. Have you considered natural materials such as wood logs and stumps?
			I like the path and idea of a playground generally, but I think the YELLOW is too bright and stands out too much from the environment. I think a color that blends is better. Also, concerned about graffiti.

			The San Gabriel play structure feels too big for that space. The idea is good but the ALBANY sign looks too tall and like it would overshadow the nice openness of that corner. A small scale would look better to me. Likewise, I think less of the yellow tubing at ground level as well... maybe remove the section near the Bart support--it seems too distracting for drivers at one of our most busy intersections. -Jennifer O'Brien
			Who's responsible for upkeep? Can't take care of what's already there!
			Why the ugly yellow color? Is it caution tape? How about something natural, or at least inspired by something natural?
			The "creek art" is okay. The yellow factory fence graffiti magnet is awful.
			I strongly dislike the yellow tubular letters and structures. I think they wouldn't look nice for very long, are too bright, too loud, too unnatural and too uncomfortable. - Zoe Francesca
x			I like how people can sit on the pipes.
x		x	
x			We live right next to Codornices Creek on the Albany/Berkeley line. Love the Hidden Creeks Art Proposal!!
x			You can play and rest
x	x	x	More color, not just yellow. Perhaps yellow and blue or even rainbow. Softer material to prevent injury and for seating comfort. More shade!
	x		(Two drawings. Possibly of stars, or maybe sharks.)
	x		What about a pond and a playground?
	x	x	More shade, more grass, more benches.
x	x		Benches in the shade
	x		Slide and a lake with fish!
	x		More shade, playground, different color.
	x	x	What if there were also a way to keep PEDESTRIANS OFF the bike path? Signs to keep PEDS on the FOOTPATH? It's dangerous to bike when people walk on bike path!!
	x		It looks fine but it also looks crap and shit. By rain.
	x		Put the train
x		x	It looks great and should be built.
	x	x	(See comment cards)
	x	x	(See comment cards)
	x		Put train. By: Mike
			I think it would be really fun to climb on.
			I think it should be tunnels that kids can crawl through
	x		
			Not really fond of this design. I wish the color blended into the landscape more and the lettering is not great. The metal will be likely very hot if it's in the sun--recycled wood would be better. Not sure how any of the choices will be "resistant to graffiti."
			Not attractive. I can do without large yellow pipes. Also the B in ALBANY looks like an R.
x			Cool
			The yellow color is jarring and unnatural and will need to be repainted all the time from vandalism and weathering. Also, do you want the children climbing the Albany sign? Better put some soft material under for falls then... Good luck. Please change color.
			More trees, please. Bar across path too high for elementary age kids. Not enough play equipment.
	x		Lots more yellow structures in other colors too. And toy animals, birds, plants, trees, etc.
	x	x	Accessible for BLIND people? Access for people in wheelchairs? BARRIER between BIKE LANE AND WALK?
	x	x	Mobility impaired needs considered? What about lights for evening use?
x			Good job!
		x	Looks like an accident waiting to happen. How safe are the yellow bars?
x		x	I like BOTH the play sculpture and creek art ideas. Good for grandparent (me!) and 3 year old grandson.
		x	I like hidden creek not so much Albany loop.
	x	x	Tracks under BART not a good idea. They (blow? Glow?) up to the tracks and are not safe.
x		x	Especially love the creek art concepts. If budget allows, consider incorporating educational information about creeks (e.g. were they salmon runs in the past?)

x			Awesome, cool, I like the park and seating. It looks a little real. I love it.
x		x	I really like the art to depict the creeks. It's a good connection about the natural environment that should be stated.
x			I think you should add more trees.
x		x	Do it!
		x	I say skip the yellow Albany sign/art sculpture and use those funds to also improve the walk/bike paths.
x			
	x		I love cheese and cheese loves me & P.S. put a giant piece of bacon on it!
	x	x	Trees are fruit trees? Yes. Are the pipes bicycle racks?
x		x	It's not necessarily beautiful--hence the color, but it's a nice idea!
x			Especially the San Gabriel play structure!!
x		x	Especially the San Gabriel play structure
x			Anya
x		x	
x			I especially like the multi-age play sculpture area.
x			It awesome
		x	Looks junkie, use the money to fix the existing walk-ways.
x		x	I like the twisty turny pipes and I want the green color.
x			Looks cool but I recommend a play structure in the middle of the layout.
x			Cool, love layout, but sort of weird.
		x	Waste of \$. We know it will not be maintained.
	x	x	There needs to be more activity/callisthenic structures. It just looks like rails that will trip people. ART AND UTILITY TOGETHER!!
		x	The "Albany" is not attractive. Put in something that doesn't attract weeds.
		x	The play structure is not attractive and will attract more homeless people than children.
		x	Not to my liking at all! Looks uncomfortable and BOLD without "reason" or joy.
x		x	Public art and play spaces are essential in these divided times.
	x	x	Not loving the color. Green better
		x	Ugly
x			
x		x	More active use of the greenway is wonderful. Play structure, farmers market, etc.
		x	It's a little pointless. I like the greenway the way it is. But if you must, it should be green (looks natural--GREEN way.) Graffiti magnet
	x		
x		x	I'm enthusiastic about both art projects. Francis.kelly@gmail.com
x			Green is not a good color considering grass is the same color. :)
x	x	x	What if we added slides? :) Looks great!
x			Let's do more like it!
x		x	Cool art make it blue
	x		Except for neon yellow makes it look a bit garish. Anything that evokes the pre-built (native) environment?
x			Creeks project
	x	x	Maybe add a "mini-trampoline" (ground trampoline). Saw these in Copenhagen, Denmark. The sculptures are nice but they are not interactive.
x		x	They should totally built it because kids could get exercise but it might be noisy by the BART train.
x	x	x	Perhaps the ALBANY sign could be placed so that it's visible from BART as well.
x		x	The groundworks loop looks cool--do it.
x		x	I like the Albany climbing thing. It looks great! I think it should happen. Jeremiah, age 7
x			Creek art looks great! As little abstract as possible!
x		x	The color should be yellow :)
x		x	What if it were green? Nice plan.
x		x	I like the Creek Art.



x			I like the Creek Art Idea.
x			I like the yellow.
		x	Waste of money! Please consider time, energy + \$\$ on existing city infra-structure deficits--NOT this. From: A Albany Resident.
	x		The color of the San Gabriel Play Sculpture were white rather than the ultra bright colors.
	x		How about adding exercise stations and swings, more benches
x			
x		x	I like both of these! Would be better if BART passengers could see Albany sign. Still fun for people on the Greenway.
			SLIDE
x			Love it.
		x	Maybe you could add some fun play structure and make the seating more comfortable--"foam seating" Charlie, age 5
x			Perfect
x		x	The creek project is neat and educational! The Albany climber is a great way to replace some of the removed exercise stations.
x			
x		x	Yellow looks best!
			This would be better if it were a real playground.
	x	x	The San Gabriel Project needs trash cans and the Creek needs to be open. A Mary-go-round would be nice. Or a slide.
x			Sounds like a good idea.
	x		The noise level of BART must be above no safety levels.
	x	x	Color of the loop? Not crazy about this yellow.
x		x	Love the hidden creeks.
x			Good. (Pictures of a ladybug, a heart, a dog, and an abstract shape. The word "butt" written twice, in small letters.)
x		x	Love this idea! (The big yellow "Albany" one.)
	x	x	Included places for groups to meet like for Garden Swap or Playgroup etc.... or included "ART" like sculpture, kinetic wind...
		x	It would be more useful/fun for the kids to have a (real?) place structure
	x		I like the "Albany Loop" in yellow or blue--the green doesn't seem to "pop" enough! It would be cool to see the lettering use the "official" City font or as close as possible--maybe that was what was intended?
		x	Looks terrible. Horrible color. Bad design. No back rests. Not enough purpose. Lends itself to graffiti.
		x	UGLY. HELL NO
x			I really like the yellow color, it really goes with the landscape.
x			I want it to match the yellow one
		x	Aren't there more urgent priorities for scarce public funding?
			Seems useless, and at risk of being used by skateboarders doing tricks.
		x	Waste of \$. Invest in existing play structures/areas--that are NOT being currently maintained or updated.
			I think it's ugly, jarring color... A sense of enclosure might be inviting, this space is very near the streets and small.
			No. Hard to maintain the lawn, not fun for children. Looks like the 1970s, too mod. A hedge near the street would look better and make a better play space.
x		x	
			UGIII
	x	x	Install more lights.
x		x	I think you should go with yellow.
x		x	Great ideas--keep going. Thank you
		x	So sterile and dead. Like the inside of a factory. Where are plants? Where is creativity?
		x	It were more interactive--looks boring--not sure the purpose. How is this better than benches
x		x	Reasonable price
x		x	:) is great
	x		Look to expensive for the Creek Art--looks not good at all--creek color? San Gabriel Play Structure is too sample not useful
x		x	I love where it will be placed

x	x	x	
x			I love it
x			Would like to see more exercise facility (i.e., outdoor treadmill pedals) and benches in shade in place of the loop. Would like to see a more productive use of space and money...
		x	Creek art looks nice
		x	Sorry designers. Clever but not comfy and not a nice place to hang out.
		x	Problem is how the big graphic "Albany" makes the space look broken up; separates the path from the "seating" area. Does not look like it would be fun to sit on the pipes--and people can't talk to each other or share a lunch.
		x	ALP=not financially viable in terms of cost + maintenance. Squash project. My tax \$ to waste!!
		x	Prefer not to spend tax dollars on it.
	x		Look great but what some of the people fell down
x			
x	x	x	
x	x	x	People: srs., homeless, vets, handicapped etc. How will they be addressed? Native peoples impact addressed?
x			Very good!
x		x	Do better Photoshop on the sign. But 4/4 on the idea.
x			I like the walk and green way.
			Yellow pipes seem not fit the environment
x		x	Love the creek art.
		x	Does not look great. Is non functional and a waste of tax payer money. Make something useful and artistic that doesn't look like plumbing.
	x		More actual seating area like benches for seniors & people with disabilities to make the space more family friendly!
	x	x	Albany Loop is fine
		x	(See comment cards)
X		X	I vote for yellow if needed. Bt perhaps all 3 colors can be used for the loops. Add more playfulness
X		X	Love this idea.
X		X	Creek Art would be awesome! And hopefully for sculptures in the future!
			Frankly, I don't get it. How it will be used? Not yellow!!
			Trash receptacle--would be good. Too bright. Not yellow please.
x			I like it!
x			
x	x		
	x		What if there were more obstacles to play on?
x			I love both projects. Can you fund them both? If not, can you scale back the loop project to allow for both? Scale back the large Albany from the bike path
			Blue color please
			Spend your money on taking good care of the existing landscaping. Don't cover the trees with "art."
x			How are the tall yellow pieces used?
			I think it's aight but the Photoshop sucks
			Ridicules--waste of money
	x		I really like it but there should be a play structure in the middle for kids to play on!
x			Both are nice. Hope you will have trash cans near structure. 3-4 small tables would be nice also
x			I think it could have a playground for the neighborhood
	x		What if there were swings on one of the loops?
	x		Albany Loop blue or green. Concerned @ what it might look like in 10 yrs.... dated... dirty... Bronze creek--looks a bit junky. Let nature tell the story
x		x	Public art! All for it!
x	x	x	We choose BLUE! Thanks!
	x		Hidden Creeks=great! "Albany" under the BART tracks=could use more IMAGINATION

		x	San Gabriel play is not a child friendly climbing structure. It is very UGLY.
x			(Berkeley resident) Hidden Creeks looks good. Thanks
	x	x	Plant a tree and make swing on the tree. Please do that!
	x	x	Make a toilet and plant a tree and make a slide and make a swing.
			Every time I think you limp wristed Fenuks (fucks?) can't think of a way to waste tax payers money--you surprise me
	x		Plant a tree
	x	x	I want a slide that goes all the way up to the sky. (Four years old)
	x	x	It would be so fun if there was a swing hanging from one of the branches of the tree.
x			I love it
		x	Hideous
	x		So much attention is paid to Berkeley & wealthy side of El Cerrito. Please take a look toward the Richmond side. Weeds are growing, unsanitary area and trail... thank you
x	x	x	Please make sure there are secure garbage cans because of huge rodent problem
	x		Please add more trees
	x		I love cheese. Lots of cheese. The cheesier the better
x		x	Hidden Creeks great idea!
			It doesn't seem that interactive personally
x			Looks great! Just make the people clearer.
	x		There was a water fountain?
x			You could maybe make the "B" in Albany look a little clearer, but otherwise I love it
x		x	
		x	(See comment cards)
	x		
x			
x			
	x	x	How about a swing?
		x	Could do something more artistic
x		x	It looks so cool. (5 year old comment)
		x	Don't like it at all--throwing ball it's already great!
		x	Looks like shit
x	x		The B looks like an R
			Hidden Creeks. Nice idea.
			This structure for San Gabriel is a sight for sore eyes. You need ART consultant before you decide to spend so much \$ on this monstrosity!!
	x		Green or blue color options
	x		What if you could add a playground
x			I like the wavy lines for creeks
x			Good. A+
x			I love the yellow! I can see this being a good snapchat filter.
		x	More natural forest-like environments PLEASE!!!
			NO
x		x	Good idea!!
x			Very impressive by GWO
x			Nicely laid out. Unique idea for kids playground.
x		x	Cool!!!
	x	x	(See comment cards)
x			GWO did a great job!
	x		"Play structure" may be more interesting if some history of Albany can be engraved in it? Or signs about the history

			Blue is good for creek markings
x			I love it
		x	Yellow play structure gets in the way of open space. More trees yes.
x			Good
x			Looks good but you should add more trees
x			I think that the wavy lines and the other project bring a more artistic sense to the community.
x			I like it. It is a nice place to sit and relax.
	x		I was inside it?
	x		Call me: (510) 388-5685
x			I <3 it
	x	x	Of the color option swatches, I prefer blue
			I'd like a BART station at Solano or Marin
			How long before it turns into a homeless encampment!
x			Great job whoever made/helped it!
	x		You added a park
x		x	This is awesome and creative!
x		x	Hello
x			I think this looks amazing! Props to whoever made this!!!
	x		I think you should do it!
x			This cool
	x		No need for "Albany" self explanatory save \$
x			
	x		
x			
x		x	Yes and Lets submerge the BART line like it should have been when it was built
x		x	Hidden Creeks - Looks great, love that it will show native flora and fauna too. S.G Play Sculpture - The tubing doesn't look that safe for kids to play on, or adults to sit on
x		x	PUBLIC ART? YES! YES! Everywhere, stable, long-standing, eco-friendly, safe. Support Artists! Make Beauty!
x			
		X	Looks terrible. Looks Tacky
	x	x	include some bench seats/chairs w/ back support. Thanks
	x	x	The useable peak idea is great but symbolism has never worked in the past and does not represent the people who libel in Albany. Please save some space and resources
x			I like the blue option for the Loop
	x		I don't think that people will want to hang out under the BART tracks because it's so noisy - as with those chess and checkerboard tables no one ever uses. Seems like a major waste of money. ART is ok I guess - but not play area - won't be used there are so many nicer ones in Albany.
	x		The yellow is a bit much... Maybe a more subtle color
x	x	x	I like the Albany Loop but not yellow. Too much, a teal or green would be better
x			
x			
x		x	Hidden Creek. I think the symbols will be fun and if the paving settles will serve as "speed Bumps"
	x		I am thinking it is very difficult to maintain grass at the sculpture and it would go over budget
x		x	You should include a water fountain
		x	how about fixing the pedestrian walkway

	x		Hate to be negative but the big ALBANY is just wrong. View is blocked when approaching from masonic and backwards from Portland. I'm also not crazy about the "yellow spaghetti" but like the idea of durable interactive elements. Maybe the ALBANY can be turned into a more abstract artistic element that's fun to climb on
	x		Would enjoy having the open green space meow. Please do not build
	x		NO - unless the pipe is flat on top. Horrible to sit on those pipes put in benches with separation every two seat so no one sleeps there
x			
x		x	This is cool, you are welcome
x		x	In your display can you add a MAP to show where this will be? Thanks!
	x	x	What is no one comes, what will you do?
x		x	Love it, I would walk by it :)
x		x	
x			
x		x	
x			Creative!
x		x	Needs a water fountain for dogs and homeless
	x	x	Look cool. Skateboards will have a field day with the pipes. How do you plan to protect the finish from the damage?
x		x	So cool! Finish adding the final details
x		x	Don't let people change you mind, great idea!
	x		You should add a playground!
	x	x	I like the concept but the color and material are much too industrial. I'd prefer something that integrates w/ nature
x			I love the design
		x	The yellow things do not appear useful for play. The one crossing Ohlone for example: are kids expected to climb on it and swing over the trail?
x		x	I love the pipes!
		x	The noise level will destroy all of the kids ears. Not a good idea at all
			NOT PLAYFUL. HARD TO READ "ALBANY"
	x	x	Would be great to have more play elements that children can climb, swing on, and generally interact with more--there is nothing like this on the Greenway and it would be great for Albany kids!
		x	I hope it is totally wheelchair accessible--IF the brown surfaces are mulch, it would be to seated areas. Please be sure it meets code for access.
	x		You put in more detail and color?
	x	x	What if... you actually commissioned artworks, rather than these graphic mapping devices. These are not artwork.
	x	x	What if... we leave the creek how it is and make statues and things around it. I like to play in the creek.
		x	Will the big "ALBANY" structure be used as a jungle gym or something or just as a "sign"? IF just as a sign, won't that be a waste of \$?
		x	Get rid of the lawn
x			I think it would be fun to play on and it looks pretty.
x			It's cool. Your welcome
		x	Move Albany sign to face Solano Ave so most people and BART riders can see it.
x			Love it! Keep it up Albany
x			We want this to happen
	x		Is this safe for younger children?
			How about some real affordable housing?
x		x	This would be fun to play on
	x		The wavy lines depicting "hidden creeks" should be made of a blue material.
x			It will be fun!
	x	x	It wasn't yellow? Will it be painted with graffiti-resistant paint?
x		x	I like the blue color option for the tubing ALBANY sign.
x			I think it will be great because I could hang
x			Love it!!

		x	What if you didn't do big yellow pieces? Looks dated and takes away from trail.
x			North Berkeley resident
	x		Maybe add a park pleus
			Waste of \$
	x		I think that we shouldn't waste money on stuff like this. We could use the money on better things. (From an 8th grader)
		x	Please spend the money on fixed the road
		x	Not worth the \$, man-power and resources. Please scrap ALP.
	x		Look great but impossible to use! Due to noise level
x			
			(Second note from same person) Not fun, harder to maintain, tags every night...
	x		We made it blue? Thank you! LUKAS
	x		Looks as if it has a fire and trees are gone.
x			
x			Looks great add some more houses tho
x			
	x		Amazing lol :)
x			I think it looks perfect, fabulous
x			I think that it looks great, but I think it should have houses.
x	x	x	Make it so we can touch it.
x			When are you gonna build it or is it already done?
	x		You put a slide with water.

City of Albany

## **Call for Artists**

Ohlone Greenway Public Art



Release Date: June 23, 2016

Submission Due: September 22, 2016

**Projects**

Two (2) projects are available in this Call for Artists as part of the Ohlone Greenway Improvement Project. Artists may choose to submit proposals for one or both projects. If an artist submits proposals for both projects, one application for each project must be submitted along with all items required in the application to be considered.

**Eligibility**

The projects are open to all artists in Northern California with demonstrated ability to carry out a public art project of this nature and who are available to complete the project during the anticipated timeline.

**Location/Background**

The Ohlone Greenway is a bicycle and pedestrian path that runs directly beneath elevated BART tracks beginning at Ohlone Park in Berkeley and continuing through Albany, El Cerrito and Richmond. The path is not only a highly used commuting corridor it is a recreation destination and urban trail that weaves together a number of parks and green spaces. BART recently completed a seismic upgrade to the tracks. The work that was performed to upgrade the tracks caused heavy damage to the landscaping and hardscape along the Ohlone Greenway. BART worked with Cities to repair and improve the damaged areas. As a result of this work, Albany's section of the Greenway now has a bicycle and pedestrian path, new lighting system, street tree demonstration areas and improved landscaping.

At the time of the BART project and through the planning process for improvements, the Community requested additional elements to be included on the Ohlone Greenway. Items requested by the Community included a modern fitness trail, fruit and nut trees, bocce courts, improved seating areas, public posting spots, **public art**, landscape improvements and interpretive signage.

**Project Description**

The public art installations are part of the Ohlone Greenway Improvement project funded primarily with Measure WW which passed in 2008 allocating funding to cities based on population. Funding from the City's Art in Public Places fund will also be used for this project. In November 2015, the City selected a Landscape Architectural firm to develop concept plans for the Ohlone Greenway Improvement Project. Concept plan for the project were approved by the City February 1, 2016 and include two (2) public art projects.

**Project 1 - Play Sculpture at San Gabriel**

The art installation at San Gabriel and Portland Avenues will be an interactive play sculpture that will be appreciated by all ages, fusing the imagination of public art with the usability of a modern playground. The installation is intended to create a work of art that is related to, and in response to the local environment, including the possibility of interactivity for all Ohlone Greenway users to enjoy. The San Gabriel art play sculpture will invite children to play and interact with the art while providing an aesthetically pleasing environment to the Ohlone Greenway and encourage positive interaction for children and adults.



**Scale and Materials:** The scale of the installation shall provide for a measure of physical separation between the bicycle/walking paths and sidewalks that border the area and should be significant enough in stature to add visibility and attractiveness to the area without interfering with the elevated BART tracks. The sculpture could be figurative or abstract. Materials shall be selected for appropriateness to site and interactive use by park users, both adults and children. Reinforced concrete (poured in place or cast separately), recycled materials, stainless steel, organic materials (such as: wood, adobe, clay, soil or stone) and other appropriate, durable materials may be considered for use, however, glass, plastics, hazardous chemicals and petroleum products will not be permitted. Moving or rotating elements shall not be acceptable as part of the installation artwork. The installation must be resistant to vandalism and graffiti.

**Budget:** The maximum budget for this project is \$40,000.00. This budget must cover all costs associated with design, fabrication, transportation, engineering approval, installation, and documentation of the artwork. The artwork shall include within its overall budget, a durable plaque of cast bronze, incised stone, or other similar permanent material, to acknowledge the funding source, date of installation, name of artist, and relevant information, to be installed at the completion of the work and for the public opening event.

### **Project 2 - Creek Art**

There are three (3) creeks in Albany that run underground through the Ohlone Greenway. The northern border between Albany and El Cerrito is bordered by Cerrito Creek and the southern border between Albany and Berkeley is bordered by Codornices Creek. This project calls for a flatwork project in the paving of the bicycle/pedestrian path that would demarcate the two (2) bordering creeks hidden away beneath the asphalt. Another creek runs underground on the between Dartmouth and Marin Avenues. There is a unique opportunity to build demarcating artwork depicting Marin creek. This could be a combination of sculptural works and flatwork within the bicycle/pedestrian path and grass area. Please note that only flat work can be included on the bicycle/pedestrian path, but sculptural work could be planned for the grass area.

**Scale and Materials:** The scale of the installation shall provide a safe transition for people using the bicycle/pedestrian path and grass area and should be significant enough in stature to add visibility and attractiveness to the area. The flatwork and/or sculpture could be figurative or abstract. Materials shall be selected for appropriateness to site. Paint, tiles, organic materials (such as: wood, adobe, clay, soil or stone) and other appropriate, durable materials may be considered for use, however, glass, plastics, hazardous chemicals and petroleum products will not be permitted. Moving or rotating elements shall not be acceptable as part of the installation artwork. The installation must be resistant to vandalism and graffiti.

**Budget:** There is up to \$15,000.00 available for the depiction of the three (3) creeks. This budget must cover all costs associated with design, fabrication, transportation, engineering approval, installation, and documentation of the artwork. The artwork shall include within its overall

budget, a durable plaque of cast bronze, incised stone, or other similar permanent material, to acknowledge the funding source, date of installation, name of artist, and relevant information, to be installed at the completion of the work and for the public opening event.

### **Site Walk**

There are two dates noted in the Project Timeline for a pre-proposal site visit and walkthrough to be conducted by City staff. While this Site Walk is not mandatory, it is highly recommended that all prospective applicants attend at least one such date for clarification of any questions prior to completing a proposal for submission.

### **Public Presentation of the Completed installation**

Upon completion of the artwork installation the selected artist, or artist team shall prepare and provide a public presentation of the work, including a demonstration or description of the methodology and construction techniques used in the development of the work. This presentation shall be organized with the assistance of City staff to address a diverse audience, and will be scheduled on a day and time to be attended by as many park users and members of the public as possible.

### **Required Submission Materials**

Completed application (form attached; can also be downloaded from:

<http://www.albanyca.org/index.aspx?page=565>

**Deadline to apply - Proposals must be received no later than 4:00 PM, on September 22, 2016, at the following address:**

City of Albany  
Att: Isabelle Leduc  
Recreation and Community Services  
1249 Marin Avenue  
Albany, CA 94706

Proposals not received by the deadline will not be accepted. Late proposals and mailed parcels not received by the deadline will not be accepted. No faxed applications will be accepted.

### **Selection Process and Criteria**

A Selection Panel made up of artists, Arts Committee members, and community representatives will review all applications and select, from those that meet the specifications described in this Call for Artists, 3 finalists to prepare designs and models for final consideration. An honorarium will be paid to the finalists. The Selection Panel's decisions are subject to final approval by the Albany Arts Committee. Selection Panel participants are to be announced. The criteria to be used in selecting the finalists are as follows:

1. Artistic merit (excellence, originality) as evidenced by representation of relevant past work in slides and other supporting material.
2. Appropriateness of the artist's medium, style, and experience in relation to the project goals and settings.

3. Responsiveness of the application narrative to the specifications of this Call for Artists
4. Experience with projects of a similar scale and scope and/or adequate professional experience (studio and employment experience included) to fulfill the requirements of this project.
5. Experience should include familiarity with public agencies, the public review process, and/or collaboration with city agencies and community groups. Artists must have good communication skills and be able to work with diverse city representatives and community members.
6. Completeness of the proposal package, including design sketches drawings and images to convey the finished installation, public interactivity features, and adaptability to existing conditions.
7. Ability to assist residents in shaping the course of public art at the park.
8. Capacity to improve the overall appearance of the vicinity and to create a community asset and sense of place.
9. Demonstrated ability to recognize, honor, and link together significant historic, cultural, and natural resources representative of a site and surrounding community.
10. Availability to fabricate and install the project during the time period identified for this project.

### **Process for Finalists**

Finalists will receive an honorarium to meet the following requirements:

- submit a model of the proposed project by the deadline announced when finalists are selected  
NOTE: The model will be displayed publicly (at the City Hall or Community Center) for a public comment prior to the artist's presentation of the model to the Arts Committee.
- provide the following additional materials:
  - a materials list and samples of all materials to be used
  - a detailed budget for the project
- present the model to the Selection Panel in an in-person, public interview

Artist will be selected to develop proposals based upon the following criteria:

- a) Is the site location and public visibility of the artwork appropriate?
- b) Is the artwork appropriate for the project site, environment, and community?
- c) Is the artwork potentially offensive to the public?
- d) Does the artwork create a physical or visual safety hazard to the public?
- e) Is the scale of the artwork appropriate for the intended location and surroundings?
- f) What physical elements (i.e. rain, sun, irrigation, landscaping) might change the appearance of the artwork over time?
- g) Is the artwork protected from vandalism or graffiti?
- h) Does the applicant have a maintenance plan for the artwork to ensure longevity?
- i) Does the artwork include appropriate night or accent lighting?
- j) Does the artwork include an identification plaque, with the artwork title, artist name and date of installation?
- k) Does the project preserve and integrate with any natural features of the project site/environment? Natural features may include trees or other features of the natural terrain.

- l) Does the artwork have compatibility of design and location within a unified design character or historical character of the site?

The artist whose work is selected for the project will be required to sign a contract that will include, among other obligations, the following:

- give a brief public presentation as part of the opening ceremonies after the installation of the sculpture
- document the artwork once it is installed (in photos) and provide documentation to the committee
- provide a description of maintenance required for the artwork installed

### **Project Timeline**

Applications due: September 22, 2016, 4:00 pm

Site Walks: Wednesday, July 20 at 10:00 am and Monday, July 25 at 2:00 pm. Meet at Albany Community Center, 1249 Marin Avenue, Albany

Notification of finalists: no later than December 1, 2016

Finalists' proposals due: January 20, 2017

Models on Display at Community Center or City Hall: January 24, 2017 – March 24, 2017

Finalist interviews: March 2017

Notification of Artist Selected: by March 31, 2017

Installation complete: by September 30, 2017

Please note that this is an estimated timeline and is subject to change.

### **Acceptance of Proposals**

The Albany Arts Committee and City of Albany reserves the right to reject all design proposals submitted in response to this Call for Artists as well as the right not to award any contracts for this project. This Call for Artists does not constitute an agreement to fund artwork for the site described above. All information contained herein does not constitute either an expressed or implied contract. The provision of this Call for Artists are subject to change.

### **Retention of Proposal Materials and Models**

In the event that an artist is provided an honorarium to develop drawings and/or a model of a proposal, the following policy shall apply:

- a. The Albany Arts Committee, at its sole discretion, have the unconditional right to maintain ownership of any model, drawing or other materials used for its evaluation and selection process, as part of commission awards.
- b. The Albany Arts Committee may at its option choose to retain all such requested models, drawings and other materials until completion and final approval of the project installation, at which time such materials may be returned to the artist.

- c. Models and proposals submitted to the Albany Arts Committee shall be original, and unique in design and fabrication, and shall convey the proposal concept with reasonable accuracy, scale and detail.

**Contact Information**

For questions about this Call for Artists, please contact Isabelle Leduc, Albany Recreation & Community Services Department, [ileduc@albanyca.org](mailto:ileduc@albanyca.org) or (510) 559-7226.

This Call for Artists is also available online at: <http://www.albanyca.org/index.aspx?page=565>



## Application for Ohlone Greenway Public Art Project

Deadline: September 22, 2016, 4:00 PM

Name(s) \_\_\_\_\_

Address \_\_\_\_\_ City \_\_\_\_\_ State \_\_\_\_\_

Phone \_\_\_\_\_ Fax \_\_\_\_\_ Email \_\_\_\_\_

Website address(es) \_\_\_\_\_

- I am submitting this application for Project 1 - San Gabriel Play Sculpture
- I am submitting this application for Project 2 - Creek Art

**Application Checklist** – Please submit ten (10) complete, one-sided, collated sets of the written materials listed below. Each set should contain one of each of the materials, in the order in which they are listed below. Please do not bind materials and do not submit in plastic sleeves, folders or binders.

- Written description of the proposed artwork, including the artist’s intent, process, and project goals, and the names of all project partners including contractors and subcontractors;
- Artist’s resume and/or other supporting materials relevant to the artist’s experience with similar projects, such as the artist’s website(s) and portfolio and three (3) letters of reference or testimonials;
- Detailed description of proposed materials and methods of installation deemed suitable for the site conditions;
- Photographs of the existing site;
- Adequate visual representation, in color, of the proposed work, in drawing(s) and/or three dimensional model(s), with scale indicated;
- A scale drawing or digital photographic mockup depicting the proposed work in the context of its environs (with surrounding landscape, buildings, sidewalks, etc.);
- A preliminary estimate of all costs related to creating and installing the artwork;
- A project timeline including design process, all city reviews and installation;
- A suggested maintenance plan indicating schedule, instructions, life expectancy of work, etc.

Incomplete or incorrectly assembled applications may not be accepted. Neither the Albany Arts Committee nor the City of Albany staff may be held responsible for lost, missing, or damaged materials submitted. The Albany Arts Committee will endeavor to return the originals to the applicant. The City of Albany reserves the right to refuse all entries.

PLEASE INCLUDE A SELF-ADDRESSED ENVELOPE WITH ADEQUATE POSTAGE FOR RETURN OF APPLICATION MATERIALS.

---

Send Application Form and materials, **prior to September 22, 2016**, to:

City of Albany, Att: Isabelle Leduc

Recreation and Community Services, 1249 Marin Avenue, Albany, CA 94706