

THOUSAND OAKS BLVD.

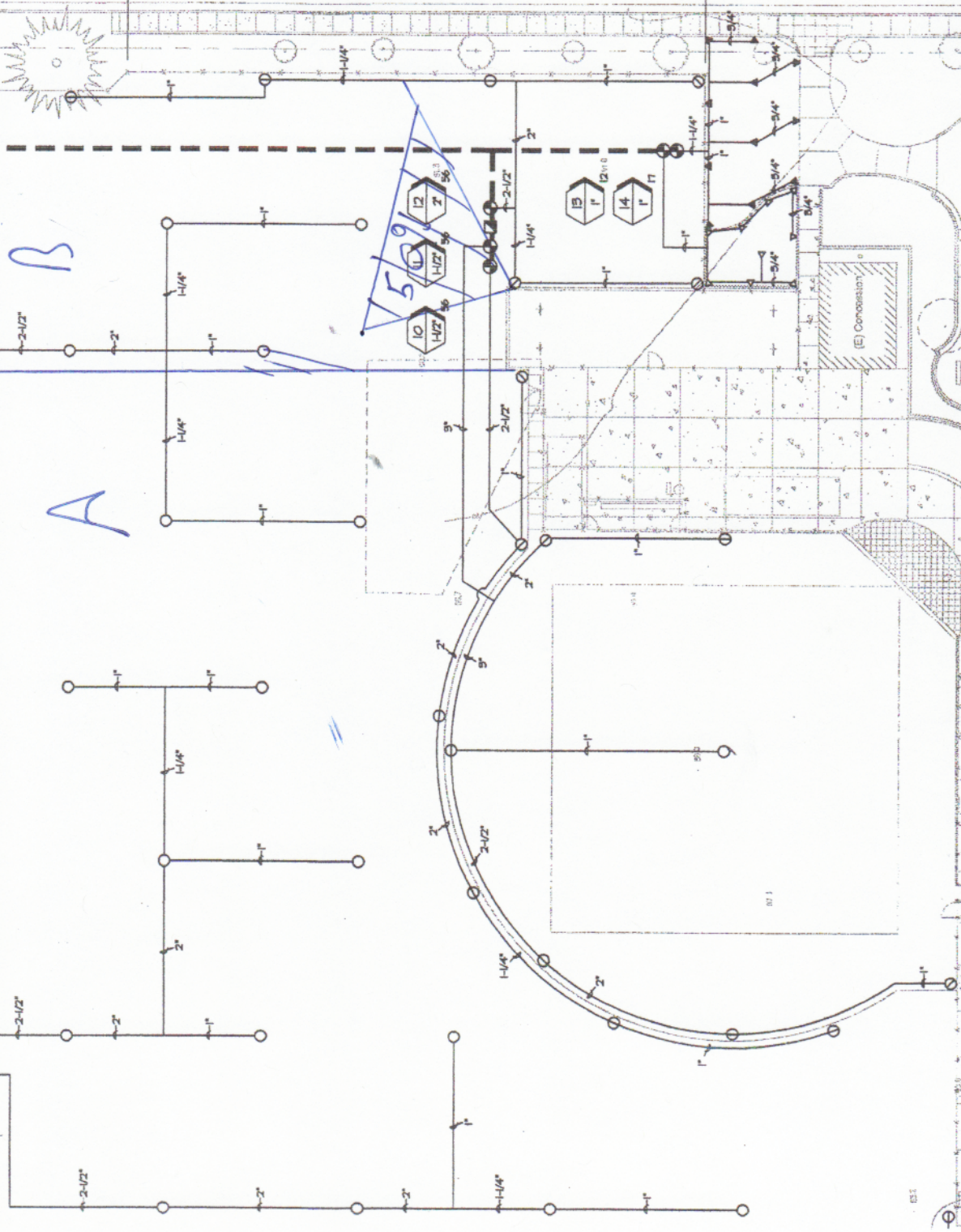

MOVE APPROX TEN (10) IRRIGATION HEADS AGAINST PREVIOUS
(B) FENCE LOCATION APPROX SIX FEET TOWARDS CARMEL
AVE. TO ACCOMMODATE (B) FENCE LOCATION.

CARMEL AVE.



(E) Concessionary